

# triton

VICTORIA VIC-300

## SPECIFICATIONS

### Kitchen Mixer

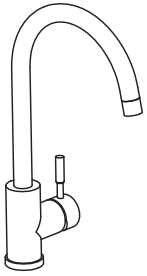

**NOTE:** THIS TAP IS DESIGNED TO BE INSTALLED THROUGH 1 HOLE, 1-3/8" (35mm) MIN.

#### DESCRIPTION:

- Stainless Steel construction
- Flexible supply lines with 3/8" or 1/2" compression fittings
- Includes Red/Blue indicators

#### FLOW

- Water usage is limited to these maximum flow rates as indicated by the corresponding product markings
- 9L-12L/min @ 3bar

#### CARTRIDGE

- Ceramic disk cartridge

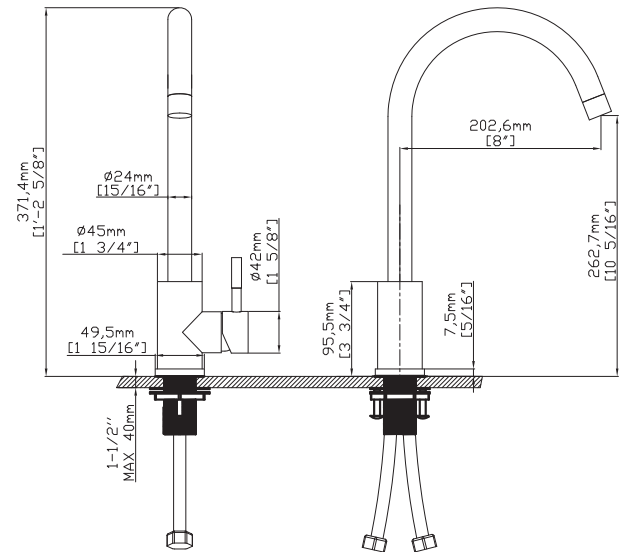

Note: Dimensions are for reference only.  
Detailed information is in accordance with the final product.

## KITCHEN MIXER INSTALLATION

### INSTALLATION MANUAL

#### TOOLS YOU WILL NEED:

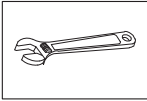

ADJUSTABLE  
WRENCH

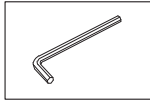

HEXAGON  
WRENCH

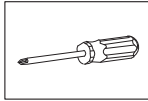

PHILLIPS  
SCREWDRIVER

#### NOTES BEFORE INSTALLATION:

1. Please check all components are present.
2. Before installation ensure that all feed lines are clear of debris and on/off valve is present.
3. Ensure water pressure is between 0.1-8 BAR (includes combination of hot and cold feed lines).
4. Pictures in the manual are general in content and may not represent your purchased faucet exactly. If you are having difficulties, please contact a professional plumber.
5. If you will be away from home for an extended period you should shut off your main water supply.

#### DAILY MAINTENANCE:

1. Use a soft cloth and vinegar to remove hard-water spots.
2. Check aerator (if present) regularly for calcium build up when water stream is not optimum.
3. DO NOT use caustic cleaning products as the use will break down finish and void the product warranty.
4. Acceptable cleaners include vinegar or mild non-abrasive liquid detergents.
5. If the water pressure appears to be less than optimum remove, inspect, clean or replace aerator.

**1**

Remove locking-nut, metal and rubber washer and hose connector if installed.

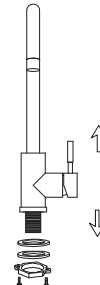

**2**

Tighten the flexible hose to the faucet, left is for hot water, right is for cold water.

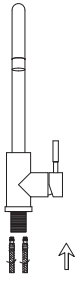

**3**

Install faucet through center hole.

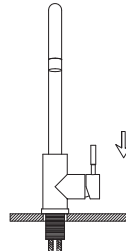

**4**

Assemble rubber washer, metal washer and lock nut onto the faucet, then use the screwdriver to tighten the lock nut.

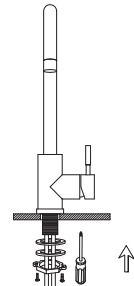

**5**

Attach flexible hose to water supply.

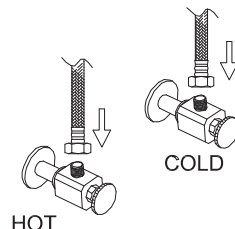

**6**

After installing faucet, remove the aerator, turn on faucet handle for 1 minute to flush debris. Close the handle and re-assemble the aerator.

