



*The*  
**SPHERE**  
QUICK START GUIDE



# Getting to know your Synexis® Sphere

## Inside Front Cover

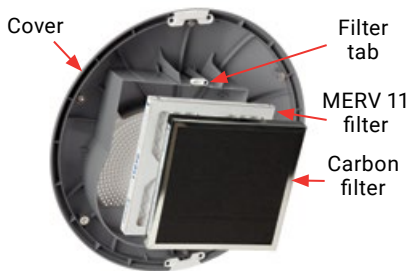

## Inside Front

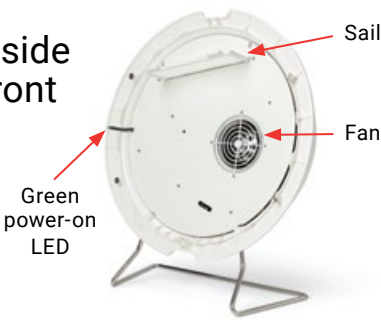

## Back

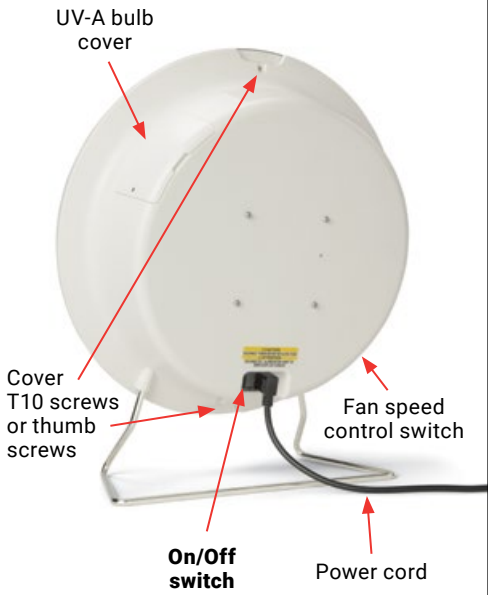

## Included tools & hardware



UV-A bulb (packed inside cardboard tube)



Bracket for wall mounting (for installation instructions, see the owner's guide)



Find out more information on our website at [synexis.ca](http://synexis.ca)





# Welcome. Thank you for your purchase.

Be sure to inspect all parts for damage prior to use. **DO NOT OPERATE THIS DEVICE IF ANY DAMAGE IS NOTED.** If the device is damaged, contact your Synexis Account Representative at (844) 352-7680.

**WARNING: UV-A bulbs contain a small amount of mercury similar to any fluorescent bulb. Check with your local waste management authority for disposal or recycling requirements. Additional disposal and recycling information can be found at: [lamprecycle.org](http://lamprecycle.org).**

**READ FULL INSTRUCTIONS AND SAFETY/WARNING INFORMATION PRIOR TO USING THIS DEVICE.** Do not mount Sphere device to the ceiling. See the owner's manual for full installation instructions.

The Synexis Sphere comes with the tabletop stand pre-installed. **However, there are some consumable items you will need to install prior to first use.**



## Sphere Box Contains:

- Sphere device
- Metal stand (pre-installed)
- Wall mount bracket (optional wall mounting)
- Power cord
- **1 UV-A bulb for immediate installation**
- 1 Torx T10 T-Handle screwdriver for wall bracket locking screw
- 1 Security Torx T10 L-shaped tool for bulb cover or Sphere cover screws
- Quick Start Guide



## Starter Kit Box Contains:

- **2 Sails, one for immediate installation** and one for use after device has run for 14 days
- **1 Carbon filter for immediate installation**
- **2 MERV 11 filters, one for immediate installation** and one for use after device has run for 14 days

## Recommended Replacement Schedule



**A** Sail & MERV 11 filter (after first 14 days, then every 3 months)



**B** Carbon filter (every 6 months)



**C** UV-A bulb (every 2 years)

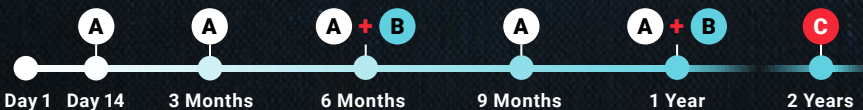

1

## FIND CONSUMABLES

Remove Sail, carbon filter, and MERV 11 filter from **Starter Kit box** and UV-A bulb from **Sphere box**.

**(Extra Sail and MERV 11 filter are replacements to be installed after device has run for 14 days).**

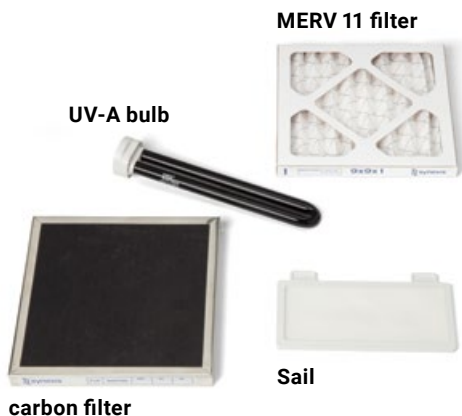

2

## SAIL INSTALLATION

Place Sphere device on a stable, flat surface, then remove the screws at the top and bottom.

**You will have one of three types of screws:**

1. *Safety screws:* Remove with the Torx T10 L-shaped tool. Replace with provided thumb screws.
2. *Thumb screws:* Remove small top thumb screw, then remove longer bottom thumb screw.
3. *Thumb screws with retention clips:* Loosen top and bottom thumb screws to remove cover. Thumb screws will not come out completely.

Pull top and bottom of cover to disengage magnets and remove the front cover.

4

## FILTER INSTALLATION

Put MERV 11 filter into the square cavity in the front cover with **directional arrow pointing away from cover**, then place the carbon filter on top. Turn tabs 90 degrees to hold filters in place. Replace front cover and tighten screws.

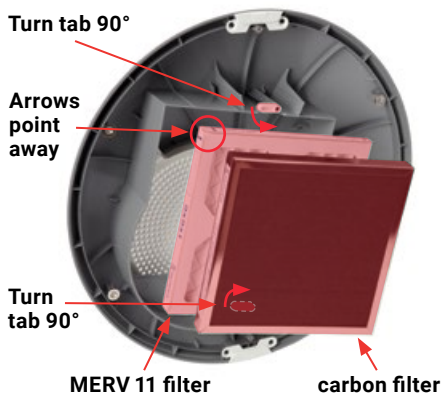

5

## UV BULB INSTALLATION

Using Security Torx T10 L-shaped tool, remove the UV bulb cover.

Remove cover



3

Insert the Sail (from the Starter Kit box) into the horizontal slot at the top.

Insert  
Sail



Remove  
or loosen  
screws



Pull



For more in-depth instructions,  
see the owner's manual at  
[synexis.ca](http://synexis.ca) or call 844-352-7680.



6

Align the 4 pins in bulb base to the holes in the socket (wide to wide, narrow to narrow) and insert, slightly tilting the bulb base down. **Push base firmly into socket.** Replace cover and tighten screw.

Tilt bulb base down  
while inserting

Match pins with holes

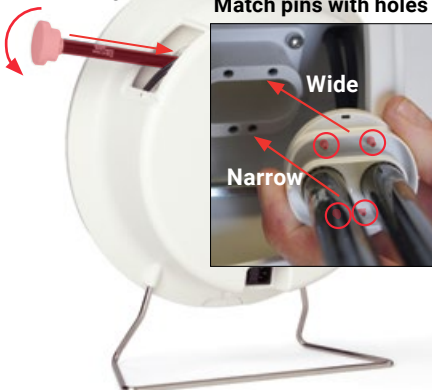

Wide

Narrow

7

Firmly insert the power cord into back of Sphere. Plug cord into power outlet. Turn on, adjust fan speed to desired level (it takes a few seconds to hear the fan). **A blue glow should be visible through the top grille.** Enjoy your improved indoor air quality!

Fan speed switch

On/Off switch

Insert  
power cord

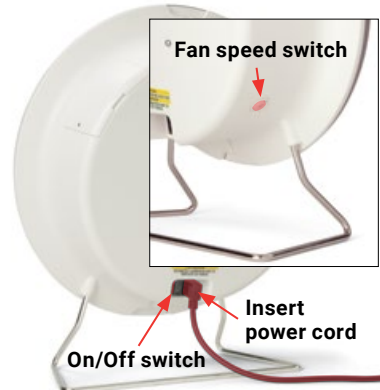



CALL 844-352-7680  
FOR MORE SAILS, FILTERS,  
OR BULBS



11711 W 79th Street  
Lenexa, KS 66214  
United States of America

(844) 352-7680  
[info@synexis.com](mailto:info@synexis.com)  
[synexis.ca](http://synexis.ca)