

### Application

These panels can be used to build perimeter and partition walls, or as a light-weight façade cladding. Sandwich panels are used in applications where a combination of high structural rigidity and low weight is required. The sandwich panels are a good solution for constructing and finishing a variety of projects.

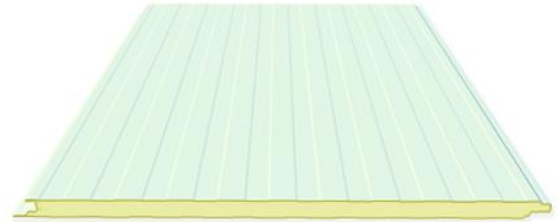

### Surface lining options

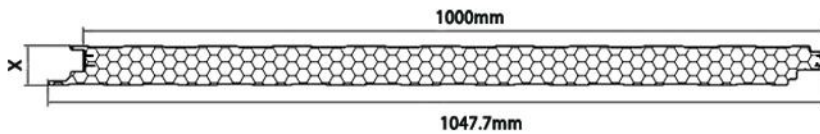
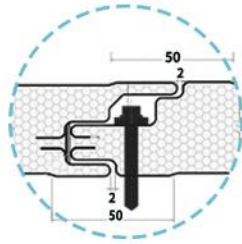
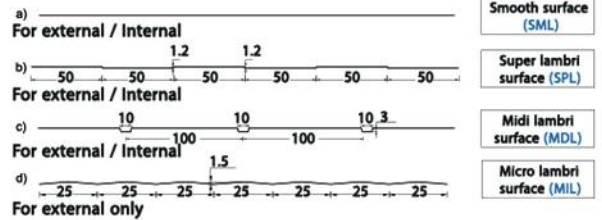

PIR/PUR- low Index λ=0.023	Panel thickness (mm) - X	40	50	60	80	100
	U - Value W / (m2.k)	0.831	0.684	0.581	0.365	0.283
	R - Value m2.k/W	1.204	1.461	1.720	2.741	3.531
	Weight Kg / m <sup>2</sup>	10.29	10.69	11.09	11.89	12.69

• Protective film : With or without guard film (upon request)

### Product Tolerances :

Length ≤ 3	± 5 mm
Length > 3	± 10 mm
width	± 2 mm
Thickness ≤ 100 mm	± 2 mm
Thickness > 100 mm	± % 2 mm

### Available lengths :

Shorter lengths	2.00 m
Longer lengths	16.00 m

### Steel sheet specifications :

Description	Galvanized pre-painted steel sheets
Zinc coating	120 -180 - 275 grams per sqm
Alu. zinc coating	100 - 150 grams per sqm
Coat Type/ Finish	Polyester 25 microns Granite HDX 55 microns - 70 microns PVDF 25 microns - 35 microns Plastisol 100 microns - 200 microns HPS 200 microns

### Materials :

**Insulation Core (PIR - Polyisocyanurate core) : Foam density 40kg/m3**  
According to EN 14509.

PIR components present an excellent insulation performance, they are highly effective, lightweight and CFC free. They offer an excellent thermal conductivity, high resistance to weight, giving the final structure a remarkable stability in case of thermal aggression like a fire.

### Steel Sheets : According to EN 10346

The panels facing material is always under control as it is galvanized, skin passed, pre-painted and top coated, the top coat colors will be according to customer Preferred directions and usual international panel satisfactions.

The standard panel facing is a steel plate coated with Ral 9002 polyester paint suitable for food process purposes.

External and internal skin thickness: 0.35 - 0.40 - 0.50 - 0.70 mm.

### Colors :

### Examples of special colors:

Standard colors:	White RAL 9016	
White RAL 9002	Green RAL 6021	
Blue RAL 5012	Red RAL 3020	
Beige RAL 1014	Silver RAL 9006	
	Gray RAL 7042	

### Aluminum Sheets :

It is available to use also aluminum sheets instead of steel for the panel production, All aluminum rolls used in the Alex panel's production are produced completely according to EN & ASTM & ISO norms.

- Yield Strength - 150 Mpa
- Tensile Strength - 175 Mpa
- Elongation - 3 % (min)
- Surface Stucco Embossed or painted
- Temper - H16 \_ H26 ..... EN 485-2
- Alloy - AW 3000 series ..... EN 485-2
- Thickness tolerance is ( +/-0.03 mm) .... EN 10145

### Stainless Steel Sheets :

Come in two Thicknesses 0.45 or 0.55 mm. Alloy is 304 or 305.

\* Shorter length than 2m shall be agreed with sales.

### Guarantees :

Alexpanel will provide product guarantees on an individual project basis. Guarantees are typically up to 5 years in a non marine / geothermal environment. All guarantees are subject to maintenance regime. Specialist coatings are available for marine and other more corrosive areas.

### Application

These panels can be used to build perimeter and partition walls, or as a light-weight façade cladding. Sandwich panels are used in applications where a combination of high structural rigidity and low weight is required. The sandwich panels are a good solution for constructing and finishing a variety of projects.

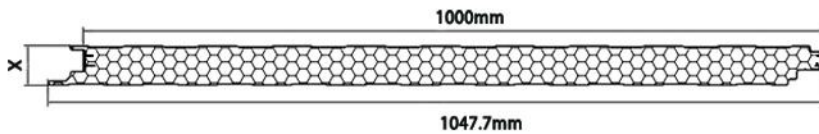
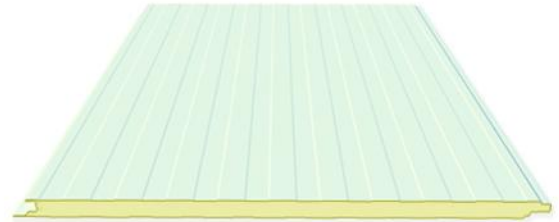
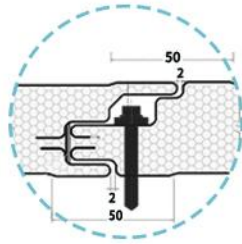

### Surface lining options

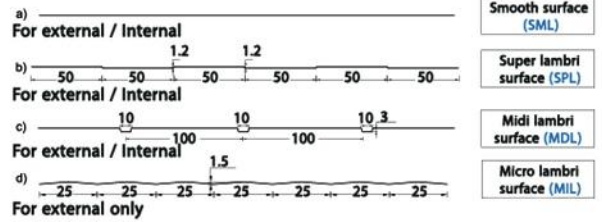

PIR- HI Index $\lambda=0.024$	Panel thickness (mm) - X	40	50	60	80	100
	U - Value W / (m2.k)	0.859	0.708	0.602	0.381	0.296
	R - Value m2.k/W	1.164	1.412	1.662	2.628	3.378
	Weight Kg / m <sup>2</sup>	10.29	10.69	11.09	11.89	12.69

### Product Tolerances :

Length ≤ 3	± 5 mm
Length > 3	± 10 mm
width	± 2 mm
Thickness ≤ 100 mm	± 2 mm
Thickness > 100 mm	± % 2 mm

### Available lengths :

Shorter lengths	2.43 m
Longer lengths	16.00 m

• Protective film : With or without guard film (upon request)

• Accessories should be as per approval. (Documented commitment by client)

### Steel sheet specifications :

Description	Galvanized pre-painted steel sheets
Zinc coating	120 -180 - 275 grams per sqm
Alu. zinc coating	100 - 150 grams per sqm
Coat Type/ Finish	Polyester 25 microns Granite HDX 55 microns - 70 microns PVDF 25 microns - 35 microns Plastisol 100 microns - 200 microns HPS 200 microns

### Materials :

**Insulation Core (PIR - Polyisocyanurate core) : Foam density 40kg/m3**

According to EN 14509.

PIR components present an excellent insulation performance, they are highly effective, lightweight and CFC free. They offer an excellent thermal conductivity, high resistance to weight, giving the final structure a remarkable stability in case of thermal aggression like a fire.

### Steel Sheets : According to EN 10346

The panels facing material is always under control as it is galvanized, skin passed, pre-painted and top coated, the top coat colors will be according to customer Preferred directions and usual international panel satisfactions.

The standard panel facing is a steel plate coated with Ral 9002 polyester paint suitable for food process purposes.

External and internal skin thickness:

Minimum interior and exterior facer thickness 0.57 mm.

### Colors :

Examples of special colors:

Available on request

Standard colors:	White RAL 9016	
White RAL 9002	Green RAL 6021	
Blue RAL 5012	Red RAL 3020	
Beige RAL 1014	Silver RAL 9006	
	Gray RAL 7042	

### Stainless Steel Sheets :

Come in two Thicknesses 0.45 or 0.55 mm. Alloy is 304 or 305.

### Fire safe and Insurance :



Alex-panel sandwich panels have received FM Approval as Class 1 insulated panels with **no height restriction** in accordance with FM Approvals standards 4880, 4881

### Guarantees :

Alexpanel will provide product guarantees on an individual project basis. Guarantees are typically up to 5 years in a non marine / geothermal environment. All guarantees are subject to maintenance regime. Specialist coatings are available for marine and other more corrosive areas.