



Self-fit

Installation Manual

CONTENTS

WHAT'S IN MY PACK?.....	3
YOUR SELF-FIT DEVICE.....	3
SAFETY – MUST READ.....	4
HOW TO INSTALL YOUR DEVICE.....	5
WHAT DO THE LIGHTS MEAN?.....	7
DEVICE ACTIVATION.....	8

WHAT'S IN MY PACK?

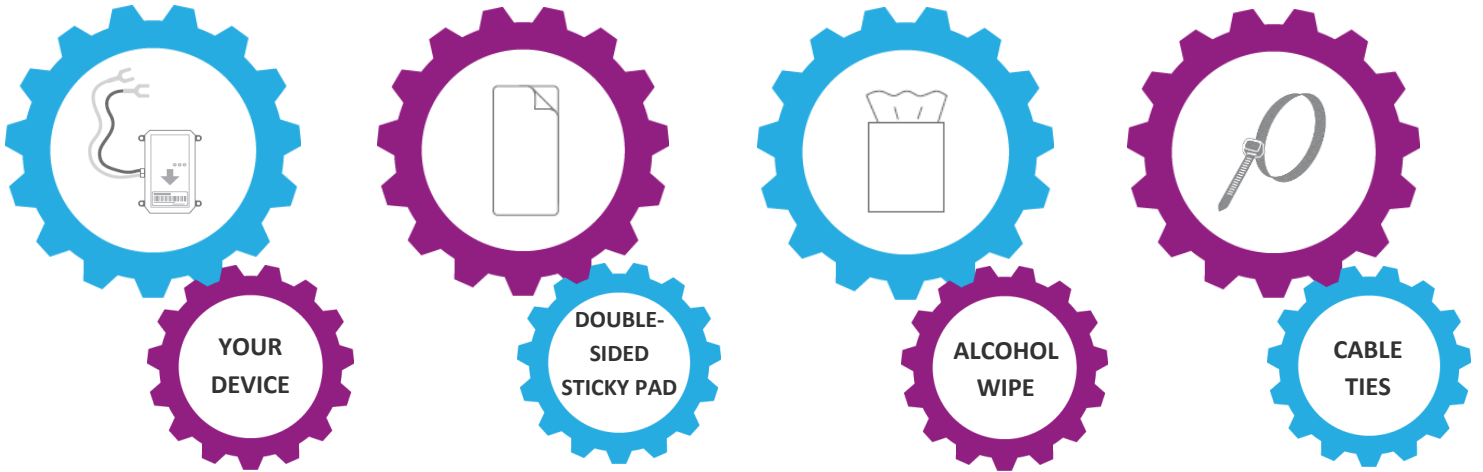

YOUR SELF-FIT DEVICE

WHAT IS IT?

Your self-fit telematics unit. Telematics is the technical term for any system which uses an electronic or mechanical device to communicate with other devices or systems via a network. Most of us have already used in-car telematics, at least to some extent, in the form of GPS (Global Positioning System) Sat Navs and Mapping Applications.

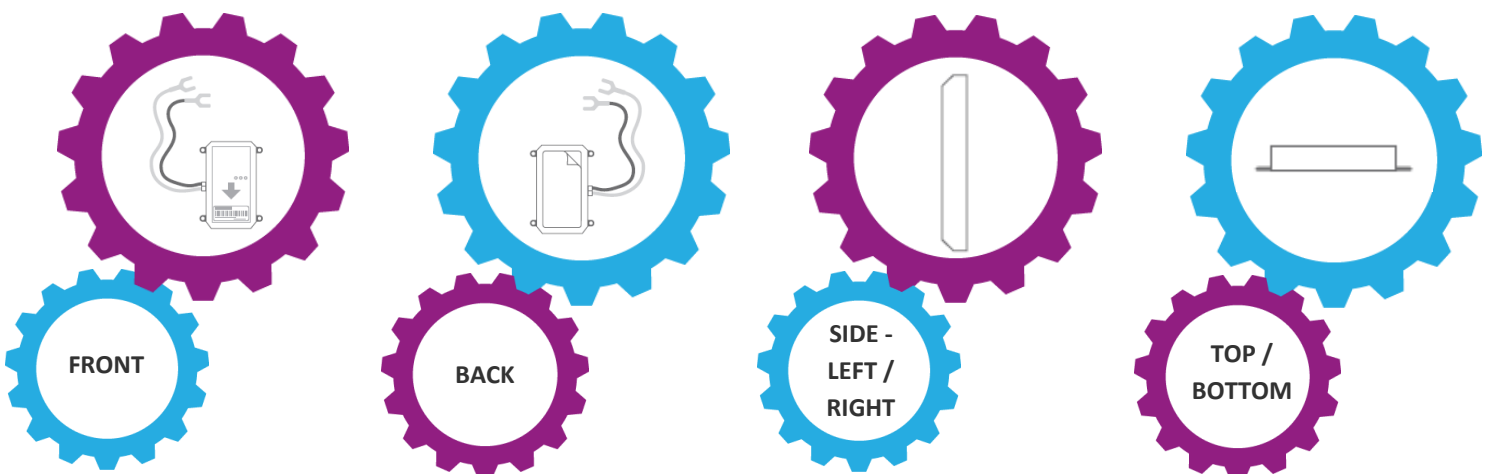

SAFETY – MUST READ

BEFORE INSTALLATION

- ✓ Inspect the device; if there is any visible damage to the device or the wires leading from the device, contact your insurance broker for further assistance and do not complete the installation. Do not attempt to open the casing of the device.
- ✓ If you are installing the device outside, do so in weather conditions that are permitting. Do not attempt to install the device in rain, snow or high winds.
- ✓ There should be sufficient lighting.
- ✓ Ensure appropriate clothes are worn; do not wear loose items of clothing, or anything that will cause an obstruction.
- ✓ The vehicle must be parked in a driveway, or stationary on a road that is a safe distance away from other vehicular movements and immobile objects. The ignition must be switched off and the handbrake applied, so that the vehicle will not be able to move. If the vehicle has been used recently, allow sufficient time for the engine to cool off.
- ✓ If the device is being fitted within the engine bay, make sure that the bonnet top is properly secured using the vehicle's prop or stand.
- ✓ Make sure to read the ingredients and third party safety information on your provided alcohol wipe.

DURING INSTALLATION

- ✓ Connect the device's red wire to the **positive terminal (+)** of the battery first.
- ✓ Do not leave any tools within the engine bay, or on top of the battery.
- ✓ Do not leave the vehicle unattended.
- ✓ Do not touch both battery terminals at the same time with either your hands or tools. ⚠
- ✓ Do not hold and / or touch the **positive (+) wiring** to the **negative terminal (-)** of the battery at the same time. ⚠
- ✓ Do not hold and / or touch the **negative (-) wiring** to the **positive terminal (+)** of the battery at the same time. ⚠
- ✓ Do not completely remove the terminal clamps from the battery.
- ✓ Be careful of other engine components.

AFTER INSTALLATION

- ✓ Ensure all tools, packaging and rubbish are removed from the engine bay.
- ✓ Ensure any bolts, nuts, washers or other fixings you may altered are secure and tight.

**WE ACCEPT NO LIABILITY FOR DAMAGE TO YOU, YOUR VEHICLE OR THE DEVICE
PRE-FITMENT, DURING FITMENT AND POST-FITMENT**

HOW TO INSTALL YOUR DEVICE

BEFORE YOU START

Locate your vehicle's main power supply battery. It will most likely be found under your bonnet, located next to the engine. However, depending on the make and model of your car, it may be situated within the boot or inside the vehicle itself. If you are unsure, consult your vehicle handbook or search online.

You can also watch our video demonstration.

STEP 1



Once you have located your vehicle's battery, make sure there is enough space to place the device on top of it, in a flat and forward-facing position.

The white arrow on the device must be facing the front of the vehicle (this may not necessarily align with the front of the battery) in a straight line. It must be placed on a flat and horizontal surface. Make sure that the two wires leading from the device reach the **positive terminal (+)** and **negative terminal (-)**.

If the device cannot be placed on top of the battery in a flat and forward-facing position, then it can be placed in an alternative location, so long as the two wires leading from the device remain properly connected to the battery terminals. The chosen surface must be flat and horizontal.

STEP 2



Using the provided alcohol wipe, be sure to wipe the top of the battery (or alternative location) where the device will be placed, making sure it is clean and then allow for the surface to dry.

It is important that the surface is clear of dirt, grease, dust and condensation – as this may prevent the device from sticking, once secured in place.

HOW TO INSTALL YOUR DEVICE

STEP 3



Peel a side off of the provided sticky pads and attach it to the back of the device.

Make sure that the top of the battery (or alternative location) surface is clear of condensation, dirt, grease and dust – as this may prevent the device from sticking once secured in place.

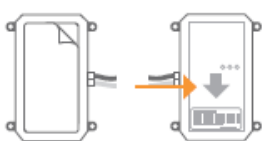

The white arrow on the device must be facing the front of the vehicle (this may not necessarily align with the front of the battery) in a straight line. It must be placed on a flat, horizontal surface.

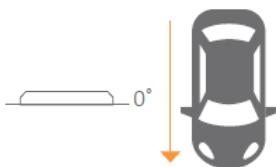

Remove the remaining peels from the sticky pads and place the device on top of the battery (or alternative location) in the area that has been cleaned, making sure it is dry before applying.

STEP 4

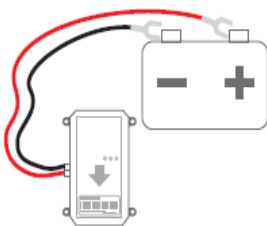

Loosen the bolts that secure the clamps to the battery's **positive terminal (+)** and **negative terminal (-)** (use an adjustable wrench or spanner).

Your vehicle's battery may use twist terminals or be spring-loaded. Consult your vehicle handbook or search online if you are unsure.

Do not completely remove the terminal clamps from the battery.

Firstly, connect the **red** wire to the **positive terminal (+)** on the battery and then connect the **black** cable to the **negative terminal (-)**. Once completed, retighten the bolts on each terminal respectively.

Use the provided cable ties to secure any wiring leading from the device.

STEP 5



Without pulling and / or tugging the device, make sure that the device is properly secured to the battery (or alternative location).

You must not remove your device at any point during the policy period, unless otherwise approved in advance by your insurance broker.

WHAT DO THE LIGHTS MEAN?

The device will activate immediately once connected to the battery and all three LED lights should appear.

RED – POWER (PWR)

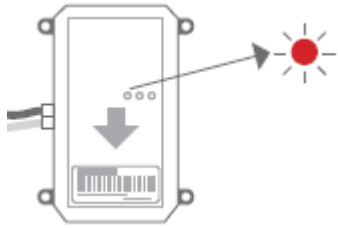

WHY IS THE POWER LIGHT ON THE DEVICE FLASHING QUICKLY?

This signifies that the device is receiving an external power source and the devices internal battery is charging.

WHY IS THE POWER LIGHT ON THE DEVICE FLASHING SLOWLY?

This indicates that the device is not receiving an external power source and the devices internal battery is below 20%.

WHY IS THE POWER LIGHT SOLID?

This means that the device is receiving an external power source and the devices internal battery is fully charged.

BLUE – GPS SIGNAL (GPS)

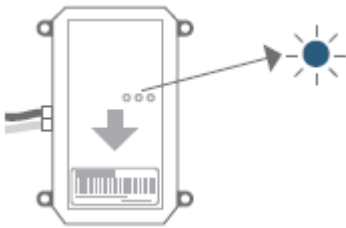

WHY IS THE GPS LIGHT ON THE DEVICE FLASHING QUICKLY?

This signifies that the device is searching for a GPS signal.

WHY IS THE GPS LIGHT ON THE DEVICE FLASHING SLOWLY?

This indicates that the device is currently unable to send any GPS data via the required signal.

WHY IS THE GPS LIGHT SOLID?

This means that the device has connected to the required GPS signal.

GREEN – NETWORK SIGNAL BEING RECEIVED (GSM)

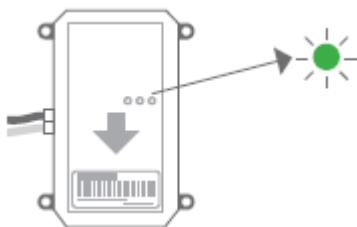

WHY IS THE GSM LIGHT ON THE DEVICE FLASHING QUICKLY?

This signifies that the device is searching for a GSM network.

WHY IS THE GSM LIGHT ON THE DEVICE FLASHING SLOWLY?

This indicates that the device has registered to a GSM network.

If you are in a poor signal area or underground, the installation will not be complete until a good signal is established.

After a period of time the power and GPS lights will disappear, leaving the GSM light flashing slowly.

DEVICE ACTIVATION



Within 24 hours of completing the installation, you will receive a text confirming that the device is active. This message will be sent to the mobile number you provided at the point of sale for your insurance policy.

If your number has since changed, contact your insurance broker.

QUESTION? UNSURE OF SOMETHING?

Watch your video demonstration.

Refer to your self-fit web support page.