

**NOTE 1:** Product moves from Product storage to Sales area via secure dumbwaiter

**NOTE 2:** Product moves from Loading/Unloading to Product Storage Area before or after business hours.

**NOTE 3:** Product will be delivered from Central Distribution before business hours 3 days per week. The area will be a Restricted employee Access Area before and after-hours. It will be a Order Pick-Up, Public Access Area during business hours.

**Key:**  
 Typical Door

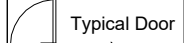
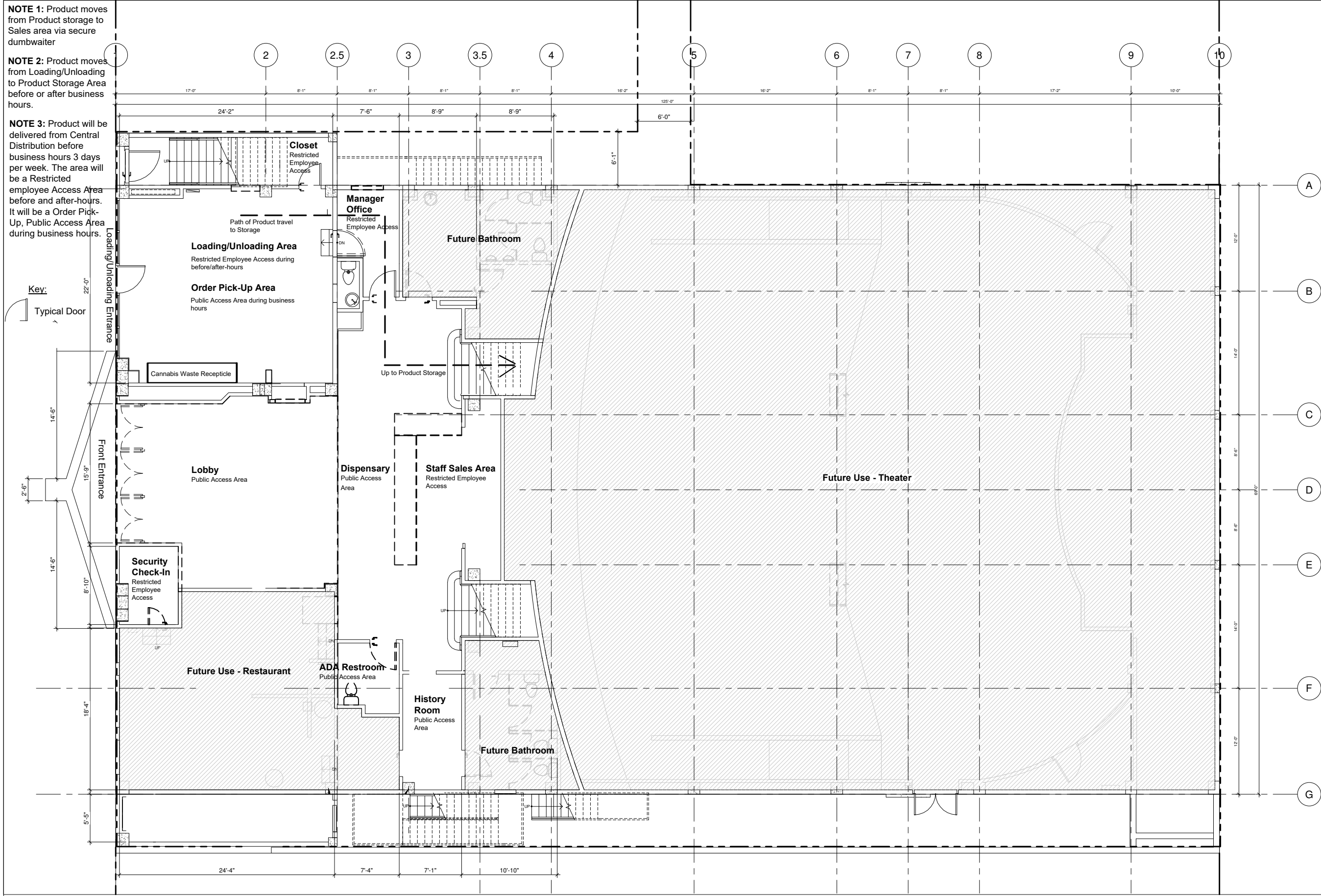

**(E) LEVEL 1 - DISPENSARY**

**1** 3/16" = 1'-0"

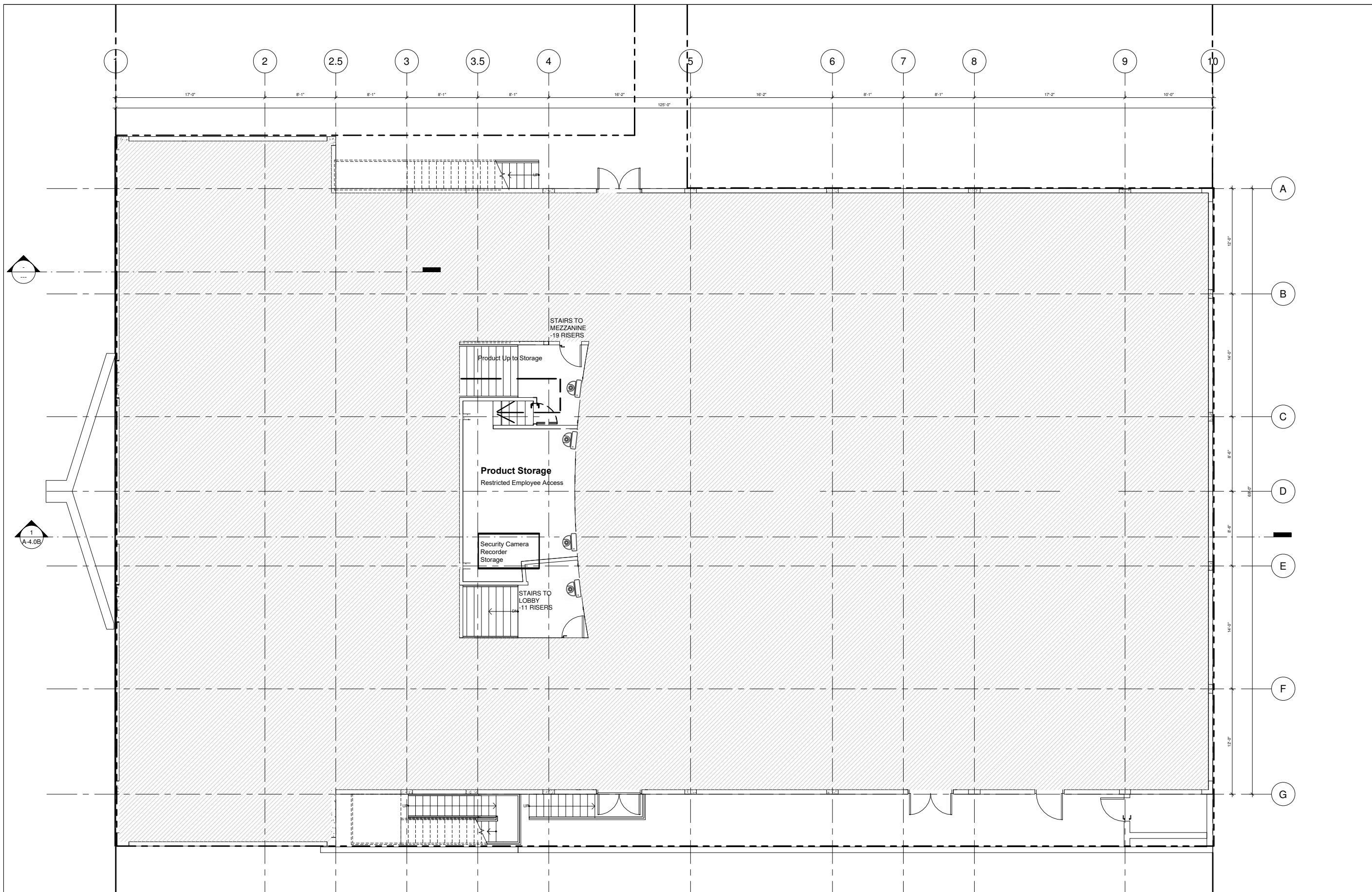

(E) LEVEL 1.5 PRODUCT STORAGE

1 3/16" = 1'-0"

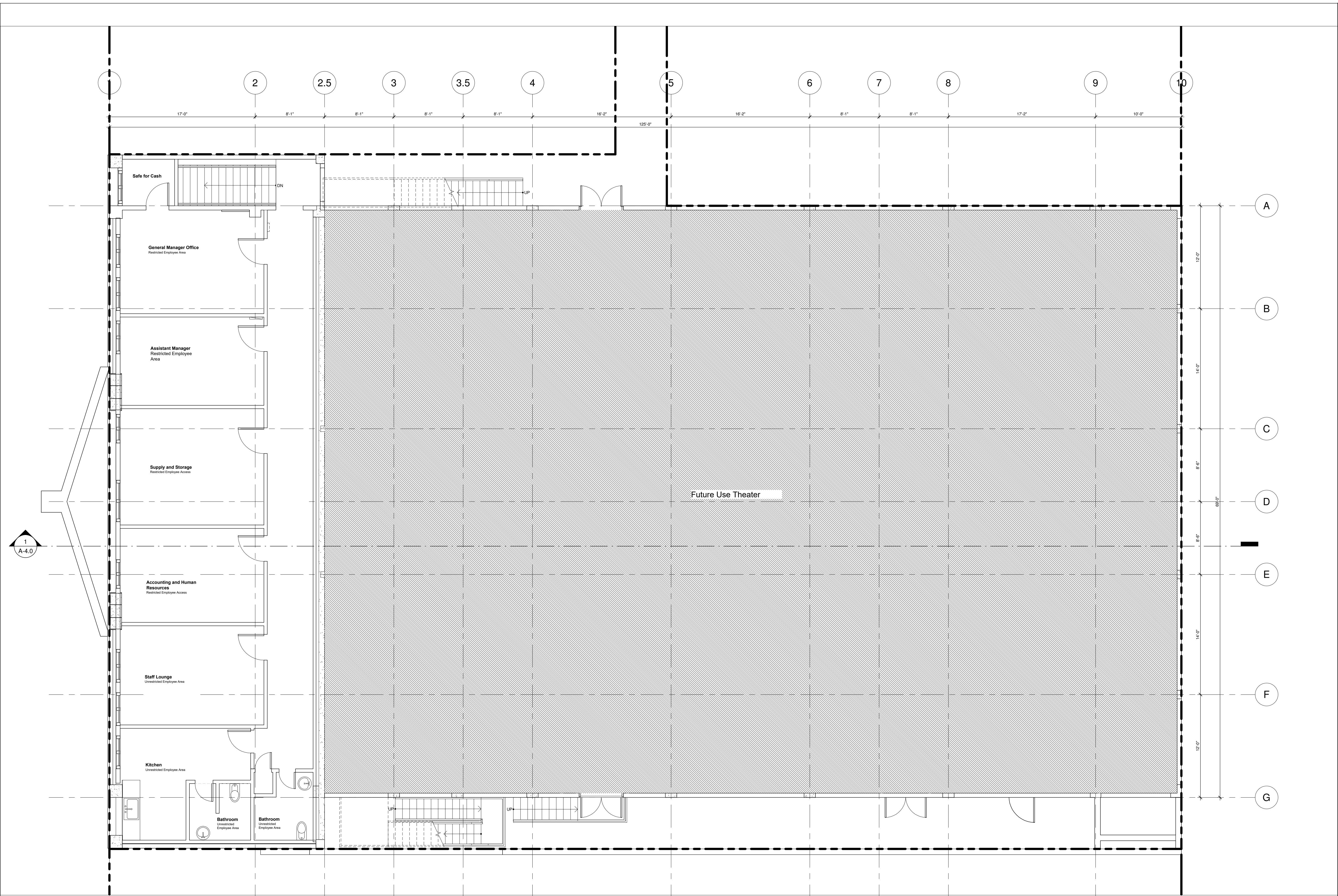

1 (E) LEVEL 2 OFFICE  
 3/16" = 1'-0"

