

CL-TALON[®] 300

Rainscreen & ci Applications

This cleverly engineered “Smart-Track” support system offers design flexibility and truly integrates the structural elements, supporting all exterior cladding materials with one single product selection for rainscreen and continuous insulation (ci) applications.

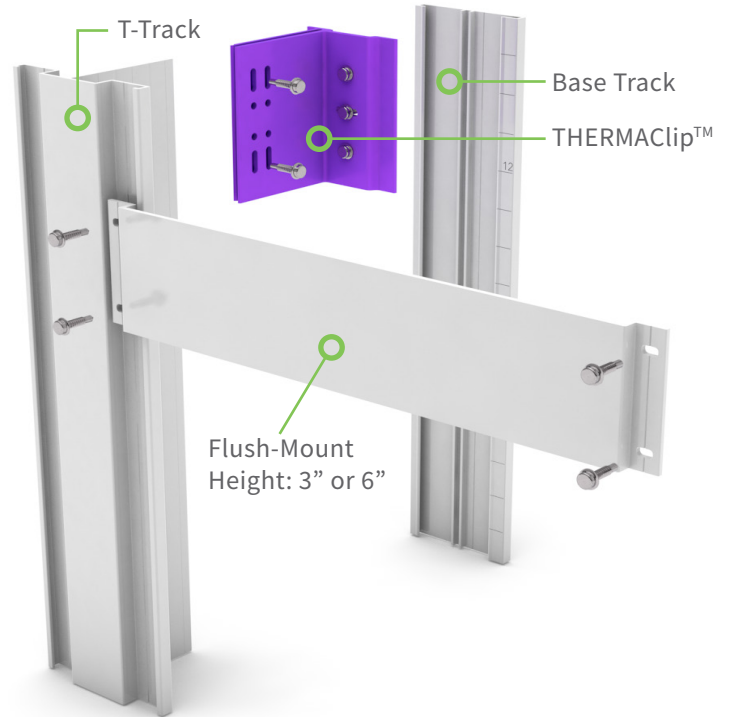

Key Benefits

- Flush-Mount Design - Horizontal and Vertical Attachment on the Same Plane
- Third-party Tested to over 90% Thermal Efficiency
- One Product - All Cladding Materials
- Accommodates up to 8” of Insulation
- Level the Base Track Once - Each Polyamide THERMAClip™ Slides Quickly into Place
- Level the Base Track Once - Each Polyamide THERMAClip™ Slides Quickly into Place
- Pre-marked Measurements
- Plumb / Level on the Outside T-Track vs at the Substrate
- No Shimming - No Damage to the Membrane
- Finishing Accessories with Corner Supports

Track Colors



Black Anodized
Aluminum



Silver
Aluminum

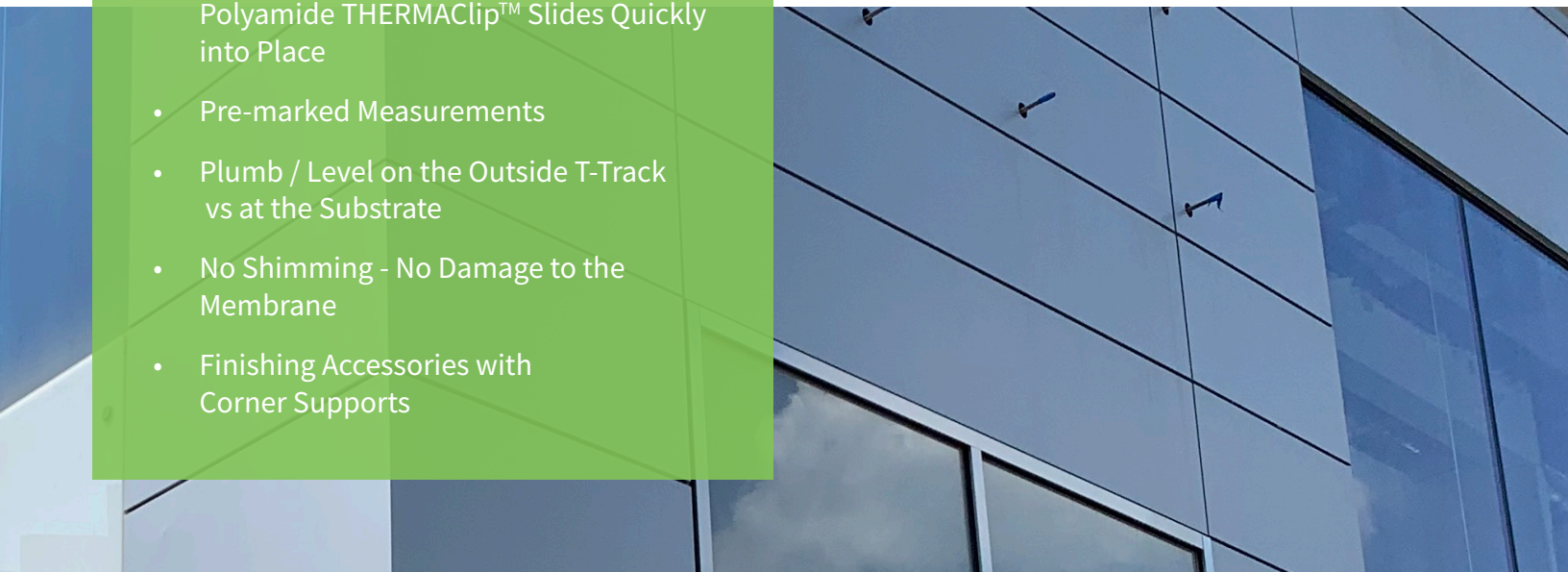

Independent flush-mounting brackets interlock to slide up and down within the outer framework providing: 1) multiple fixing points - negating the need to connect the panel edges back into the depth of the system, 2) an overall reduction in the depth of the wall assembly, and 3) the flexibility to place supports only where they are needed making this system ideal for even the most complex designs.

Integrated Flush-Mount Design for All Cladding Types



Flush-Mount Design

Independent flush-mounting brackets interlock to slide up and down within the outer framework providing: 1) multiple fixing points - negating the need to connect the panel edges back into the depth of the system, 2) an overall reduction in the depth of the wall assembly, and 3) the flexibility to place supports only where they are needed making this system ideal for even the most complex designs.



Exterior Leveling

Also unique to this innovative solution, is the ability to level and plumb the T-Track on the outer elevation versus using shims at the substrate. This method is quicker and eliminates the need to use shims and therefore the likelihood of damaging the membrane from this process is also eliminated.

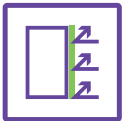

High Thermal Performance

The CL-TALON 300 cladding support system is an environmentally responsible product that provides high-performance thermal isolation required for effective continuous insulation design. Third-party tested over 90% thermal efficiency by utilizing a polyamide THERMAClip™ as the thermal break. Accommodates up to 8" of insulation.



All Cladding Types - All Applications

One product integrates with all cladding materials - Terracotta, Stone, Brick, Ceramic, Fiber Cement, ACM, Composite, Zinc, + Horizontal and vertical applications.



LEED Credits

Energy & Atmosphere - Exceeds ANSI/ASHRAE/IESNA Standard 90.1-2010 by eliminating any conductive fastener penetration of the insulation.

Materials & Resources - Aluminum elements have 30.5% post-consumer recycled content and may be valued at 85% of the cost of those elements in calculating the credit.



Pre-Marked Measurements

Each aluminum track is pre-marked with measurement lines to help installers eliminate the need to measure and score the surface on the components as they go - saving them valuable time in the process.



Slide in Clips

Installers can simply align the Base Track once in the orientation of choice, then insert and slide each THERMAClip™ into position at the appropriate visible markings on the track. Fast and easy - no more plumbing and leveling each small component individually.



Finishing Accessories

Window, Door, Edge Termination

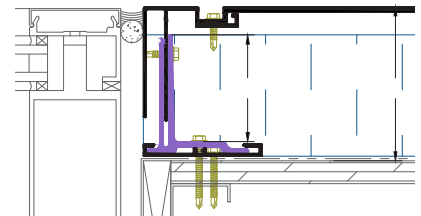

Corner Supports

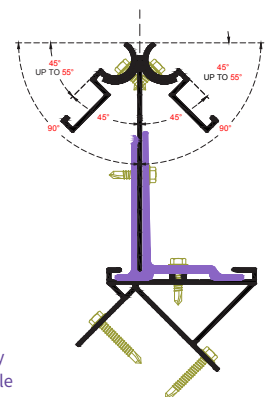

3233 Dell Avenue, North Bergen, NJ
Tel: 833-258-2566
sales@cltalon.com | cltalon.com

CL-TALON is a manufacturer of structural and non-structural support systems for exterior cladding and interior wall and ceiling applications. These smart, quality engineered systems provide architects with maximum design flexibility and contractors with a safe, quick and accurate installation method for multiple applications. Our mission is to accelerate the advancement of smart building design & construction by providing unique and cleverly engineered systems. We remain dedicated and driven by our commitment to continuous improvement.