

# Installation as built-under appliance

(with continuous baseboard)

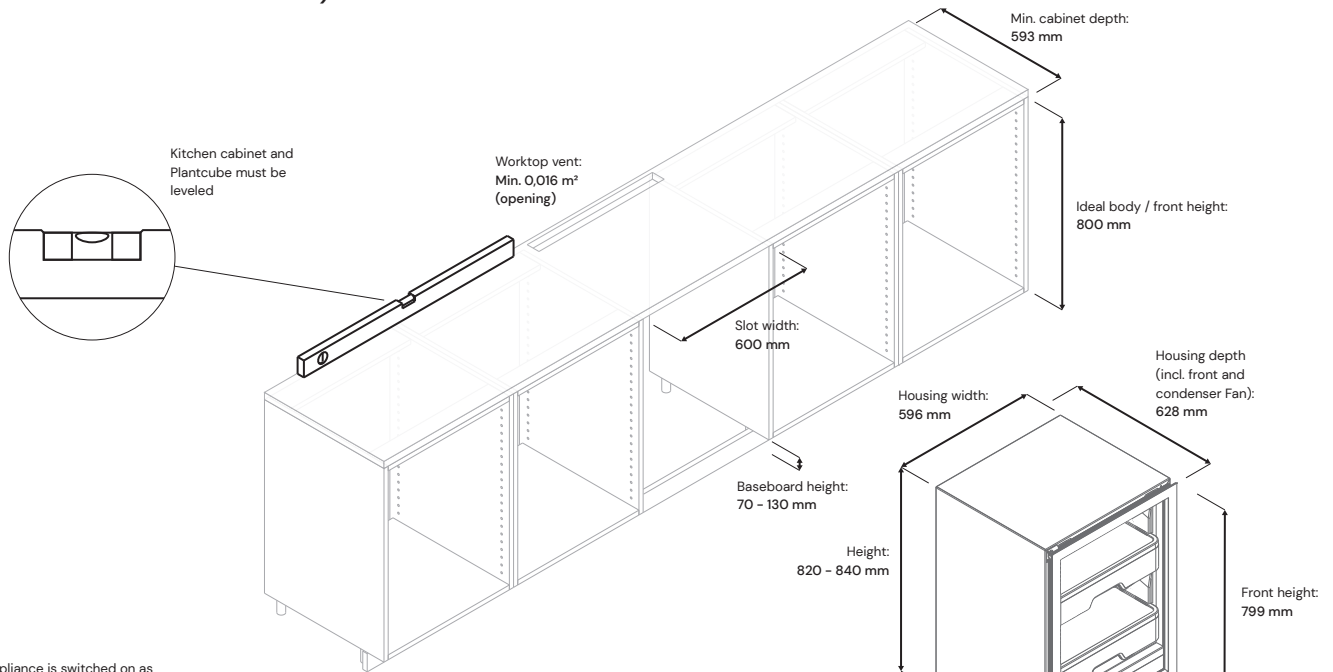

**Note:**  
The appliance is switched on as soon as it is connected to power outlet. There is no additional on / off button.

The socket must be easily accessible even after the appliance has been set up.

Cable length: 1800 mm

**Note:**  
The Plantcube has an active fan and a condenser on the backside of the appliance. This ensures proper functioning of the cooling.

Max. baseboard allowance: 150 mm  
If required, the front feet can be screwed in further back.

**Warning: Danger of tipping**  
This foot configuration may only be used in the built-under installation. To ensure the Plantcube cannot tip, it must be installed touching the bottom side of the work surface.



Mounting beams:  
(Need to be provided by kitchen installer)

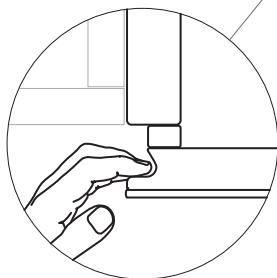
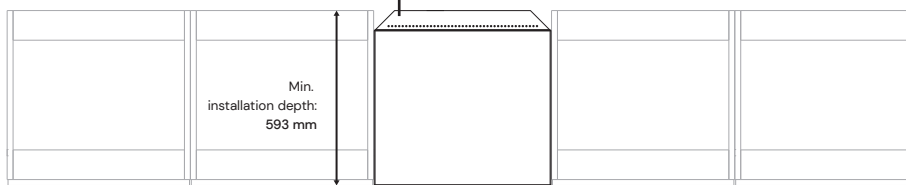

**Note:**  
The kitchen front should be flush with the Plantcube body front. The Plantcube door protrudes the kitchen front. (See detail)

**To be noted for flush mounting:**  
For flush installation a cutout of at least 12mm width on the right hand side is necessary to ensure the functionality of the plantcube door. (See detail)  
On the left side there must be sufficient space to grab the door. Additionally, the minimum installation depth changes to 630mm.

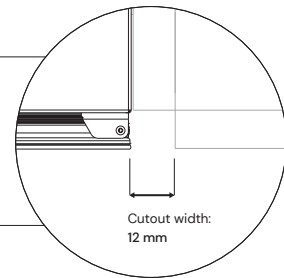

# Installation as a slot-in appliance

Cabinets and Plantcube need a min. distance of 55 mm to the back wall for the warm air to escape.

Kitchen cabinet and Plantcube must be leveled

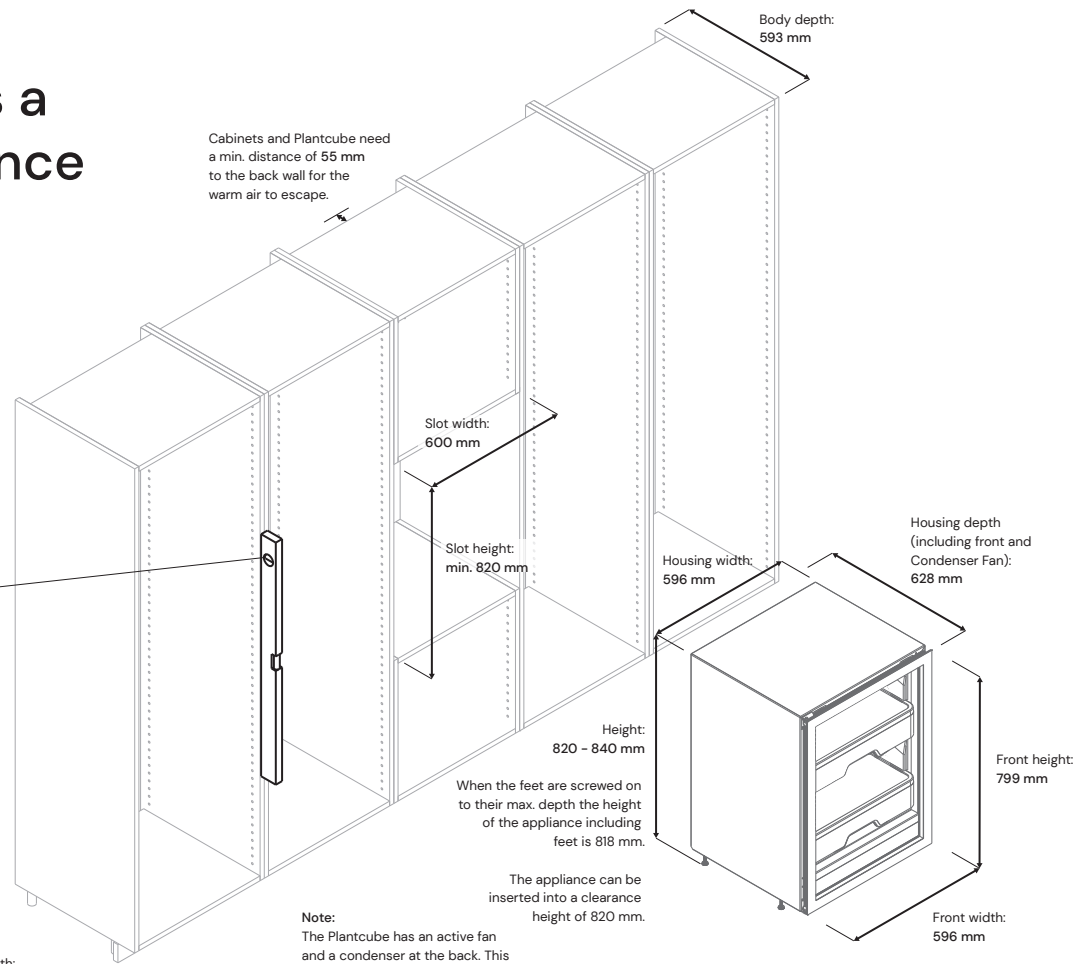
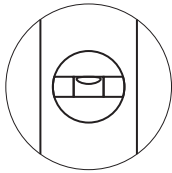

**Note:**  
The appliance is switched on as soon as it is connected to power outlet. There is no additional on / off button.



The socket must be easily accessible even after the appliance has been set up.

Cable length: 1800 mm

**Note:**  
The Plantcube has an active fan and a condenser at the back. This ensures proper functioning of the cooling.

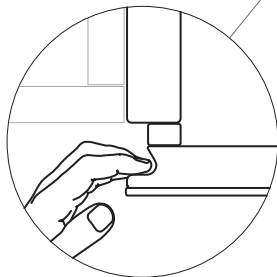
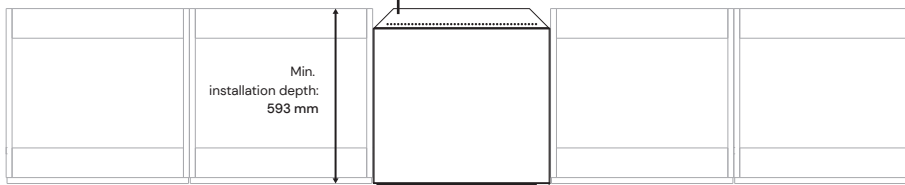

**Note:**  
The kitchen front should be flush with the Plantcube body front. The Plantcube door protrudes the kitchen front. (See detail)

**To be noted for flush mounting:**  
For flush installation a cutout of at least 12mm width on the right hand side is necessary to ensure the functionality of the plantcube door. (See detail)  
On the left side there must be sufficient space to grab the door. Additionally, the minimum installation depth changes to 630mm.

