



# Smart Leak Detector

## User Manual



Scan Me



Installation Video  
and Online Manual

For more information and  
troubleshooting tips, check  
out [www.rusco.com/smart](http://www.rusco.com/smart)

**SPECIFICATIONS**

Material: ..... PC  
LED Indicator: .....Red  
Battery: ..... (2)AAA  
Battery Life: ..... 6,000 alarm triggers  
Standby Current: ..... 1uA  
Alarm Current: ..... 160-180mA  
WiFi Frequency: ..... 2.4 GHz  
Wifi Standard: .....802.11b/g/n  
Working Temperature: ..... 32 - 104F  
Working Humidity: .....20% - 85% RH  
Storage Temp: .....32 - 140F  
Storage Humidity: ..... 0-90%RH  
Size ..... 80x30x27mm (Main Body) 2.0m(Sensor cable)





## GETTING STARTED



1. Remove the screws to access the power button and the battery compartment.
2. Place 2 "AAA" batteries into the battery compartment.
3. Press and hold the black power button until you see a red light blinking
4. Now you can pair the detector with the app.

## APP INSTALLATION & SETUP



1. Download the 'SmartLife' App
2. Launch the SmartLife App
3. Create a login or continue as guest\*

*\*a free account is needed in order to access advanced features like creating a house setup and triggering different actions*



Compatible with  
Alexa/ Google Home



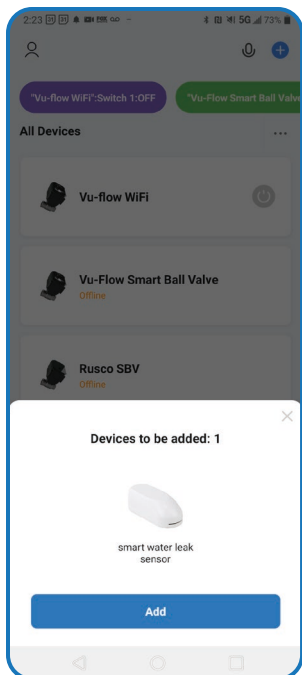

1. Smart Life should automatically sense your leak detector, if you see a screen like this tap the blue 'Add' button

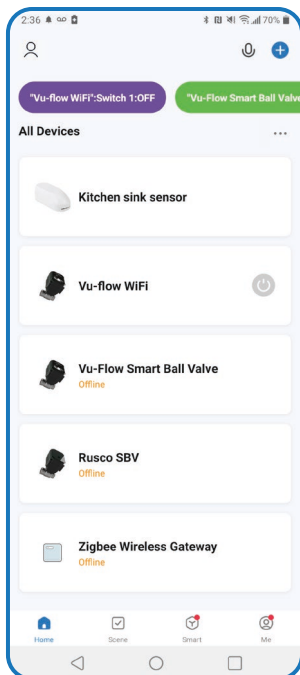

2. If it doesn't automatically sense the sensor, press the blue '+' icon → Add Device

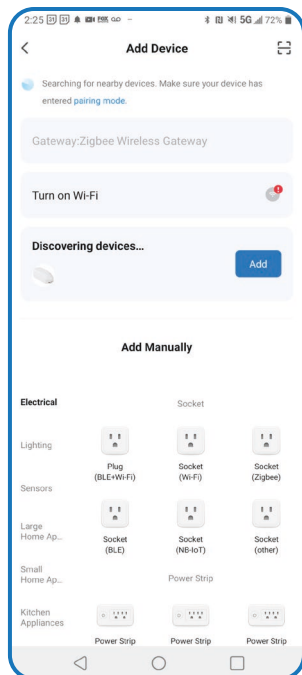

3. You should see a 'Discovering Devices' area and see a thumbnail of the sensor, tap 'Add'

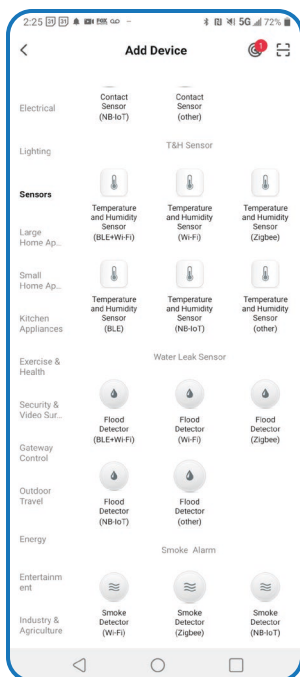

If you still don't see this, scroll down to 'Sensors' and 'Flood Detector (Wi-Fi)'

Make sure your device is connected to a 2.4GHz wifi network and hit next

Confirm the red light on the sensor is still blinking

It should discover the smart water leak sensor and you can tap the blue + icon and it will add it to your app

Once it is successfully added, tap 'Done'

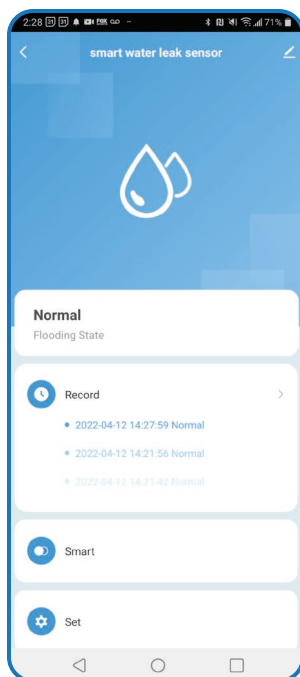

This is the main home screen for the leak detector

This is what you see in the app when an alarm is triggered

Tap 'Set' to check battery level as well as toggle notifications for your device when an alarm is triggered or the battery is low

Tap 'Record' to see a log of times and days when the alarm was triggered or when an automated action is triggered (like closing a ball valve)

Tap the pencil icon to pull up device information of the sensor

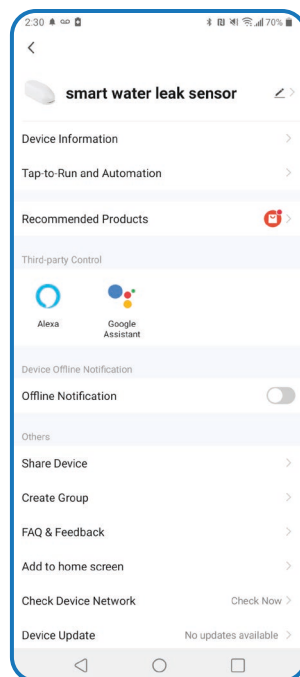

Tap the pencil icon again to name the sensor and set the location

If you have no locations listed, you will have to set up a 'Home' by backing out to the home section and tapping 'Me' at the bottom

# Smart Leak Detector User Manual

**Scan Me**



**Installation Video  
and Online Manual**