

Automatic Hand Dryer

Instructions

Dear User:

Thank you very much for choosing our automatic hand dryer.

Please read the instruction carefully before in stallation.

Please keep it well for future reference.



Reminder

1. please install on the wall which is not easily vibrated.
2. prohibit collision with hard objects and scratch in order to avoid affecting appearance.
3. prohibit the direct washing, don't use banana water, alcohol and other corrosive liquids to wipe the shell.
4. If the enclosure is contaminated, please cut off the power and wash the case with wet towel and soapy water.
5. If the power cord is damaged, in order to avoid danger, it must be replaced by the professional personnel of the maintenance department or similar Department of the manufacturer.

Product parameters

Voltage	220-240V~	Induction Distance	12±3CM
Frequency	50/60Hz	Heating Mode	Electric heating wire
Power	1500W	Dry hand time	7-10 s
Installation	Wall mount	Dimensions	390X234X144MM

Part name

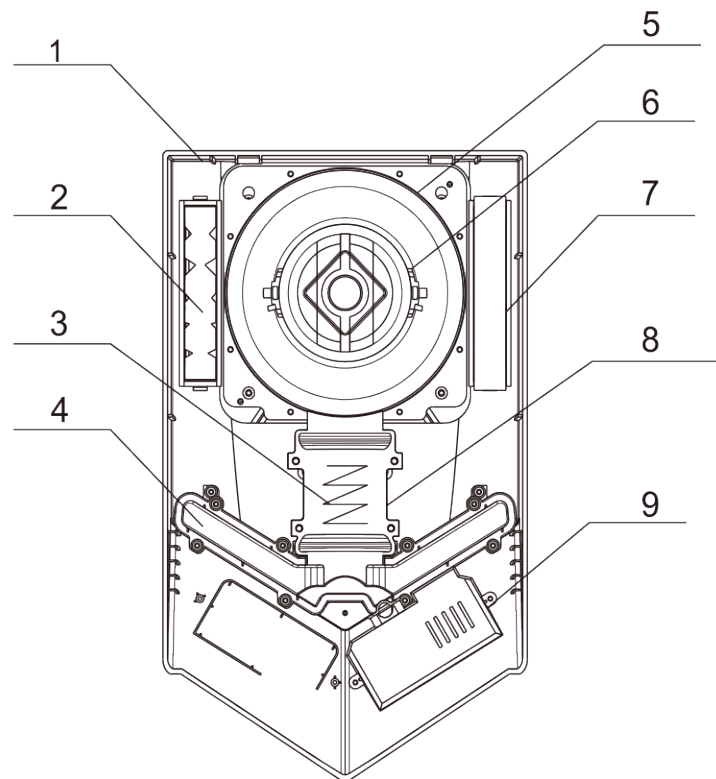

- 1.shell
- 2. air filter
- 3. heater
- 4. air spout
- 5. motor frame
- 6. motor
- 7. air inlet
- 8. heater box
- 9. pcb

Installation and debugging

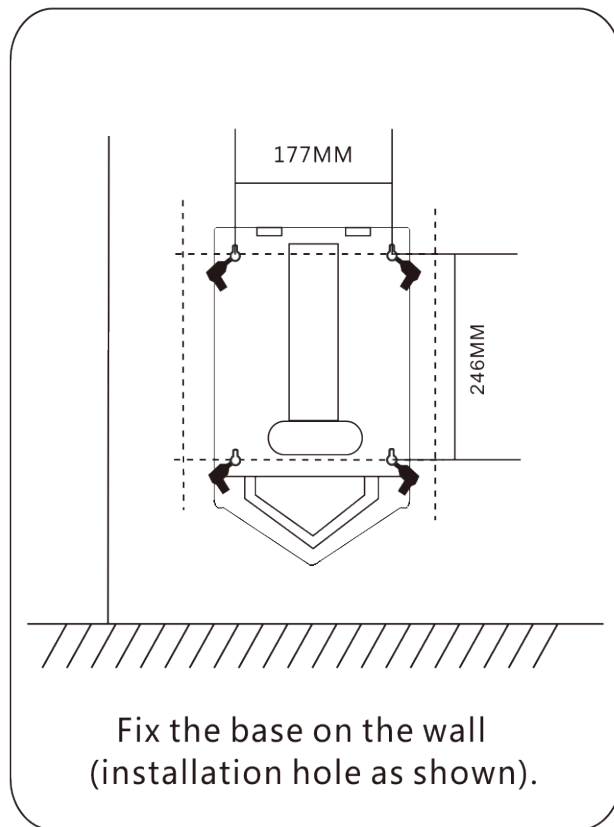

①

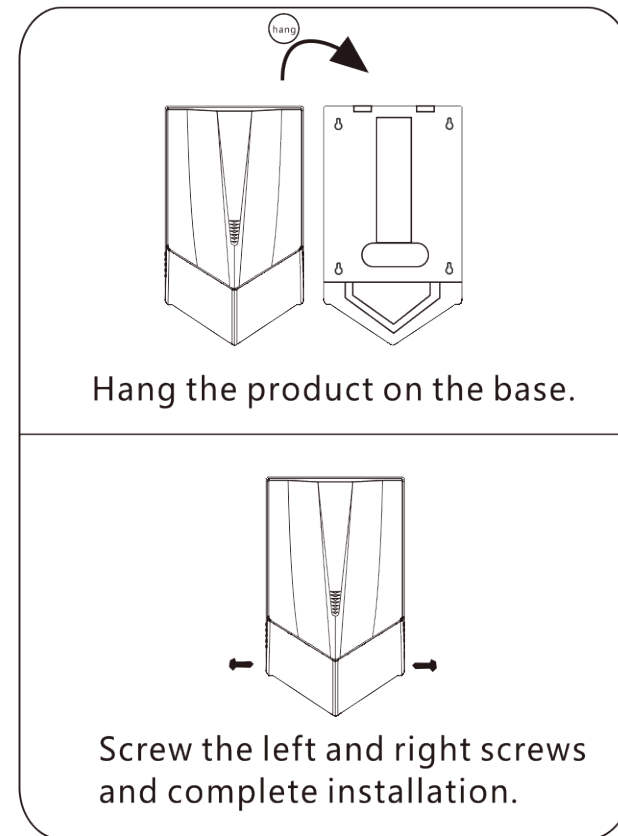

②

Usage method

1. Make sure the power supply is normal before using the machine.
2. Sensor distance: 10 ~ 15cm
3. After about 60 seconds of continuous work, it will stop working.

