

1	Spout
2	Base Plate Cover
3	Grub Screw
4	Mounting screws
5	Water inlet base
6	Water cap
7	Flushing pipe connector
8	Flushing pipe

Step 1
Add teflon tape to the Outlet Pipe
andscrew into the outlet pipe .

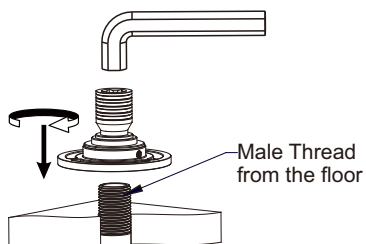

Step 2
Mount the Base into the floor

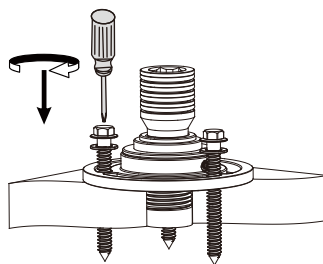

Step 3
connect the flush pipe with a hose and flush
water into a bucket or similar to make sure no
dirt is stuck int he water supply that can block
the aerator

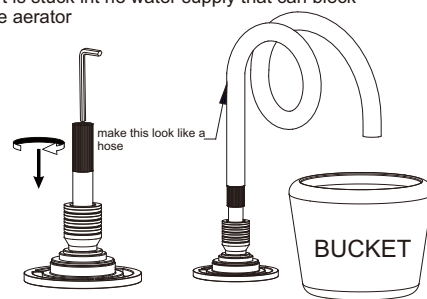

Step 4
1. Mount base plate cover

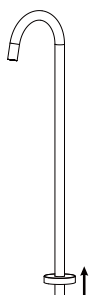

Step 5
1. Screw in grub screw
2. Slide base plate to sit in position

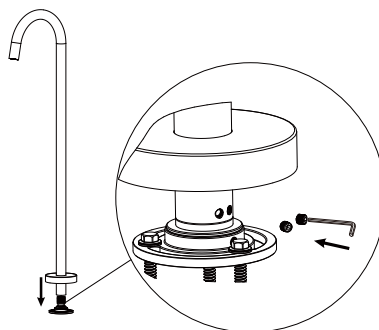

Install is now complete



This tap must be installed by a licenced plumber