

INSTALLATION INSTRUCTINOS

Noggin

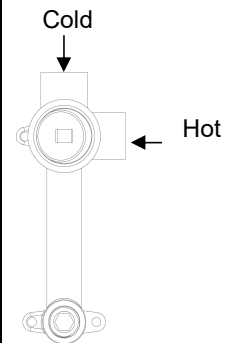

1

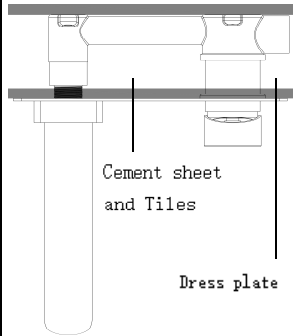
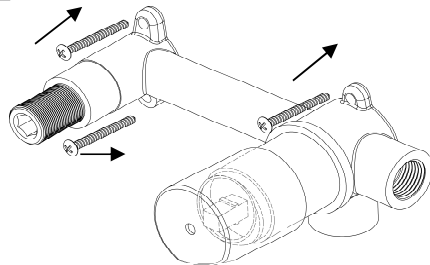

- 1.Screw the Mixer Body onto Noggin
- 2.Ensure the Mixer Body is level
- 3.Connect hot and cold water supply
- 4.Test and check for leaks

2

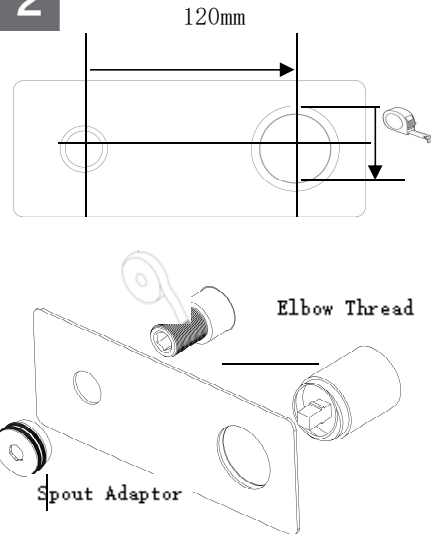

1.The centre distance of the mixer body is 120mm

2.Check the back of the Dress plate, measure the size of the Rubber Ring

3.Creat two suitable holes in cement sheet and tiles. Make sure both holes are big enough to install the rest of fittings.

4.Remove the protective cover. Apply Taflon tape to Elbow thread (7 turns) and screw it into the body. Make sure there is no leak. Put O-ring and lock nut after.

5.Put the face plate on, Remove the spout adaptor from the spout. Screw it to Thread with an Allen key.

3

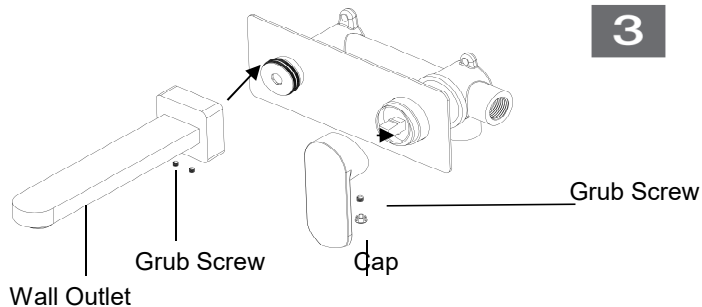

1.Push Outlet to the spout adaptor and fasten Grub Screws to secure.

2.Fit Mixer Handle into position and tighten Grub Screw to secure the handle.

3.Fit Cap into position



Recommended
Woring Pressure
150-500KPa
Maximum Hot
Water Temperature
75 degrees



Note:

.If the pressure exceeds or likely to exceed 550kpa, an approved pressure limiting device must be installed.
.Flush out all pipe work prior to installation.
.If the water temperature exceeds 75°C, an approved tempering valve must be fitted.
.Installation should comply with Australian standard AS3500.
Failure to comply with the above may void all warranties

MAINTENANCE AND CARE:

.Products should be cleaned with mild liquid detergent or soap and water
.Do not use cream cleaners or citrus based cleaning products,as they are abrasive
.Use of unsuitable cleaning agents may damage the surface.any damage casued in this way will not be covered by warranty

DISCLAIMER:

.While we aim to ensure the specifications shown are correct at the time of printing,Inspire bathware reserves the right to make modifications without prior notice.