

ECT

ECT Global Pty Ltd

Add:37 Paramount Blvd Derrimut VIC 3026

Tel:03 8390 6300

Http://www.ectglobal.com.au

ASDF*****-1.0

**Concealed Urinal Sensor
Installation and
Operation Instructions
URSES01**

Flushometer
Urinal Flushing
Infrared Sensor Operated



Reference to installation in accordance with AS/NZS 3500.2

Thank you for choosing our product. Please read the instructions carefully before installation and keep it available for future maintenance or reference.

Content

| | |
|--------------------------------------|-------|
| Product Features | 1 |
| Components Name..... | 2 |
| Specification Parameter | 3 |
| Usage Instruction | 4 |
| Usage Cautions..... | 5 |
| Cleaning and Maintenance | 6 |
| Installation Instruction | 7/11 |
| Adjustment of Sensing Distance | 12 |
| Water Volume Adjustment | 13 |
| Filter Cleaning | 14/15 |
| Troubleshooting Guide..... | 16 |

11. Troubleshooting Guide

| Problem | Cause | Solution | Reference steps |
|----------------------------------|---|---|------------------------------|
| No flushing | Battery is out of electricity. | Replace new battery. | Reference chapter eight (7) |
| | Sensor window needs cleaning. | Remove the dirt. | |
| | Water supply is cut off. | Connect water supply and wait for the water. | |
| | Filter is dirty and causes block. | Clean the filter. | Reference chapter eight (10) |
| | Water pressure out of operating range. | Adjust the water pressure to operating range. | |
| Water not shut-off | The connecting wires between solenoid valve and sensing model falling off. (black wire) | Re-connect the black wire and sense for 10 seconds. | Reference chapter eight (9) |
| | Water pressure out of operating range. | Adjust the water pressure to operating range. | |
| | Water is dirty and impurities stuck at solenoid valve seal. | Clean the internal of solenoid valve. | |
| Inadequate flushing water | Water volume is too small. | Adjust water volume to desired. | Reference chapter eight (9) |
| | Filter is getting dirty. | Clean the filter | Reference chapter eight (10) |
| | Operating pressure is too low. | Adjust the water pressure to operating range. | |
| Too much flushing water | Water volume is too big. | Adjust water volume to proper. | Reference chapter eight (9) |
| | Operating pressure too high. | Adjust the water pressure to operating range. | |
| Battery life too short. | Using a none-alkali or poor quality battery. | Replace standard battery. | Reference chapter eight (7) |
| Indicator flashing | Battery is out of electricity. | Replace battery. | Reference chapter eight (7) |

1. Product Features

- ◆ **Hygiene Sanitary**
The automatic electronic Flushometer relies on infrared sensor to detect a user and activate a flushing cycle. No physical contact with the Flushometer surface is necessary, assuring sanitary protection.
- ◆ **Self-defence of auto-cutting electricity**
The sensor valve core can be closed automatically, when the sensor is out of electricity, falling off or breaking of battery box wires.
- ◆ **Water Saving**
The sensor is equipped with a water volume regulator and can automatically flush the needed amount of water when used.
- ◆ **Power Saving**
It applies four batteries with average consumption of 0.2mW under static and can be used for 2 years, based on 4000 cycles per month.
- ◆ **Self-cleaning**
When the urinal has not been used for a long time, the sensor will automatically flush every 24 hours to avoid the deodorizer and the sewer pipe from drying up.
- ◆ **Steady and reliable**
The sensor applies high technology, that ensures reliable tightness of controlling wires and waterproof of connectors, hence to guarantee reliable function and long life.
- ◆ **Easy daily maintenance**
The internal filter is easy to remove for cleaning.

Note: some product features could vary according to different requirements.

2. Components Name

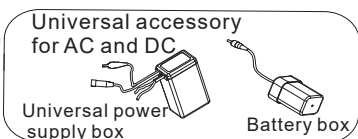
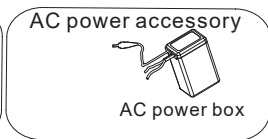
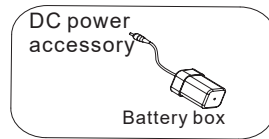
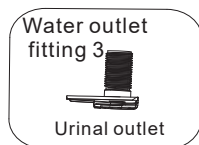
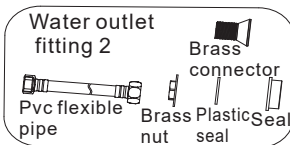
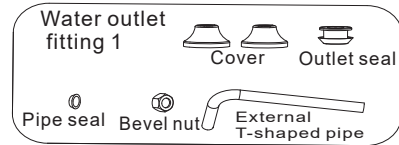
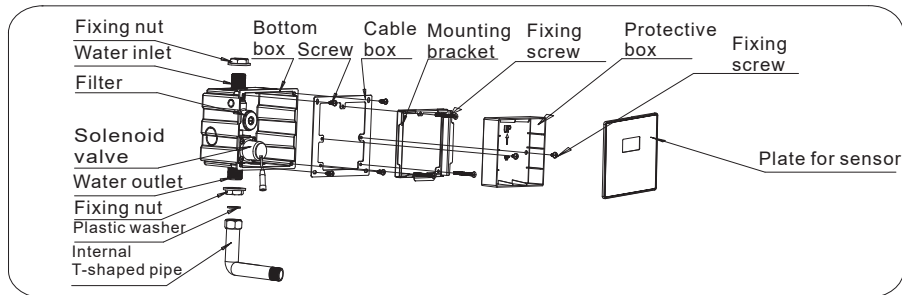

The instructions is composed based in the latest product specifications.
We reserve the right to make modifications to the instructions without providing prior notification.
Pictures for reference only , subject to our available products.

⑤ Re-install the filter

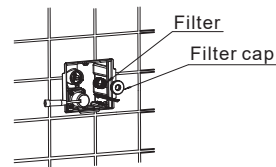

⑥ Turn clockwise with a S10 hexa wrench to tighten the filter cap.

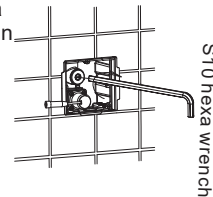

⑦ Turn counterclockwise the adjusting bolt with flat screwdriver to open the valve and re-install the plate.

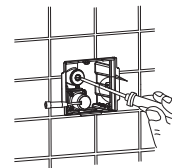

10. Filter Cleaning

- ① Follow steps ⑧ under chapter eight (7) to take down plate and turn clockwise the adjusting bolt with a flat screwdriver to close the valve.

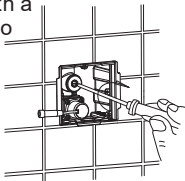

- ② Take out the fixed cap on filter with a S10 hex wrench to turn counterclockwise.

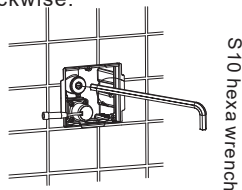

S10 hex wrench

- ③ Remove filter with care.

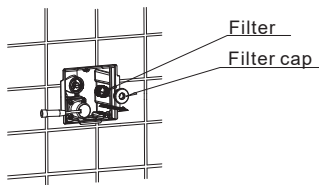

- ④ Flush the filter under tap water.



3. Specification Parameter

| | | |
|-----------------------------|--|------------------------|
| Model | D3000 | |
| Power | DC: 4 "AA" size alkaline batteries | AC: 100V~240V, 50/60Hz |
| Working temperature | 1°C-45°C | |
| Battery life | About 2 years based on average 4000 flushing cycles per month. | |
| Sensing distance | Factory set valve at 65±5cm (adjustable) | |
| Water inlet thread | External thread G1/2 | |
| Water outlet thread | External thread G1/2 | |
| Working pressure | Static pressure range 0.05MPa-0.8MPa | |
| Flow rate and volume | Flow rate ≥ 0.15L/S | Volume ≤ 1.5L |

4. Usage Instruction

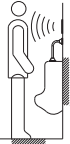
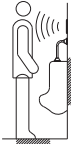
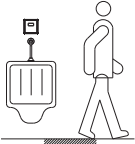
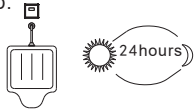
| ①Sensor | ②Prior use flush | ③After use flush | ④Automatic flush |
|--|--|---|---|
| <p>This flushometer identifies the presence of a target within sensing distance.</p>  | <p>The flushometer will automatically flush after 3 seconds' sensing and when usage interval is less than 1 minute, there is no prior use flush.</p>  | <p>After a detected user moves out the effective range of the sensor, the flush cycle is initiated automatically.</p>  | <p>When the urinal has not been used for a long time, the sensor will automatically flush every 24 hours to avoid the deodorizer and the sewer pipe from drying up.</p>  |

9. Daily Maintenance

Water volume adjustment

When there is too less water or none water coming out of urinal, please follow steps ⑧ under chapter eight (7) to adjust water volume. Use a flat screwdriver to rotate adjustor to get desired water volume. Clockwise for less water and counterclockwise for more water. After adjustment, install back the cover plate properly. (The factory set value is maximum water volume.)

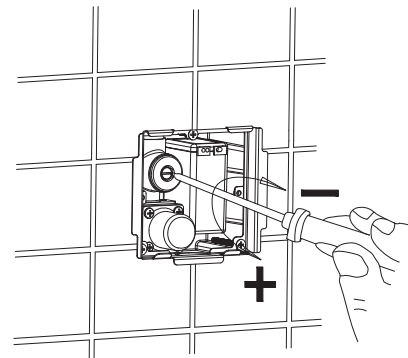

8. Adjustment of Sensing Distance

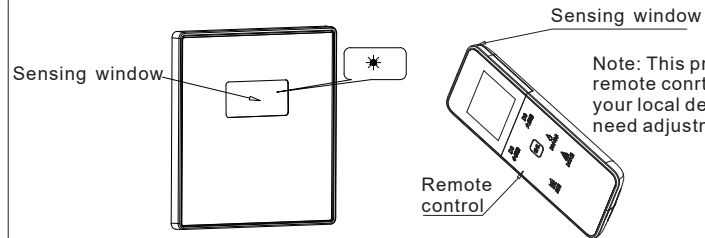

The sensing distance can be adjusted by remote controller, and the default set is about 65cm. Press "D3 urinal sensor" button first, and then choose "distance" button to "extend" or "shorten" the sensing distance by pressing "+" and "-" button, and finally press "OK" button to send the signal. When press "OK" button, the sensing window on remote controller must face to the sensing window on urinal sensor. The indicating light will flash rapidly after receiving the valid instruction, which means the sensor receives the valid instruction of adjusting distance.

Note: The distance lengthen or shorten about 3cm by adjusting one time. The remote control is optional.

5. Usage Cautions

The flushometer contains electronic components and please do follow by below usage cautions strictly.

① Do not attack the sensor.

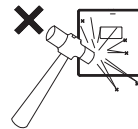

Inside the plate is an electronic instrument and do not attack to avoid malfunction.

② Do not flush the sensor with water.

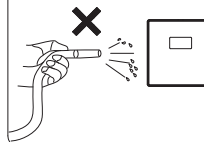

Do not clean the sensor with water, to avoid electrical troubles.

③ No sunlight attack.

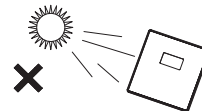

Do not let sunlight or other strong ultraviolet attack sensor window.

6、Cleaning and Maintenance

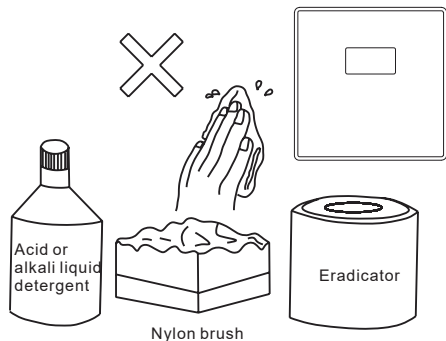

1. The sensor plate can be cleaned by soft rag with neutral liquid detergent.
2. Do not use eradicator, abrasive powder or oil, acid or alkali liquid detergent and nylon brush to clean the product, to avoid damage.

⑧

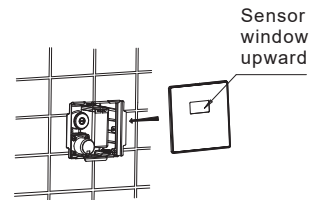

Install plate with photoelectric sensor into the mounting bracket.

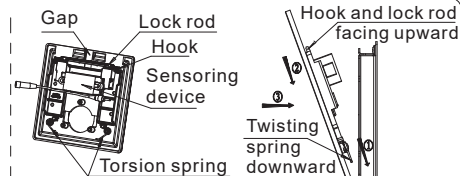

Installation method of quick-released plate: First, press the twisting spring into the mounting bracket according to the graphic direction, then press the plate down, then push in, press the hook and lock rod into the mounting bracket.

Disassembly of plate

△The product is equipped with anti disassembly function. The non professional maintenance personnel cannot remove plate and frame.

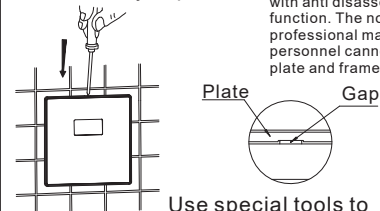

Use special tools to insert into the upper end of the plate and press down to the bottom.

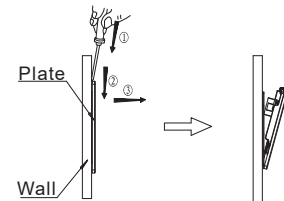

Keep the tool under pressure while holding the upper end of the plate with your hands and press it downward.

AC installation

Connect the lead wire to AC
(100V~240V) power

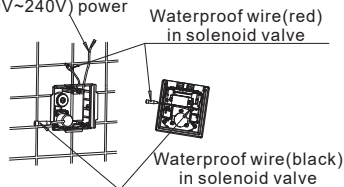

Connect the power wire (red) and solenoid valve wire (black) respectively to matching down-lead on sensor (Note: Colors of wire should be corresponding each other.)

Installation of universal in-put for DC and AC

Connect the lead wire to AC
(100V~240V) power

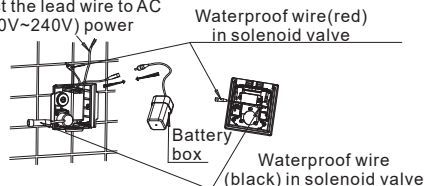

1. Connect the power wire (red) and solenoid valve wire (black) respectively to matching down-lead on sensor (Note: Colors of wire should be corresponding each other.)
2. Connect down-lead to AC power.(Attention: This must be done by electrician, to ensure airproof insulation at connection. For safety, please always shut off the power supply during installation of AC power.
3. For products of universal in-put for DC and AC , the battery requested to be installed into battery box.

7. Installation Instruction

Note Inside the water supply pipe, there might be sands, rusts and other impurities that will influence life of solenoid valve. Hence always clean the supply pipe before installation.

① Installation Reference Drawing (dimension only for reference)

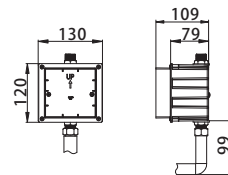
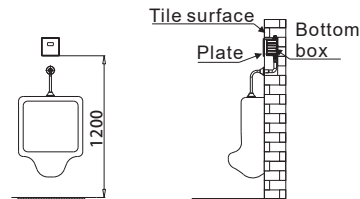

Dimension of bottom box and internal T-shaped pipe.

② Plumbing Rough-in Drawing (dimension only for reference)

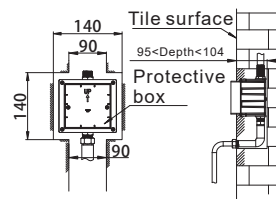

- ③ Place bottom box and protective box into roughing-in groove, and connect the joint, insert the wedge washer to make sure installation position is flat and proper.
(Note: Before moving next step, perform the flushing after installation of supply pipe, to make sure no leakage between pipe and joint.)

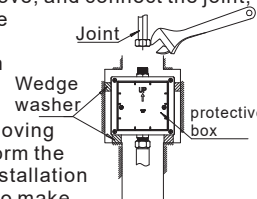

- ④ Plaster the tile and smooth the surface.
(Note: Tile surface should be lower than protective box, however higher bottom box.
Do not use acid liquid detergent to clean the tile, to avoid corrosion or damage to bottom box)

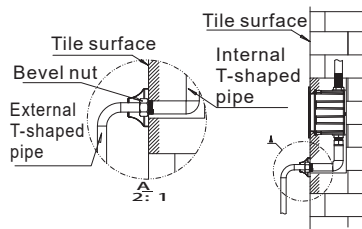
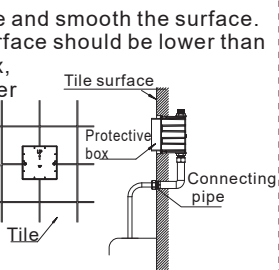

Suggestion: Make thread of internal T-shaped pipe 12mm higher than tile surface, for convenience of installation and replacement of external T-shaped pipe and outlet fittings.

- ⑤ After the plaster well formed, loose the fixing screws on protective box and take down the box.

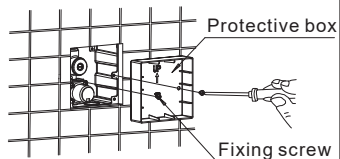

- ⑥ After removed the protective box, install the mounting bracket on the bottom box group in the direction shown, and then locked with three fixed screws.

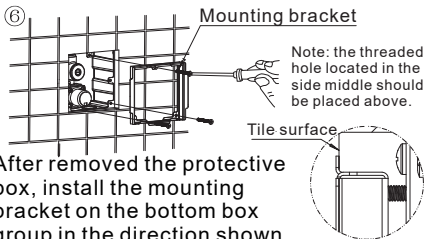

⑦ DC Installation

Place the battery box into bottom box .

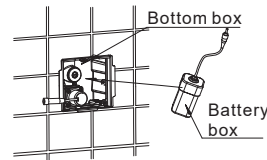

Place the battery box into bottom box and follow below remarks.

- 1) It must be "AA" size alkaline batteries with 1.5 volt.
- 2) Do not mix different brands, new and used batteries together.
- 3) The non-alkaline batteries come with short life.

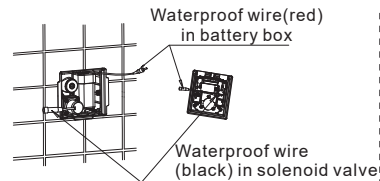
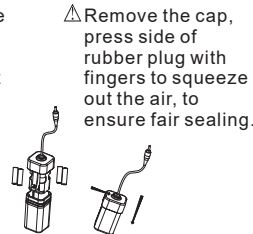

Connect the power wire (red) and solenoid valve wire (black) respectively to matching down-lead on sensor. (Note: Colors of wire should be corresponding each other.)

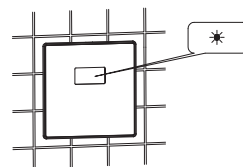

When indicating light keeps flashing, it means the battery is out of electricity. Please replace the battery in accordance with below steps.