

BARROW POLICE STATION, BARROW-IN-FURNESS

Client: H & H Group Plc
(Carlisle)
Value: £4.9m

Completion:
Phase 1 August 2018
Phase 2 February 2019

Duration: 91 weeks
Contract: JCT Standard Form
of Contract 2011 Edition

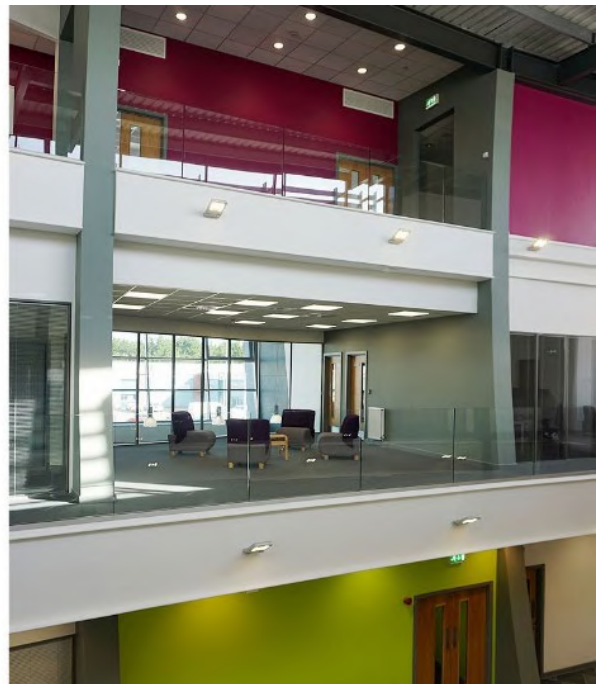

This contract consisted of a new three storey structure with attached buildings and associated hard landscaped areas consisting of parking facility and operational areas. The complex provided a new fully operational police station for Barrow-in-Furness and surrounding area.

WORKS INCLUDED

- Concrete foundations, steel frame, cladding, curtain wall, masonry & precast floors
- Curved full height glazed façade
- Bespoke reception desk including bullet proof glass
- Glazed screens with full height oak doors
- Bespoke manufactured brew stations
- Suspended ceilings
- Raised access floors to large open office areas
- Burlington Slate floor within main reception and into atrium
- Artwork, live trees and LED lights to complement the ambience
- Helical staircase & glass balustrade
- 18 holding cells & holding rooms

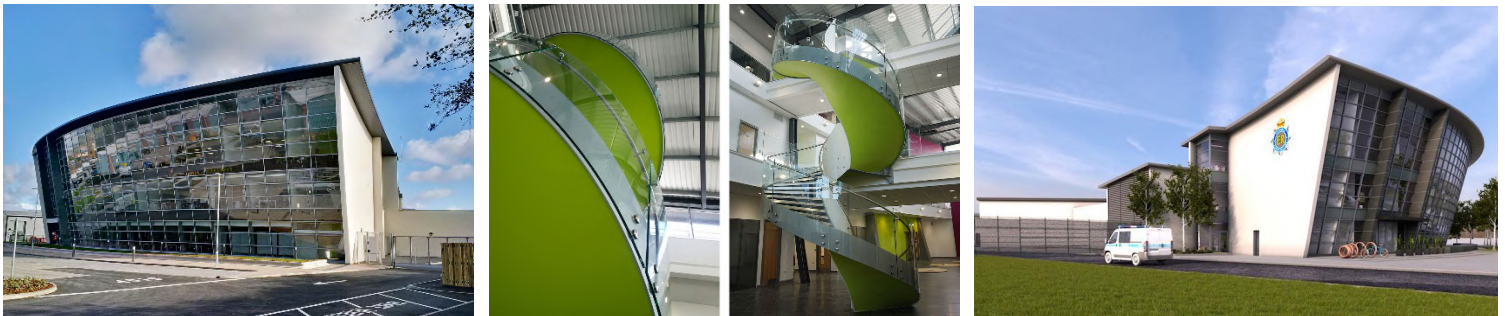

ACHIEVEMENTS

- Compliance with BREEAM requirements to achieve a 'very good' rating.
- The project obtained a Considerate Constructors Performance Beyond Compliance Certificate.
- Introduction of renewable technologies & quality design.
- The project was delivered with zero prohibition notices or reportable Health & Safety/Environmental notices issued.
- Over 99% of waste was diverted from Landfill.

