

Includes Glue Täckplatta, Foam Backing and Screwdriver.

Remove existing key lock and handle on the inside of the door.

Remove the existing thumb turn and plate from your door.

Mount your accessory plate and handle onto the door.

1

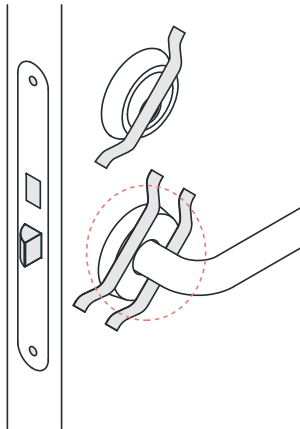

2

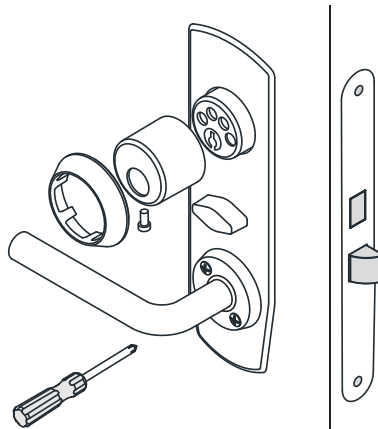

3

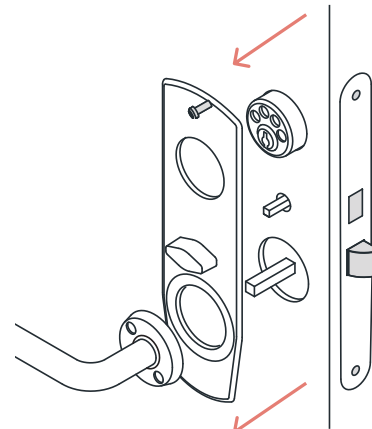

4

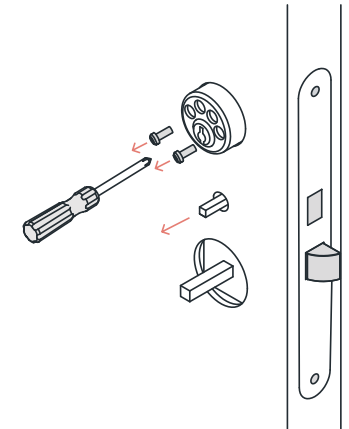

5

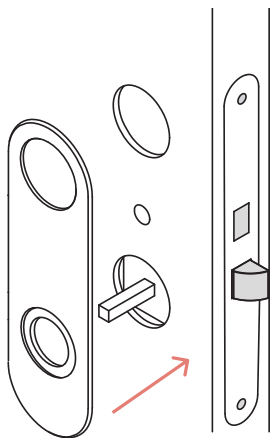

6

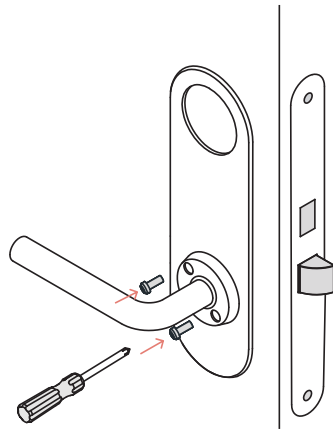

7

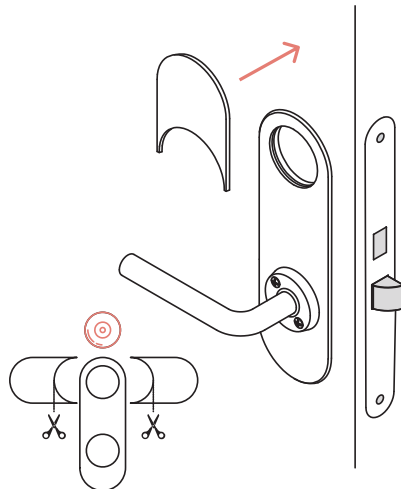

8

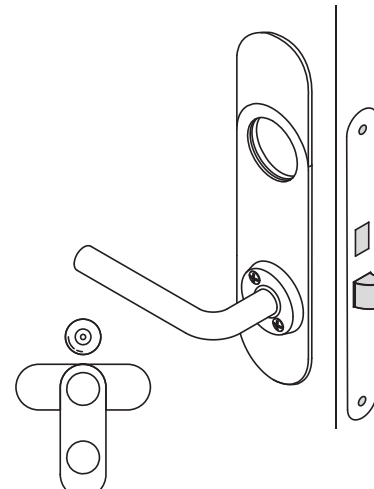

9

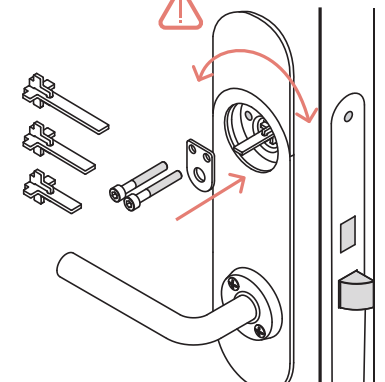

Proceed to step 3C of the Glue Smart Door Lock installation guide.
DO NOT ROTATE THE LOCK OR TAILPIECE.