

'OFFSHORE SUPPLIER'

350BHP Utility Vessel



PARTICULARS

IDENTIFICATION

Flag / Port of Registry	South Africa, Cape Town
Call Sign	ZR 8001
Gross Tonnage	47

BUILT

Year	Built 1987, converted 2009
Builder	Liebenberg & Stander

DIMENSIONS

Length overall	18.2 metres
Beam	7.20 metres
Depth (mid)	1.80 metres
Draft (Light)	1.10 metres
Draft (Laden)	2.20 metres
Clear deck area	70.00 m ²
Gross tonnage	47.42

MACHINERY

Main engines	2 x Detroit Diesel 6v91
Total HP	2 x 175 BHP
Bollard pull	4 Tonnes
Propellers	2 fixed pitch
Gensets	2 x 5kW 220V AC

SPEED

Service speed	9.0 knots
---------------	-----------

LIQUID / BULK CAPACITIES

Fuel oil	5000 litres
Deck cargo	32 Tonnes
Hold volume	32 m ³ total

DECK EQUIPMENT

Deck Crane	1 Tonne SWL hydraulic
Moorings	Stock anchors on chain/ropes
Stern	Open
Deck Area	70 m ³

ACCOMMODATION

Total berths	6 Persons
Crew	5
Passengers	12 Day Pax

NAVIGATION / COMMUNICATION EQUIPMENT

Navigation Equipment	GPS Plotter, Sounder, Mag Compass, Radar, GPS
Communications	CAVICOM; AIS; VHF; Sat/Mobile telephones; VHF Portables

E&OE

GODFREY NEEDHAM

Mobile: +27 83 230 0822

Email: godfrey@marineservices.co.za

24 HOUR CONTACT

Mobile: +27 83 658 2540

Email: launch@marineservices.co.za

OFFICE

Tel: +27 (0)21 425 3372

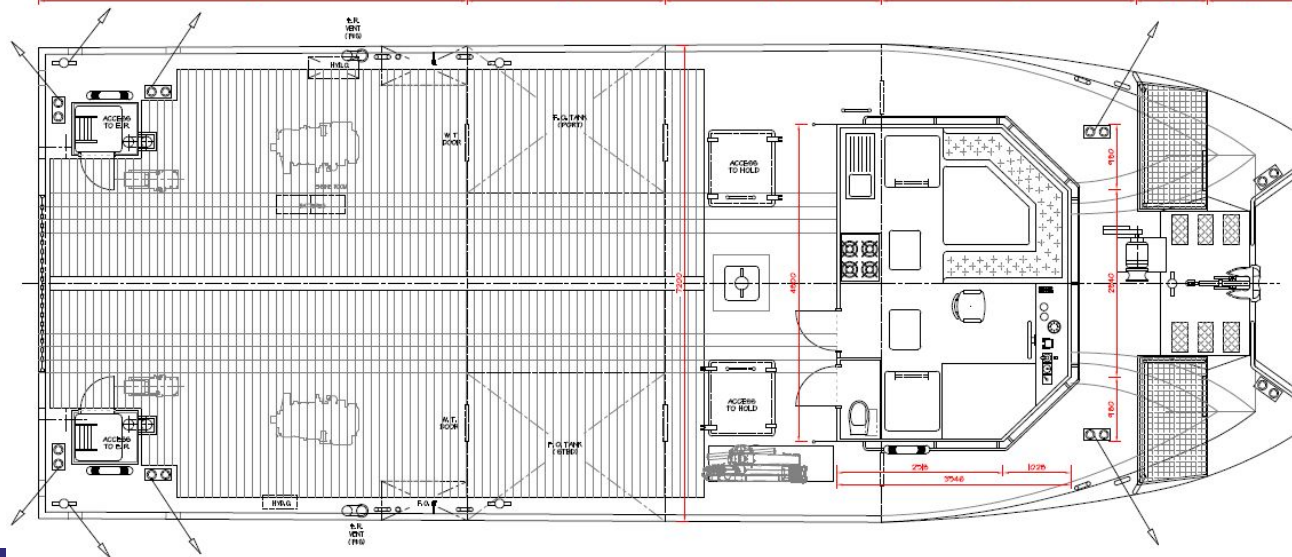
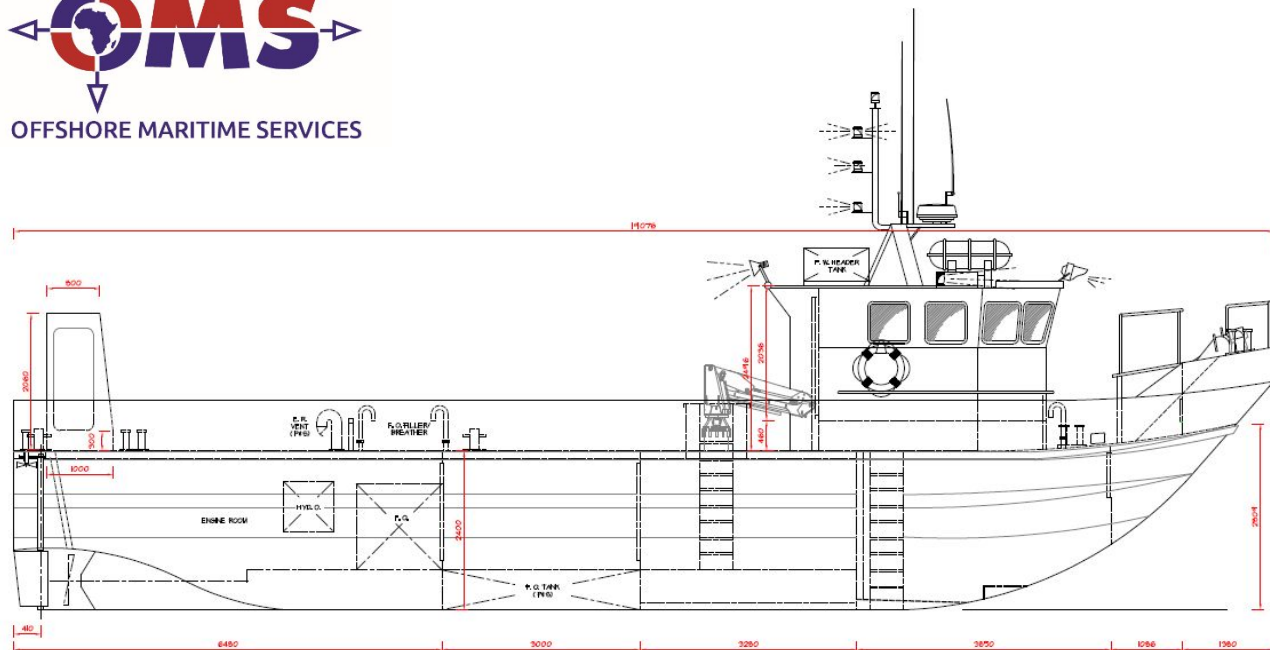

GODFREY NEEDHAM

Mobile: +27 83 230 0822
Email: godfrey@marineservices.co.za

24 HOUR CONTACT

Mobile: +27 83 658 2540
Email: launch@marineservices.co.za

