

Technical Data Sheet

Formwall PVC Hygienic Wall Cladding system



DESCRIPTION:

Formwall is a PVC wall cladding system specifically designed for the healthcare, hospitality, food and process industry. Formwall is hard, durable and highly resistant to impact, abrasion, the thermal shock, chemicals and food acids. It is non-porous, hygienic and easily cleaned.

Formwall may be used in combinations of various allnex systems

FLOOR	WALL	CEILING
<u>Vinyl</u> Durafloor Efina CPS Safety	Formwall White Pastel Vivid	Formwall Ceiling System
<u>Resin</u> Sureshield Nuthane Supascreed Surechem VE Traxite - Other	Formwall White Pastel Vivid	Formwall Ceiling System

TYPICAL FEATURES & BENEFITS:

- Formwall is 2.5mm sheet PVC sheet that is adhesive fixed to backing and then seamed in a variety of ways to provide seamless walling. The materials are based on BIOCLAD 2.5mm sheet wall cladding.
- It integrates with vinyl and resin floors.
- It may be thermoformed to create smooth, radiused internal and external corners that are easy to clean, hence hygienic.
- Unlike other wall linings it is semi-flexible and will not crack under normal impact.
- Normally heated welded to provide seamless finishes.
- Fully adhesive bonded means resistant to impact.
- Attractive satin finish.
- No odour during application.
- Non-Tainting & Non-dusting
- Dense and impervious
- Easily cleaned
- High adhesion and wear resistance
- Very high chemical resistance to: Acids, alkalis, staining materials, Hypochlorite, food acids, blood. Take care with aggressive cleaners, short-term steam and hot water, etc. (see separate data).
- Zero VOC
- Contains a bacterial growth inhibitor. Will not promote bacteria or fungal growth. It is non-toxic.
- IP66 Certified with welded joint –Excellent for Clean room requirements.
- Colours: White (stocked), pastels and vivid colours upon request.

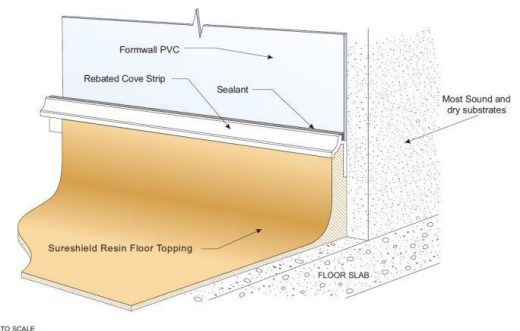

Formwall
PVC Hygienic
Wall Cladding

FORMWALL TO VINYL SHEET SAFETY FLOORING
COVE SKIRTING DETAIL

FW 006
24-05-2013

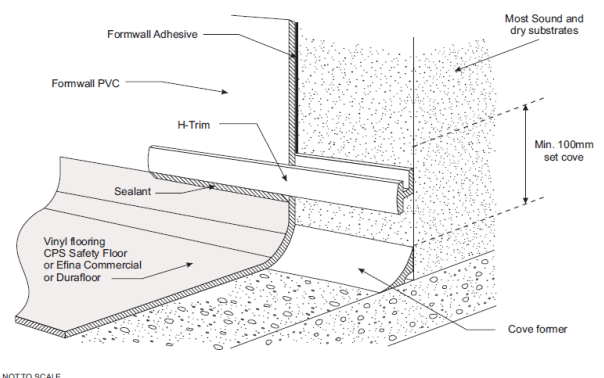

Formwall competes with other cladding products such as Hardiglaze, Marlite and Whiterock in hygienic wall lining areas only.



PERFORMANCE DATA:

Thickness:	2.5mm
Minimum Application Temperature: Air	+10°C
Fire properties:	Group Rating 1 – Report available on request
Chemical Resistance:	Very high resistance to: Acids, alkalis, staining materials, Hypochlorite, food acids, blood.
Compressive Strength:	Nom. 50-60mpa
Heat resistant:	+60°C
Electric Properties:	Non-Conductive
Moisture absorption:	Not moisture permeable
Biocidal product regulation:	Contains silver phosphate glass antimicrobial technology to preserve and prevent degradation caused by microbial growth. Biocide certified by ECHA, FDA, EPA and is BDR compliant. Antimicrobial is an additional line of defence beyond antibacterial with the power to kill fungi, microbes and protozoans as well as bacteria.

RECOMMENDED USES:

- Hygienic walls for: dairy plants | freezing works | abattoirs | meat | small goods | fish and food processing plants | butcheries | bottling plants | breweries | cosmetic | pharmaceutical | food and beverage processing plants.
- Walls where a high degree of performance resistance is of prime importance.
- Food process walls where a high degree of hygiene is required.
- Interior use.
- Can be applied to plywood, plasterboard, concrete & concrete block.
- other substrates refer: allnex Construction Products
- Suitable for use in dry or wet situations.



LIMITATIONS:

- It should be emphasised that success in this application is fully attributable to wall and room design.
- Application to unstable or defective substrates without approved remedial treatment prior to installation.



WARRANTY:

- Formwall is warranted for 20 years for durability.



INSTALLATION :

- Refer : allnex installation instructions.
- Prepare wall surfaces square and perpendicular with laser guides.
- Thermoform sheets as required.
- Adhesive fix all sheets with recommended spacing.
- Install jointer PVC trim or Heat weld seam as per specification.



DETAILS:

- Design Details: http://www.allnexconstruction.com/pdf/Formwall_Details.pdf?v=1.2
- Specification (word): http://www.allnexconstruction.com/doc/Allnex_Formwall-spec.doc
- Masterspec: Formwall is also available on Masterspec



****IMPORTANT****

Use allnex approved contractors with teams that have the skills, capability and experience to undertake the contract size, time schedule and complexity in question. Contractors with skill in both Flooring systems and the Formwall are advantageous.

FEATURES & BENEFITS – FORMWALL WALLING SYSTEM:

FEATURE	BENEFIT	PERFORMANCE CRITERIA
PVC	Durable & Resilient	Impact resistant
Pure PVC	No fillers to degrade	Chemical resistant
Smooth PVC	Wipe down surface	Easy to clean
Dense smooth surface	Easy to clean	Hygienic
Dense PVC	Durable	Hardwearing
Dense PVC	No moisture penetration	Impervious
Fully bonded system	No voids	Not harbour bacteria/vermin
Food grade sheets	No contamination	Food safe
Thermoplastic material	Can be heat formed	Eliminates joints and corner detailing
Joins can be can be thermos-welded	Seamless	Hygienic Joint free
Can be applied over existing wall finishes	Fix to any substrate	Ease of installation cost effective
3.05m x 1.22m sheets	Minimal joints	Hygienic & easy to clean
3.05m x 1.22m sheets	Damaged sheets can be replaced	Easy to repair
Factory finished	Requires no painting or surface treatment	Low maintenance & for life of system maintenance costs
UV stable	Will not discolour	Appearance retention
High quality PVC	Low spread of flame AS NZS 3837 1998	Meets the requirement of the NZBC
Low electrical resistivity	Conforms to conductivity performance	Static dissipation
Silver Ion Antimicrobial Protection	Continuous protection against all common microbes.	Life time warranty
Tested to all current standards	Compliant	Relevant certification
Warranties	20 Years	Long term solution



Date: Nov. 2019
Replaces: May 2018

Allnex Construction products, a Division of Allnex New Zealand Ltd
 Auckland - 14 Industry Road Penrose phone: 095836544. Hamilton - 18 Somerset Street Frankton phone: 07-847-8658
 Wellington - 19A Jamaica Drive Grenada North phone: 04-240-0305. Christchurch - 112 Carlyle Street Sydenham phone: 03-366-6802
 Customer Service: 0508-882-288 cs.constructionnz@allnex.com
www.allnexconstruction.com



DISCLAIMER: This information appearing in this Document (Details) concerning the product which is the subject of the Document (Product) is either based on present technical knowledge and tests done by allnex or tests done by, and data supplied from third parties including you, the customer. Since the actual use by you and by others of the Product is beyond the control of allnex, no warranty or representation, express or implied is made by allnex regarding the suitability for such use, nor does allnex accept any liability arising out of the use by you of other products or materials, whether third party or not, that may be referred to in this Document. allnex recommends that you carry out your own tests as to the suitability of the Product for your purpose, regarding which you accept full responsibility. In addition, if any of the Details appearing in the Document are based upon tests done by, and/or data supplied by any third party, allnex provides no warranties or representations in connection with those Details and you, the customer waives any right you may have against allnex in connection with the accuracy, completeness or otherwise of the Details. The information in this Document is not to be construed as absolutely complete or accurate since additional information may be necessary or desirable when particular or exceptional conditions or circumstances exist or because of applicable laws or government regulations affecting use of the Product. allnex does not provide any warranty or representation to you that the Product does not infringe the intellectual property rights of any third party. All orders accepted shall be subject to the standard conditions of sale of allnex which are on the back of our invoice. In accepting the Product, you, the customer acknowledge and agree: **a.)** The Product is or may be of a hazardous nature and that you, the customer, are responsible for the disposal of the container housing the Product in accordance with the requirements and regulations of the relevant supervising government. **b.)** The Product has a limited shelf life and must be stored strictly in accordance with the guidelines and specifications related to it. **c.)** Where the Details relate to Product tested by allnex, those Details are indicative only, regarding which there may be batch to batch variation. **d.)** allnex gives no warranty or representation as to the applicability for the particular use by you, the customer, of the Product and you the customer shall be responsible for ensuring that the Product is fit for your intended use. **e.)** allnex's liability for breach of any term, condition, guarantee or warranty (express or implied and concerning the information in this Document or the Product more generally) including any liability for direct or indirect consequential loss (including indirect loss of profits), is limited to the maximum extent permitted by law and, at allnex's election, to either replacing or repairing the goods or paying the cost of replacing or repairing the goods, or in the case of services, supplying the services again.