

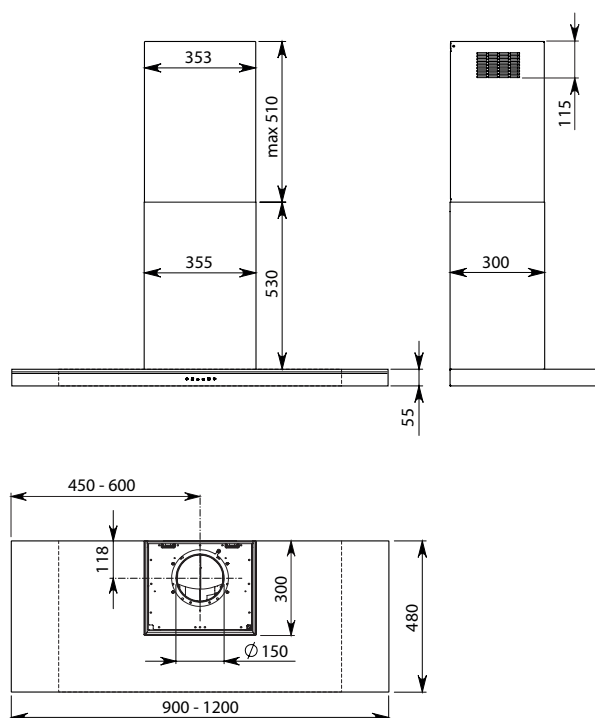

Product Features

<b>Motor Type</b>	On Board Motor
<b>Dimensions</b>	<b>90cm:</b> 900(W) x 1095(H) x 480(D)mm Suits 75cm-100cm Cooking Surfaces <b>120cm:</b> 1200(W) x 1095(H) x 480(D)mm Suits 90cm-130cm Cooking Surfaces
<b>Filter</b>	Perimeter
<b>Lighting</b>	1 x Neon
<b>Controls</b>	Touch Controls
<b>Speed Settings</b>	3 Speed + Boost
<b>Timer Function</b>	15 Min Auto Shut-Off
<b>Ducting</b>	150mm Circular Outlet
<b>Optional Accessories</b>	Charcoal Filters 1200mm Island Flue Extension
<b>Grease Filter Alarm</b>	Yes
<b>Dishwasher Safe Filters</b>	Yes

Dimensioned Drawings



Model Code	Size	Motor Output	Finish
F5LA90S1	90cm	800 m³/hr	Stainless Steel
F5LA90B1	90cm	800 m³/hr	Black
F5LA90W1 •	90cm	800 m³/hr	White
F5LA12S1 •	120cm	800 m³/hr	Stainless Steel
F5LA12B1 •	120cm	800 m³/hr	Black
F5LA12W1 •	120cm	800 m³/hr	White

Special Order •

## LUMINA NRS

### Version

Wall 90 cm - Black - 800 m3/h

### Collection

Silence - NRS

### EAN code

8034122348162

## MOTOR TECHNICAL SHEET

Motor speed	1	2	3	4
Noise level dB(A)re1pW-I.E.C.60704-2-13	37	41	46	54,5
Capacity (m3/h) I.E.C.61591	220	290	375	610
Maximum pressure (Pa)	390	440	490	510
Motor Power (W)	130	150	178	224
Air outlet	150	150	150	150

## LUMINA NRS

### Version

Wall 120 cm - Black - 800 m3/h

### Collection

Silence - NRS

### EAN code

8034122348148

## MOTOR TECHNICAL SHEET

Motor speed	1	2	3	4
Noise level dB(A)re1pW-I.E.C.60704-2-13	37	41	46	54,5
Capacity (m3/h) I.E.C.61591	220	290	375	610
Maximum pressure (Pa)	390	440	490	510
Motor Power (W)	130	150	178	224
Air outlet	150	150	150	150