

Manufactured and distributed by PlayMonster LLC. Product names, designations, and logos are trademarks or registered trademarks of PlayMonster LLC. © Smart Study Co., Ltd. All Rights Reserved. Pinkfong® and Baby Shark™ are trademarks of Smart Study Co., Ltd. © 2021 Viacom International Inc. All Rights Reserved. Nickelodeon is a trademark of Viacom International Inc.

Customer Service:  
Phone number: 1-800-524-4263  
More information on: [www.playmonster.com/contact-us/](http://www.playmonster.com/contact-us/)

FCC Information  
This device complies with part 15 of the FCC Rules. Operation is subject to the following two conditions:  
(1) This device may not cause harmful interference, and (2) this device must accept any interference received, including interference that may cause undesired operation.

- Caution: Changes or modifications to this unit not expressly approved by the party responsible for compliance could void the user's authority to operate the equipment.
- NOTE: This equipment has been tested and found to comply with the limits for a Class B digital device, pursuant to Part 15 of the FCC Rules. These limits are designed to provide reasonable protection against harmful interference in a residential installation. This equipment generates, uses and can radiate radio frequency energy and, if not installed and used in accordance with the instructions, may cause harmful interference to radio communications. However, there is no guarantee that interference will not occur in a particular installation. If this equipment does cause harmful interference to radio or television reception, which can be determined by turning the equipment off and on, the user is encouraged to try to correct the interference by one or more of the following measures:
- Reorient or relocate the receiving antenna.
- Increase the separation between the equipment and receiver.
- Connect the equipment into a power source that is different from that to which the receiver is connected.
- Consult the dealer or an experienced radio/TV technician for help.

CAN ICES-003(B)/NMB-003(B)

For these purposes, the party responsible is:  
PlayMonster LLC  
1400 E. Inman Pkwy.  
Beloit, WI 53511

Made in China  
For warranty information, please visit [www.britebrush.com/warranty](http://www.britebrush.com/warranty)

Package Contents:

- 1 x BriteBrush® Baby Shark™ with Brush Head,
- 1 x Extra Brush Head,
- 1 x User Manual

Required:

- 2 x 1.5V "AAA / LR03" Batteries (included)



PlayMonster LLC  
1400 E. Inman Pkwy.  
Beloit, WI 53511

© SMARTSTUDY All Rights Reserved. Pinkfong® and Baby Shark™ are trademarks of SMARTSTUDY. © 2021 Viacom International Inc. All Rights Reserved. Nickelodeon is a trademark of Viacom International Inc.

61266US03CBF\_MIM

# britebrush®

## pinkfong

# BABY SHARK™

Age: 3+

### USER MANUAL

Congratulations! You're the proud owner of the smartest, most fun brush ever! With games and music, BriteBrush® has patented sensors that know if you're brushing the right way! The better you brush, the more fun you'll have!

### POWER ON/OFF

Press the button to turn on your BriteBrush®. Your BriteBrush® will automatically power off after a game or if you don't brush for a while. Press and hold the button for several seconds at any time to turn it off (you will hear a power down sound).

### VOLUME CONTROL

To play the games with lower volume, your BriteBrush® must first be "OFF." Press and hold the button on the side and continue holding the button until you hear "low volume" then release the button. You can now brush with a lower volume level.

### HOW TO EXIT TRY ME MODE

When you first take the brush out of the package, it will be in 'Try me' mode. After pressing the button, you will hear audio about the brush. Just start brushing up and down, during or after the audio, and you will start a brief practice session for brushing correctly. After you finish the practice session the brush will enter its normal operation mode as described on the next page.

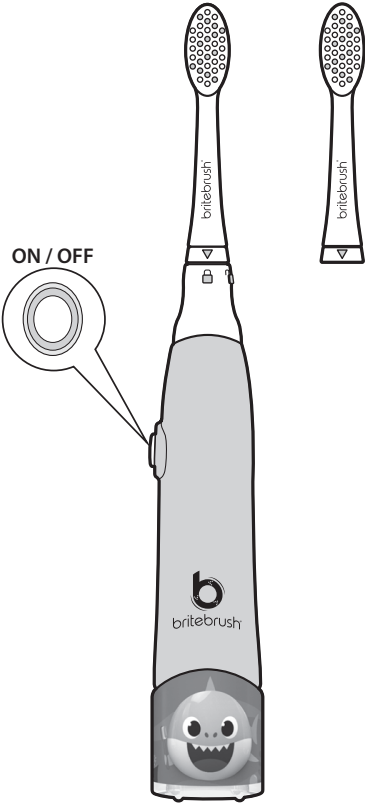

## PLAYING GAMES AND SOUNDS

After turning on your BriteBrush®, press the button to choose one of three modes:

- **Practice** – Work on your brushing technique with fun sounds and lights!
- **Baby Shark™ Song** – Go on a musical adventure with Baby Shark™ and his family!
- **Treasure Hunt Game** – Go on a swimming adventure to find treasures! Play it again and again with different outcomes!

Each game has four sections. See if you can get all 10 stars! Your score is based on how well you brush and follow the instructions for changing sides! If you brush really well, you might win a bonus treasure! The Baby Shark™ Song and Treasure Hunt Game each last about a minute. **Play twice** for approximately 2 minutes of brushing, the amount of time recommended by dentists.

**Remember:** Brushing up and down or in small circles will keep the games going!

### Share Score

To hear the last recorded score, quickly double press the button when your BriteBrush® is off. This will also activate the Share Score: the bottom of the brush will light up with green (complete), yellow (good effort), or red (incomplete).

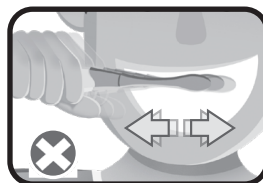
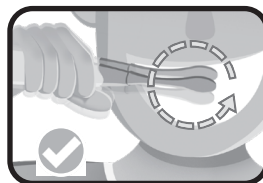
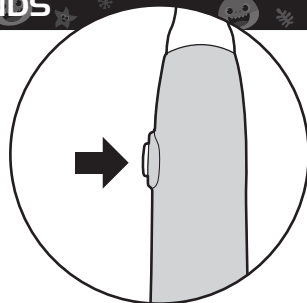

## TIPS ON HOW TO BRUSH

1. Avoid a side-to-side sawing motion that can harm gum tissue. Always brush up and down or in small circles!
2. Try starting with the bristles at a 45 degree angle at your gumline and gently make small circles as you move your brush upwards/downwards toward your biting surfaces.
3. Remember to brush lightly: Brushing too aggressively (too hard and too often) can harm gum tissue.
4. When prompted, change sides. Make sure to brush each quadrant of your teeth fully, inside and out, tops and bottoms – including the biting surfaces.
5. Don't forget your tongue! Brushing it can help get rid of bacteria that cause cavities and bad breath.

## CLEANING/STORAGE INSTRUCTIONS

Rinse with tap water after every use and wipe dry with a soft cloth. A soft brush should be used to clean between the rubber neck and body of the toothbrush on a regular basis.

The rubber neck should NOT be removed as this allows the device to be waterproof.

NEVER put in dishwasher or microwave.

Keep covered while traveling.

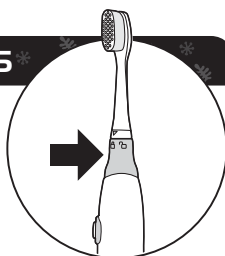

## CHANGING BRUSH HEAD

### Attaching a Brush Head

1. Put your BriteBrush® brush head onto the brush, so the triangle arrow points to the “unlocked” icon.
2. Rotate the brush so the triangle arrow points to the “locked” icon, and you will feel it lock into position.

### Removing a Brush Head

1. Rotate the brush head until the triangle arrow points to the “unlocked” icon.
2. Pull the brush head off the brush.

Note: Dentists recommend changing your brush head every 3 months.

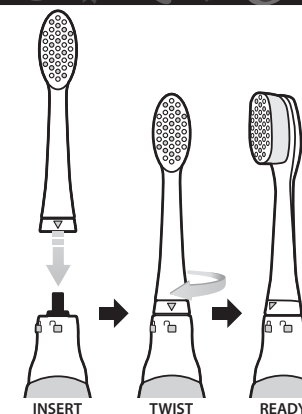

## REPLACING BATTERIES

1. Using a mini Phillips screwdriver (+), remove the small screw near the base of your BriteBrush®.
2. Pull down on the bottom ring of the brush to slide out the electronics.
3. Replace the 2 AAA batteries, inserting them in their correct orientations.
4. Insert the electronics back into the brush handle so that the screw holes line up.
5. Insert and tighten the small screw.

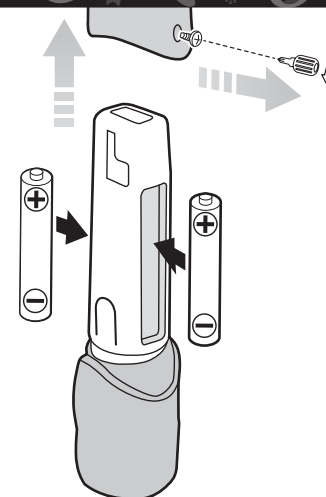

### IMPORTANT BATTERY INFORMATION:

- Adult supervision is recommended when inserting and removing batteries
- Do not mix old (used) and new batteries
- Do not mix alkaline, standard (carbon-zinc), or rechargeable batteries
- Do not attempt to recharge non-rechargeable batteries
- Rechargeable batteries should be charged under adult supervision
- Batteries are to be inserted with the correct polarity (+ and -)
- Remove and properly dispose of exhausted batteries (recycle if possible)
- Exhausted batteries are to be removed from the toy
- Do not short-circuit the supply terminals
- Do not dispose of batteries in fire as they may explode or leak
- Remove batteries from the product when not in use for an extended period of time