

# 3BR

**Much More Than Just A Home** 196 SQM (Net)

Spanning the northwest side of the Odom Living tower, this three-bedroom home has everything you need, and perhaps more. The master bedroom is equipped with a walk-in closet and a large bathroom and bathtub. The views ensure amazing glimpses of the city and awesome sunsets.



4 x 3 x 1 x 3.5 x 2 x

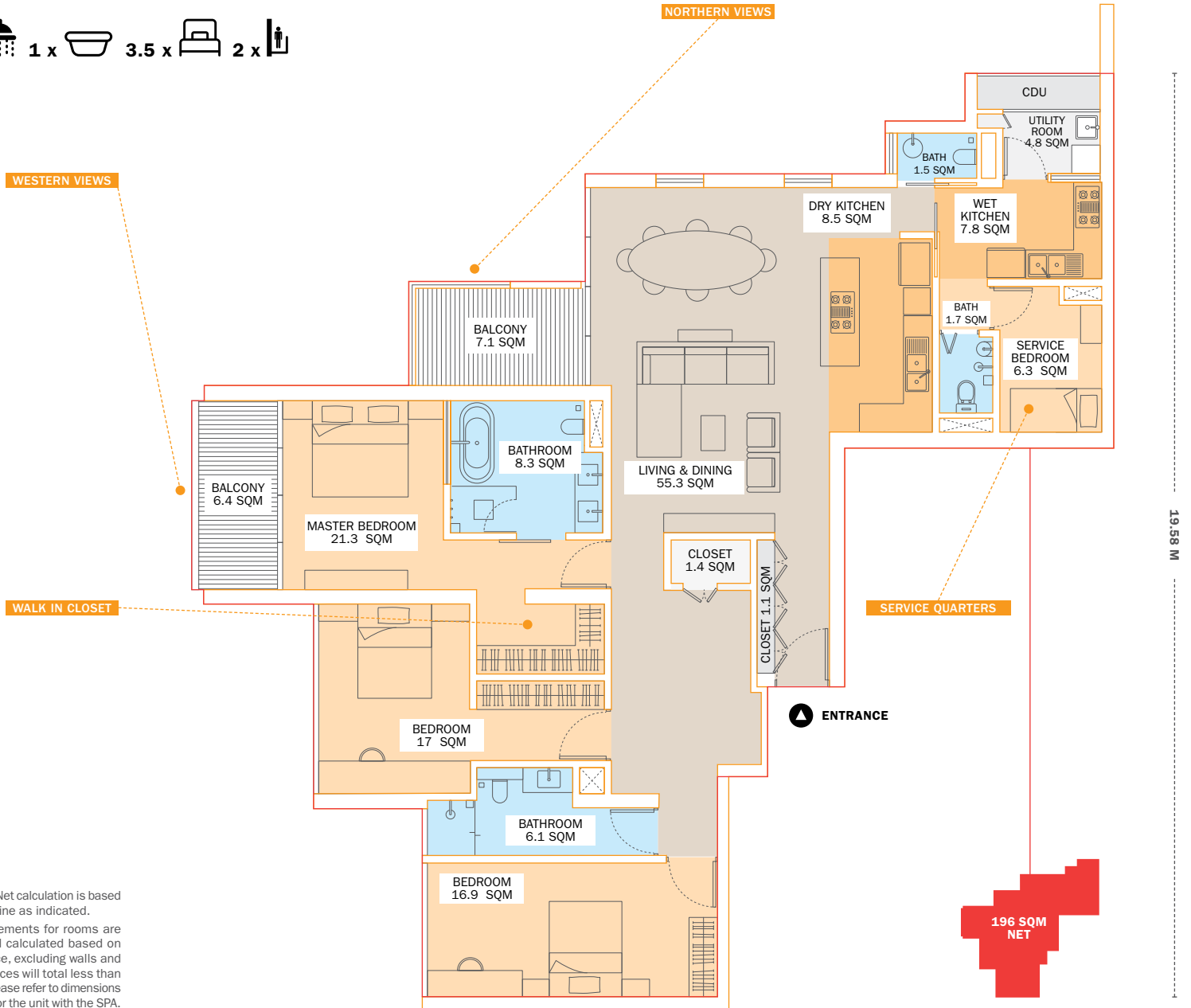

**Net SQM Calculation** Net calculation is based on the perimeter red line as indicated.

**Room Areas** Measurements for rooms are approximate only and calculated based on expected usable space, excluding walls and extrusions. Room spaces will total less than the total NET space. Please refer to dimensions or drawings provided for the unit with the SPA.

**Variance** These drawings represent conceptual layout before final engineering stage and are subject to change based on regulatory or technical requirements.

# 3BR

Much More Than Just A Home 196 SQM (Net)

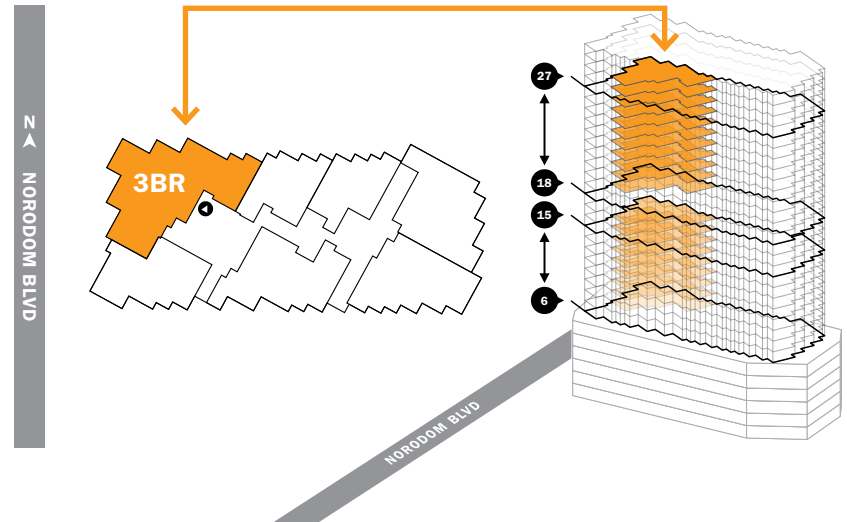

## Amenities

### Equipped kitchen\*

- Wet and dry kitchens
  - Top of the line cabinets
  - Stovetop
  - Oven
  - Electric hood
- \*Refrigerator not included

### Ample bathrooms

- Master bath with bathtub, and dual sinks
- Powder room
- Vanity
- Rain shower in main bathrooms

### Comforts throughout the home

- 2 balconies
- Master bedroom with en suite bathrooms
- Beautifully tiled floors in Living, Dining & Kitchen areas
- AC units in living area and all bedrooms
- Ceiling fans
- Service quarter
- Large closets
- Parquet flooring in bedrooms



TOP: SPACIOUS DINING & LIVING AREA WITH OPEN DRY KITCHEN BOTTOM: VIEW INTO THE MASTER BEDROOM OVER THE EN SUITE BALCONY

