

2B

Large Balcony 126 SQM (Net)

Great for couples and young families alike, this two-bedroom unit beams with natural light throughout the day thanks to its double exposure (south and east).

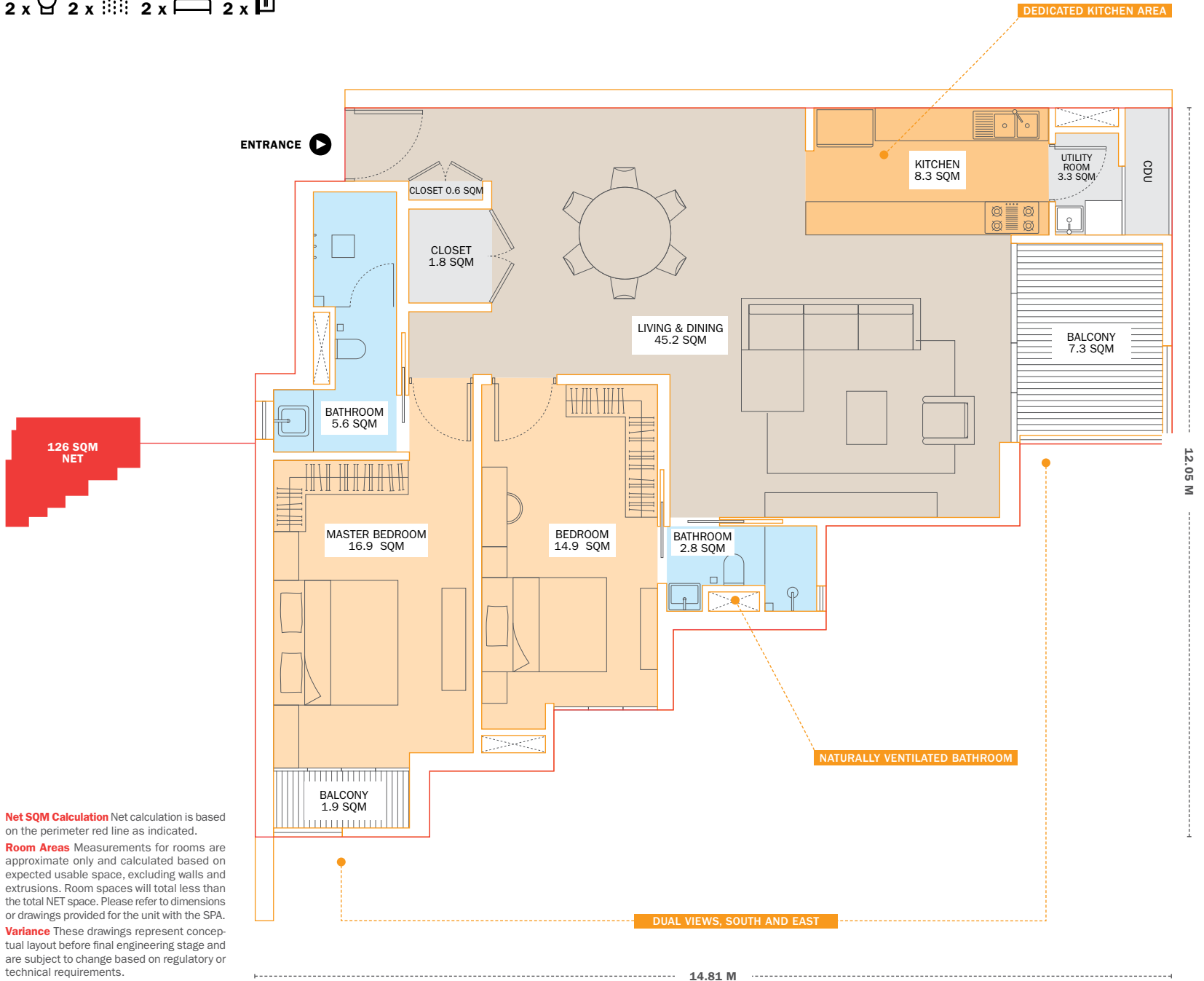

Net SQM Calculation Net calculation is based on the perimeter red line as indicated.

Room Areas Measurements for rooms are approximate only and calculated based on expected usable space, excluding walls and extrusions. Room spaces will total less than the total NET space. Please refer to dimensions or drawings provided for the unit with the SPA.

Variance These drawings represent conceptual layout before final engineering stage and are subject to change based on regulatory or technical requirements.

2B

Large Balcony 126 SQM (Net)

The southeast views of our 2B homes receive light throughout the day with less heat. Enjoy amazing sunrises and views towards the Mekong.

NORODOM BLVD

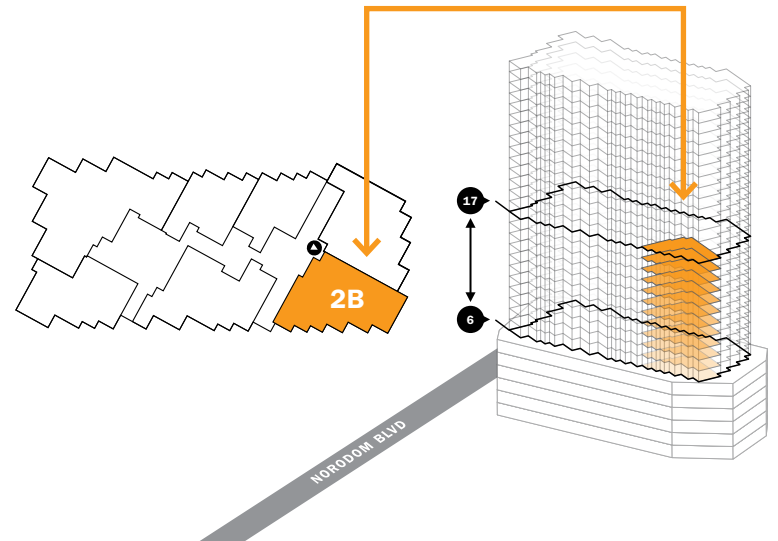

ODOM IS DESIGNED BY SINGAPORE-BASED KITE STUDIO

ODOM
LIVING

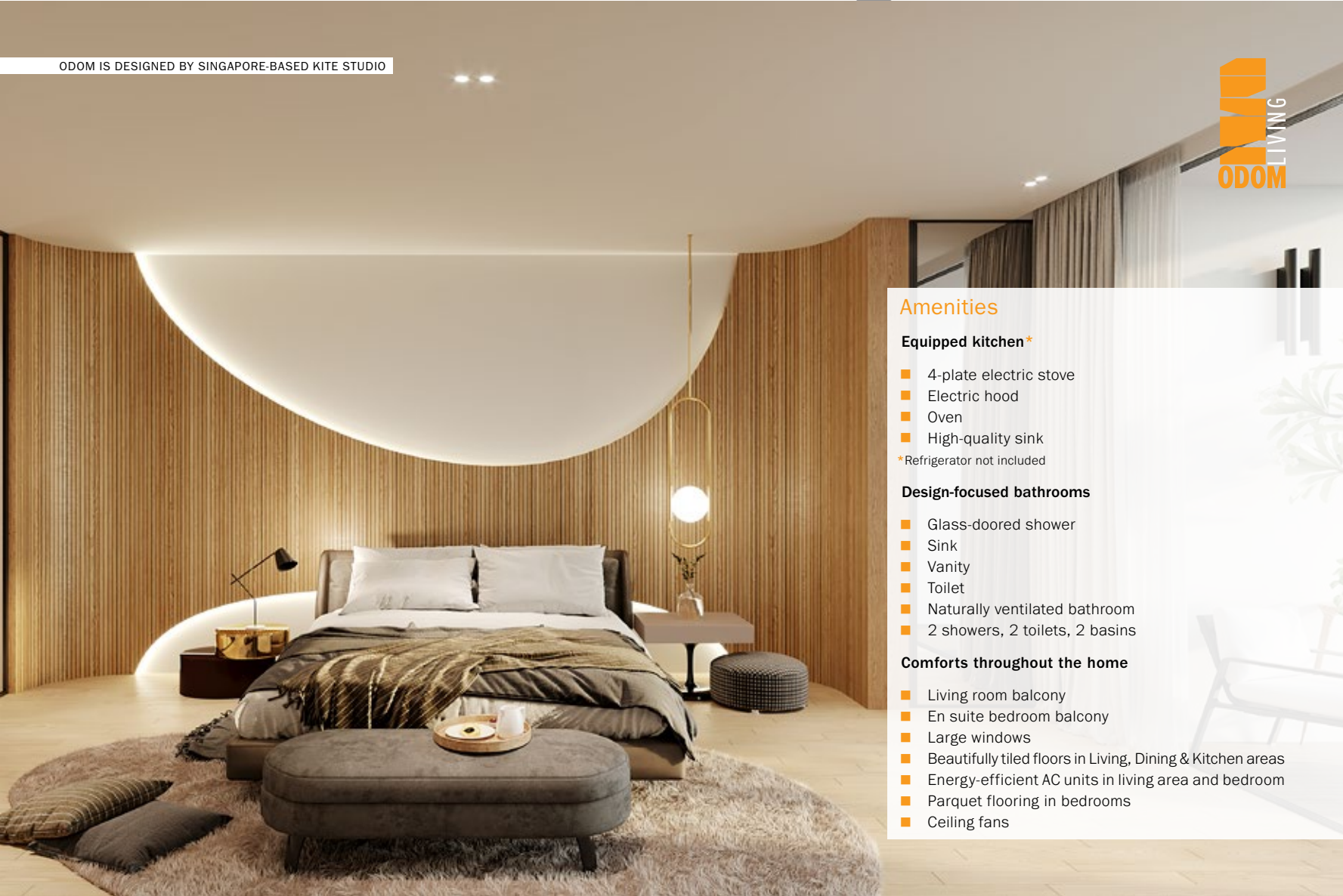

Amenities

Equipped kitchen*

- 4-plate electric stove
- Electric hood
- Oven
- High-quality sink

*Refrigerator not included

Design-focused bathrooms

- Glass-doored shower
- Sink
- Vanity
- Toilet
- Naturally ventilated bathroom
- 2 showers, 2 toilets, 2 basins

Comforts throughout the home

- Living room balcony
- En suite bedroom balcony
- Large windows
- Beautifully tiled floors in Living, Dining & Kitchen areas
- Energy-efficient AC units in living area and bedroom
- Parquet flooring in bedrooms
- Ceiling fans