

# Contents.

**Drawing**  
**PLA237-L01 Contents, Context Plan and Plant Schedule**  
**PLA237-L02 Street Landscape Plan**

## Plant Schedule.

### Street Trees

Code	Botanical Name	Common Name	Planting Size	Quantity
CEN	<i>Corymbia eximia 'nana'</i>	Yellow Bloodwood	16 ltr container	16
UPA	<i>Ulmus parvifolia 'Burnley Select'</i>	Chinese Elm	40-45 ltr container	5

## Typical Tree Planting Detail

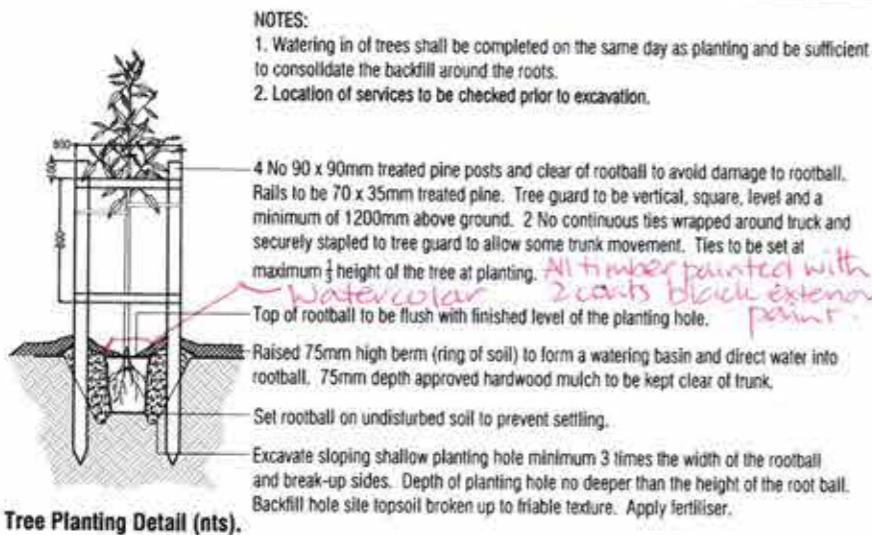

## Stage C4, ViewPoint - Context Plan (nts).

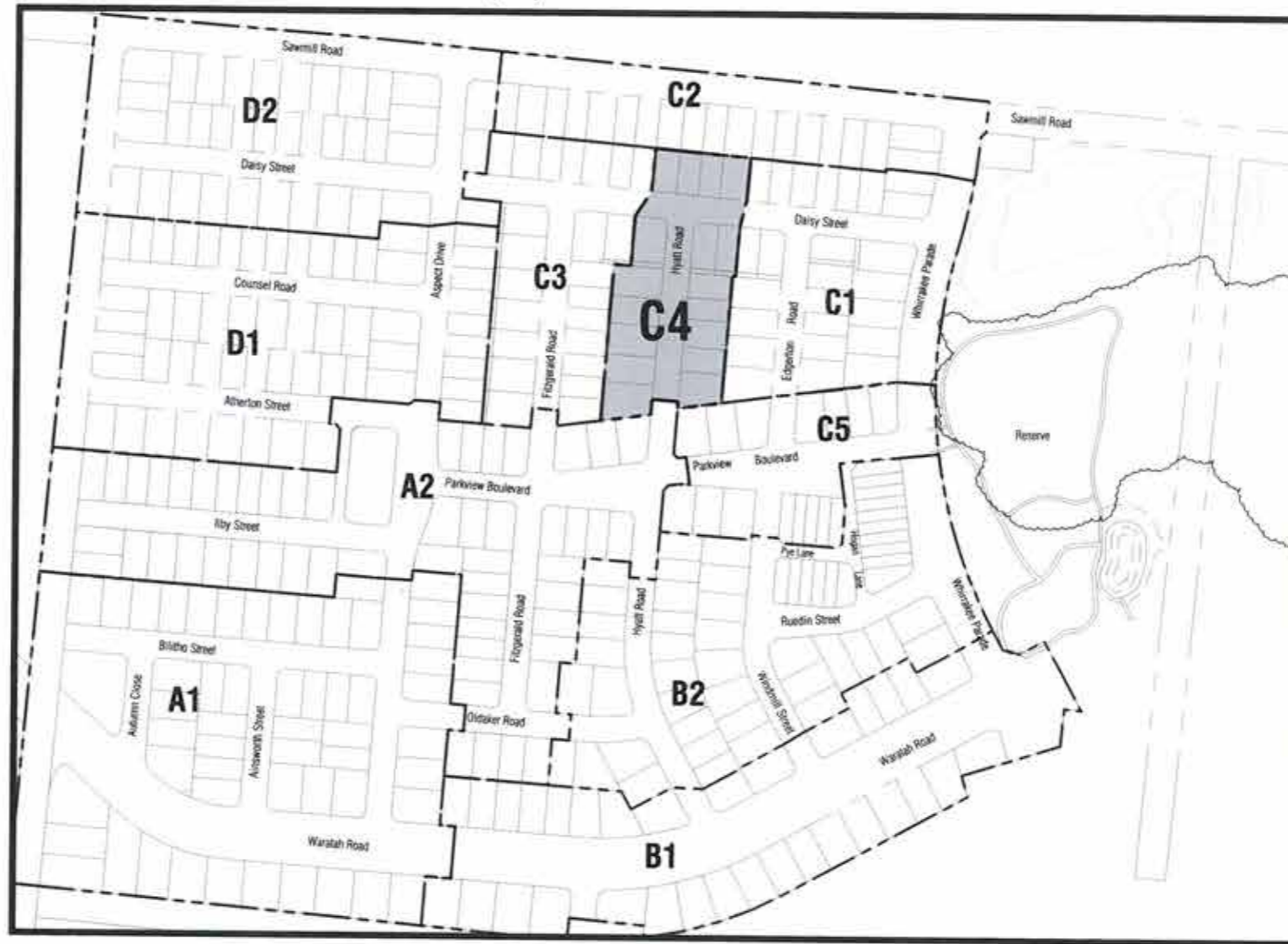

Revision	Description	Issue	Date
TP1	Town Planning Approval	AD	15.08.18
P2	Revisions based on final NBN and Power	AD	15.08.18
P1	Preliminary Issue	AD	12.06.18

**APPROVAL ISSUE**

- Notes**
- PLANNING PERMIT NUMBER: DS/546/2012
1. All dimensions to be checked on site before commencing work. All measurements are in metres, unless otherwise shown.
  2. The locations of underground services and light poles are indicative only - refer to electrical plans for electrical and service offsets.
  3. The location and depth of services shall be verified on site prior to the commencement of works. The Contractor shall be liable for any damage to services during the landscape works.
  4. **Standard Street Tree Offsets.**
    - It is assumed that all Underground Cable in close proximity to the 'tree zone' (5m diameter x 600mm depth) shall be within conduits or have cover slabs to provide a higher level of infrastructure protection. (\*Refer 12.0 Distribution Construction Standard Underground Trenching GA211 by Citypower and Powercor).
    - Minimum setback of 2.0m to service assets including gis and conduit crossings.
    - Minimum setback of 0.75m to domestic service tapping points and 2.0m to stormwater outlets.
    - Minimum setback of 1.0m to footpath crossings and 3.0m to driveways where they are existing or known.
    - Minimum setback of 3.0m to fire hydrants.
    - Minimum setback of 4.0m to light poles.
  5. **Proposed Street Trees.**
    - Where possible, trees are planted to allow a driveway within 7.0m from the Title Boundary.
    - Tree position in front of lots may change slightly due to 'actual' location of services, and constructed driveway crossings.
    - Setback from intersection (kerb) shall be a minimum of 10m.
  6. **Existing Trees.** The Contractor shall confirm and protect any existing vegetation during landscape works.
  7. **Planting.** All trees shall be planted in accordance with typical details, unless otherwise specified.
  8. **Mulch.** Street Tree Mulch shall be recycled hardwood (or similar approved) unless otherwise specified.
  9. **Grass Seeding.** Reseed nature strips and other grassed areas where there has been disturbance due to landscape works with a proprietary hardy mix, unless otherwise specified.



Client: Project

**Integra**

Viewpoint - Stage C4  
 Huntly, Bendigo

Drawing Title

**Contents, Context Plan and Plant Schedule**

Drawn	Approved	Date	Sheet
AD	RH	15.08.18	1 of 2
NTS	NTS	1 of 2	

No drawing and design is protected by copyright © PLOT Landscape Architects Pty Ltd. www.plota.com.au

PLA237-L01 **TP1**

**CITY OF GREATER BENDIGO LANDSCAPE PLANS**  
 17 AUG 2018  
**APPROVED**  
 Signed: *[Signature]*

TP1	Town Planning Approval	AD	15.08.18
P2	Revisions based on final NBN and Power	AD	15.08.18
P1	Preliminary Issue	AD	12.06.18
Prepared	Group/Person	AD	AD

**APPROVAL ISSUE**

- Notes**
- PLANNING PERMIT NUMBER: DS/546/2012
- All dimensions to be checked on site before commencing work. All measurements are in metres, unless otherwise shown.
  - The locations of underground services and light poles are indicative only - refer to electrical plans for electrical and service offsets.
  - The location and depth of services shall be verified on site prior to the commencement of works. The Contractor shall be liable for any damage to services during the landscape works.
  - Standard Street Tree Offsets:
    - It is assumed that all Underground Cable in close proximity to the 'tree zone' (5m diameter x 600mm depth) shall be within conduits or have cover slabs to provide a higher level of infrastructure protection. (\*Refer 12.0 Distribution Construction Standard Underground Trenching GA211 by Citypower and Powercor).
    - Minimum setback of 2.0m to service assets including gas and conduit crossings.
    - Minimum setback of 0.75m to domestic service tapping points and 2.0m to stormwater outlets.
    - Minimum setback of 1.0m to footpath crossings and 3.0m to driveways where they are existing or known.
    - Minimum setback of 3.0m to fire hydrants.
    - Minimum setback of 4.0m to light poles.
  - Proposed Street Trees:
    - Where possible, trees are planted to allow a driveway within 7.0m from the Title Boundary.
    - Tree position in front of lots may change slightly due to 'actual' location of services, and constructed driveway crossings.
    - Setback from intersection (kerb) shall be a minimum of 10m.
  - Existing Trees: The Contractor shall confirm and protect any existing vegetation during landscape works.
  - Planting: All trees shall be planted in accordance with typical details, unless otherwise specified.
  - Mulch: Street Tree Mulch shall be recycled hardwood (or similar approved) unless otherwise specified.
  - Grass Seeding: Reseed nature strips and other grassed areas where there has been disturbance due to landscape works with a proprietary hardy mix, unless otherwise specified.
  - Plant Schedule: Refer to sheet PLA237-L01 for Plant Schedule.

**Legend**

- Trees planted as part of another stage.
- Proposed Street Trees (*Ulmus parvifolia* 'Bumley Select')
- Proposed Street Trees (*Corymbia eximia* nana)
- Alternative tree location if driveway is located where street tree is proposed.
- Service offsets / setbacks
- Plant Label and Code



Client: **Integra**  
 Viewpoint - Stage C4  
 Huntly, Bendigo

Drawing Title: **Street Landscape Plan**

Drawn	Approved	Date	North
AD	RH	15.08.18	

Scale: 1:250 1:500 2 of 2

Drawing Number: **PLA237-L02**      **TP1**

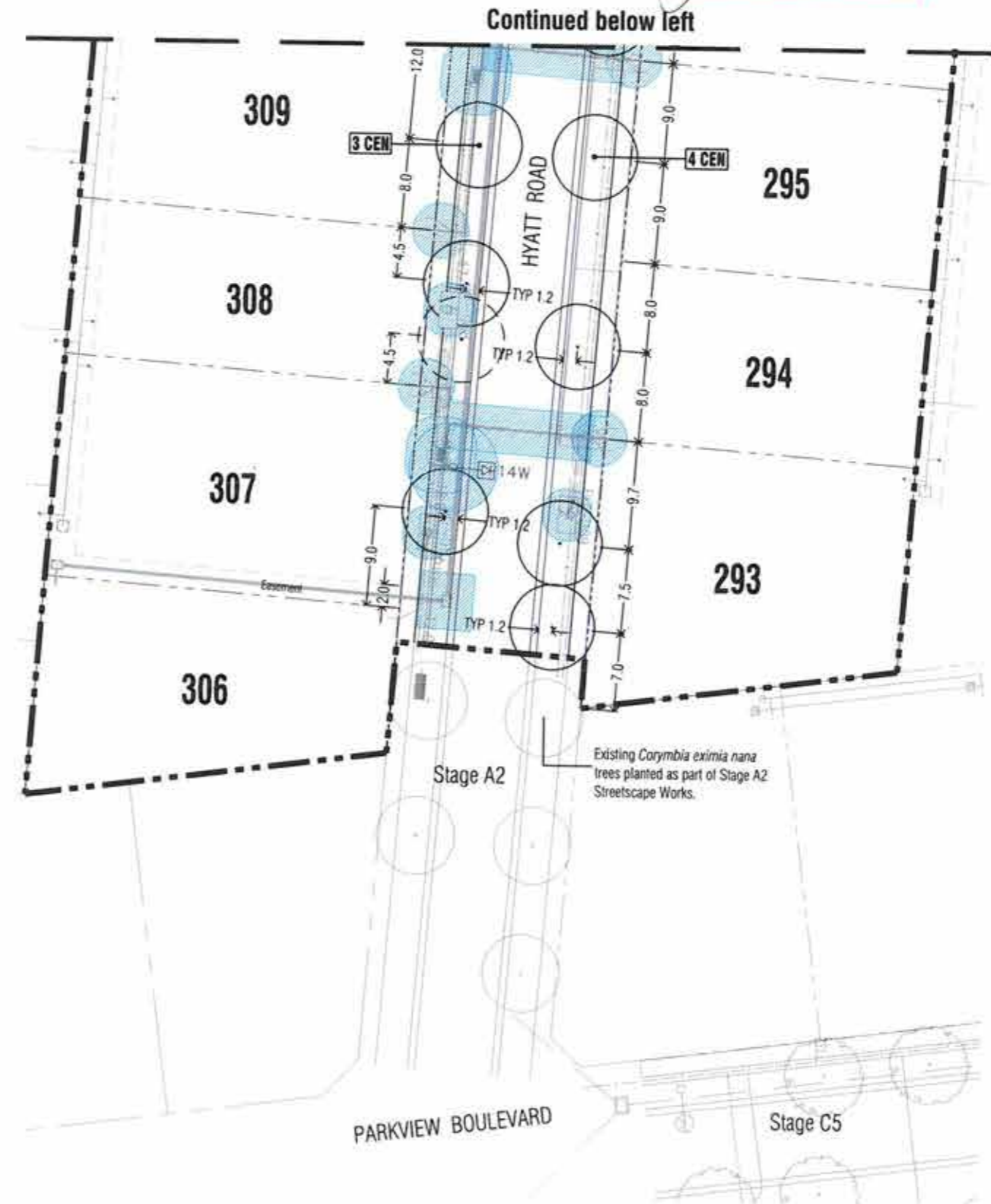
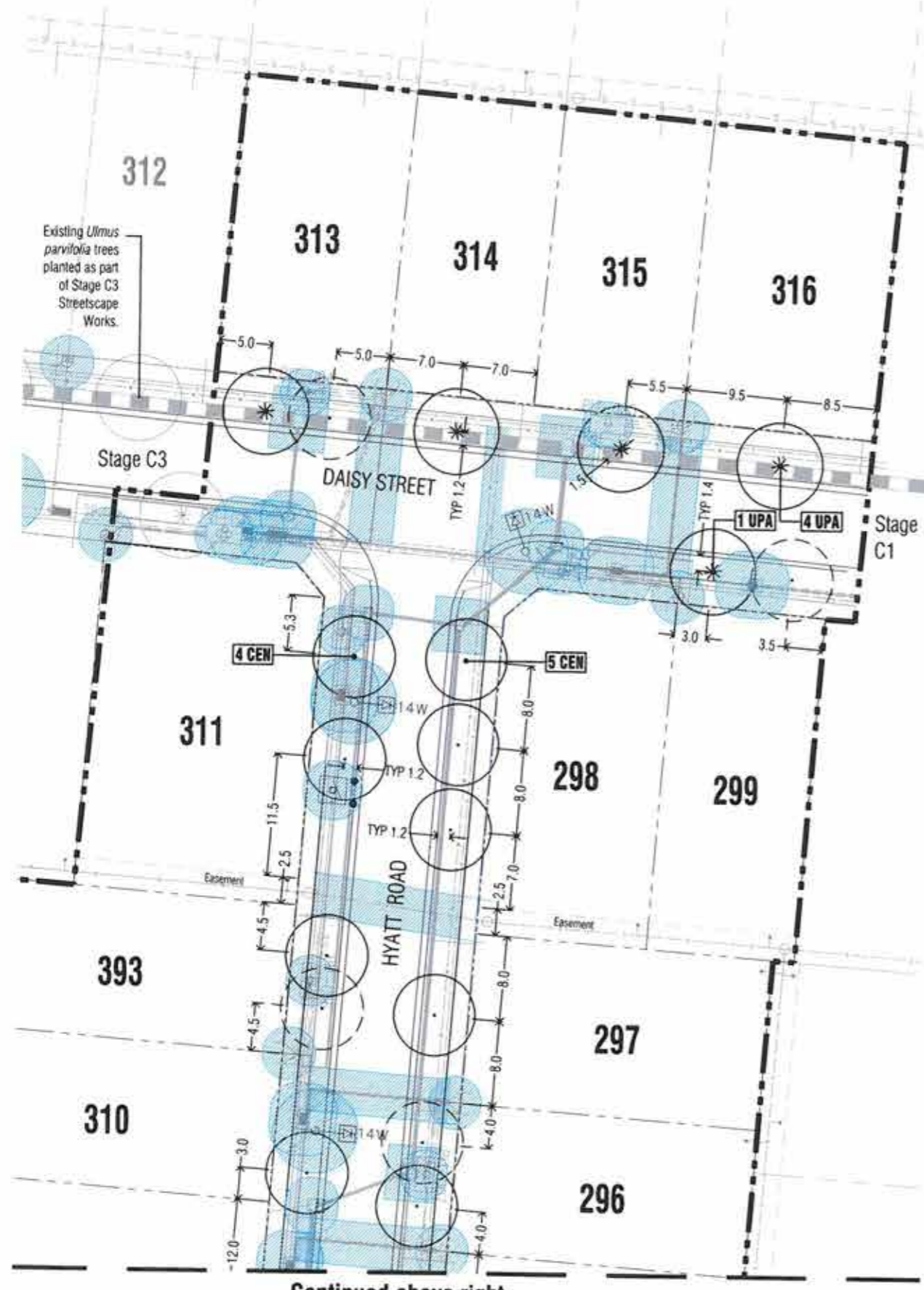

This plan is provided for marketing and information purposes only, it shows design levels only which may change during construction. Builders should check all information prior to the building process. Where discrepancies exist between the plan of subdivision and this plan, the plan of subdivision shall be taken as correct. It is the responsibility of the prospective purchaser to confirm prior to purchase, all lot levels, fill depth and all service locations are correct.