

# PLAN OF SUBDIVISION

EDITION 1

PS 828031X

## LOCATION OF LAND

**PARISH:** HUNTLY  
**TOWNSHIP:** —  
**SECTION:** 22  
**CROWN ALLOTMENT:** 5 (PART)  
**CROWN PORTION:** —  
**TITLE REFERENCE:** VOL. 12153 FOL. 005  
 VOL. 12153 FOL. 006  
 VOL. 12153 FOL. 007  
**LAST PLAN REFERENCE:** PS 828024U (LOT 3E, 4E & 5E)  
**POSTAL ADDRESS:** TUCKERS ROAD  
 (at me of subdivision) HUNTLY, VIC, 3551  
  
**MGA CO-ORDINATES:** E: 263 050 ZONE: 55  
 (of approx centre of land N: 5 938 670 GDA 2020  
 in plan)

COUNCIL NAME: CITY OF GREATER BENDIGO

### PRELIMINARY

THIS PLAN IS SUBJECT TO APPROVAL  
 FROM THE RELEVANT AUTHORITIES.  
 LOT BOUNDARIES, EASEMENTS, RESERVES  
 AND RESTRICTIONS MAY BE AMENDED OR  
 ADDED TO THIS PLAN.

## VESTING OF ROADS AND/OR RESERVES

## NOTATIONS

IDENTIFIER	COUNCIL/BODY/PERSON
ROAD R1 RESERVE No.1	CITY OF GREATER BENDIGO POWERCOR AUSTRALIA LTD

**LOT NUMBERS 1 TO 493 (INCLUSIVE)  
HAVE BEEN OMITTED FROM THIS PLAN.**

### OTHER PURPOSE OF THIS PLAN

**CREATION OF A RESTRICTION AS SHOWN ON SHEET 4.**

## NOTATIONS

**DEPTH LIMITATION: 15.24m**

**SURVEY:**  
This plan is based on survey. (See PS828024U)

**STAGING:**  
This is not a staged subdivision.  
Planning Permit No. DS/662/2018

This survey has been connected to permanent marks No(s). BAGSHOT 17 & 19.  
HUNTLY 15, 16, 26, 73, 76 & XHU16/1.

In Proclaimed Survey Area No. —

### REMOVAL OF EASMENTS

**REMOVAL OF PIPELINES OR ANCILLARY PURPOSES & DRAINAGE  
EASMENTS E-4, E-5, E-6 CREATED ON PS828024U THAT ARE  
CONTAINED WITHIN LOTS 508 TO 514 (INCLUSIVE) ON THI PLAN.**

**REMOVAL OF THAT PART OF DRAINAGE EASMENT E-6 WITHIN LOT  
5E ON PS828024U THAT IS NOT SHOWN ON THIS PLAN.**

### GROUND FOR REMOVAL

**AGREEMENT OF ALL INTERESTED PARTIES  
SUBDIVISION ACT 1988 SECTION 6(1)(k)(iv)**

## EASEMENT INFORMATION

LEGEND: A - Appurtenant Easement E - Encumbering Easement R - Encumbering Easement (Road)

Easement Reference	Purpose	Width (Metres)	Origin	Land Benefited/In Favour Of
E-1 & E-2	PIPELINES OR ANCILLARY PURPOSES	3	PS828024U - SECTION 136 OF THE WATER ACT 1989	COLIBAN REGION WATER CORPORATION
E-2 & E-3	DRAINAGE	SEE DIAG.	PS828024U	CITY OF GREATER BENDIGO
E-4 & E-5	PIPELINES OR ANCILLARY PURPOSES	3	THIS PLAN - SECTION 136 OF THE WATER ACT 1989	COLIBAN REGION WATER CORPORATION
E-5 & E-6	DRAINAGE	SEE DIAG.	THIS PLAN	CITY OF GREATER BENDIGO

**Beveridge Williams**  
 development & environment consultants  
 Ballarat ph : 03 5327 2000  
[www.beveridgewilliams.com.au](http://www.beveridgewilliams.com.au)

SURVEYORS FILE REF: 1702011 - E-4  
 1702011PS - STAGE E4.dwg

ORIGINAL SHEET  
 SIZE: A3

SHEET 1 OF 4

LICENSED SURVEYOR: SIMON JAMES MASON  
 VERSION 02, DATE: 24/02/2020

PS 828031X

ENLARGEMENT 'A'  
SCALE 1:200

ENLARGEMENT 'B'  
SCALE 1:500

ENLARGEMENT 'C'  
SCALE 1:500

ENLARGEMENT 'E'  
SCALE 1:500

M.G.A. 2020  
ZONE 55

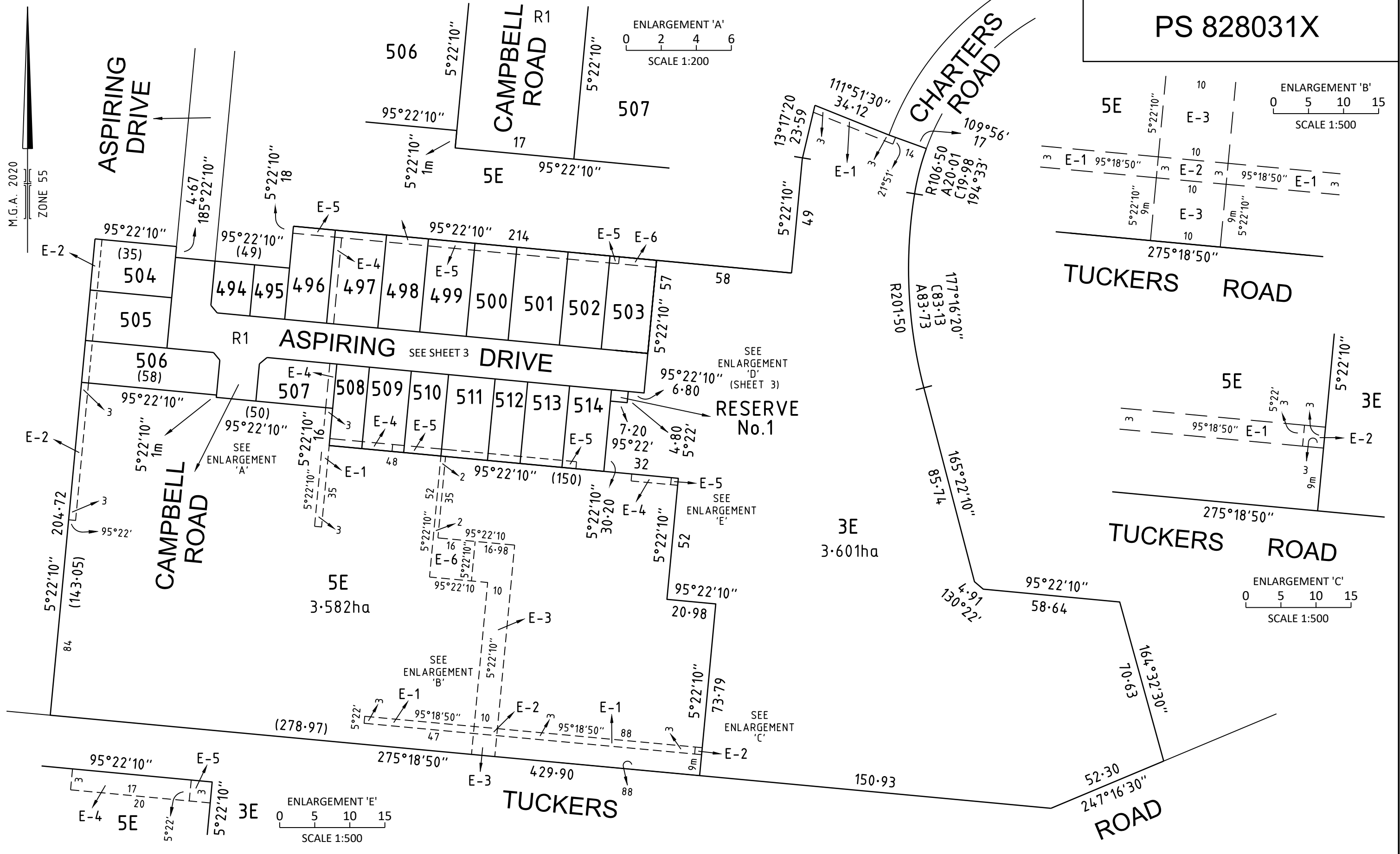

**BW** Beveridge Williams  
development & environment consultants  
Ballarat Ph: 03 5327 2000  
www.beveridgewilliams.com.au

SURVEYORS  
REFERENCE  
1702011  
E-4

**PRELIMINARY**  
SEE NOTATION ON SHEET 1

SCALE  
1 : 1500  
15 0 15 30 45 60  
LENGTHS ARE IN METRES  
LICENSED SURVEYOR: SIMON JAMES MASON  
VERSION 02, DATE: 24/02/2020

ORIGINAL SHEET  
SIZE: A3  
SHEET 2

This plan is provided for marketing and information purposes only, it shows design levels only which may change during construction. Builders should check all information prior to the building process. Where discrepancies exist between the plan of subdivision and this plan, the plan of subdivision shall be taken as correct. It is the responsibility of the prospective purchaser to confirm prior to purchase, all lot levels, fill depth and all service locations are correct.