

Selon PV de référence:
 (EI60) PV 10-A-532
 (EI30) PV 10-A-532 ext. 11-1
 (E30) PV 10-A-532 ext. 16-7

Plan de principe - porte 1 vantail + châssis latéral manchonné

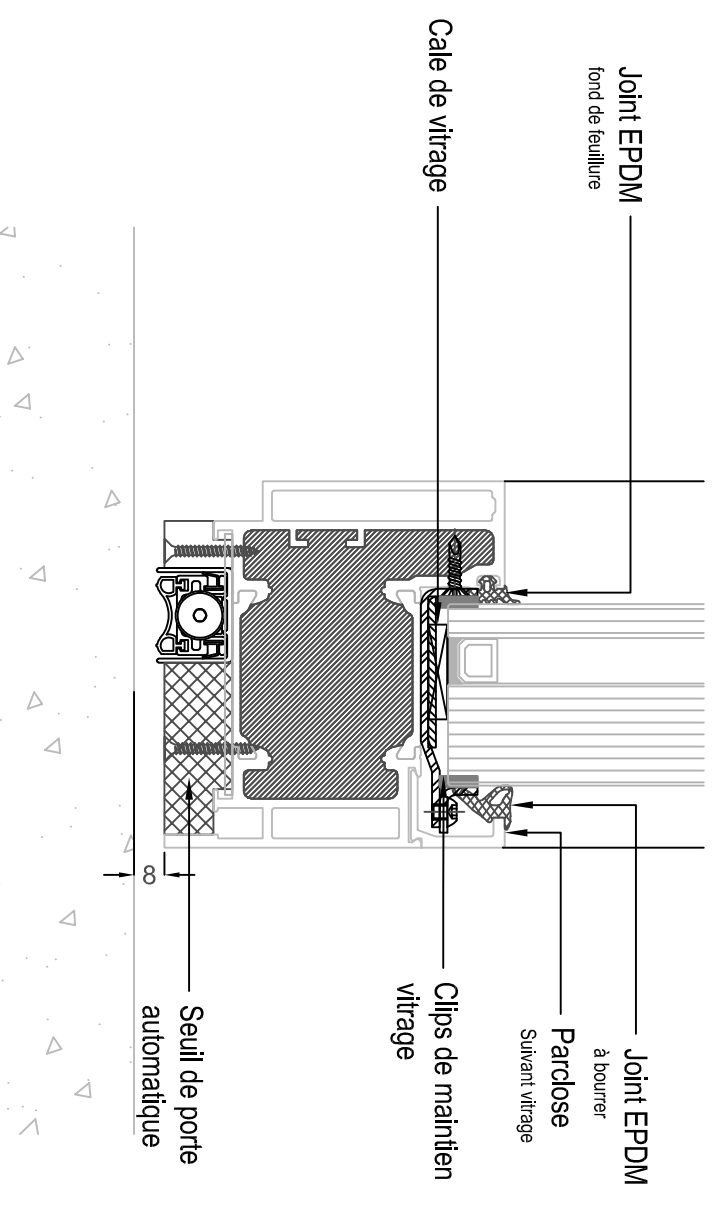

3 rue de la Scheer
 67150 SCHAEFFERSHEIM
 Tél. 03.90.64.86.43
 Fax. 03.88.64.66.04
 Email: contact@svf-france.com
 Site internet: www.svf-france.com

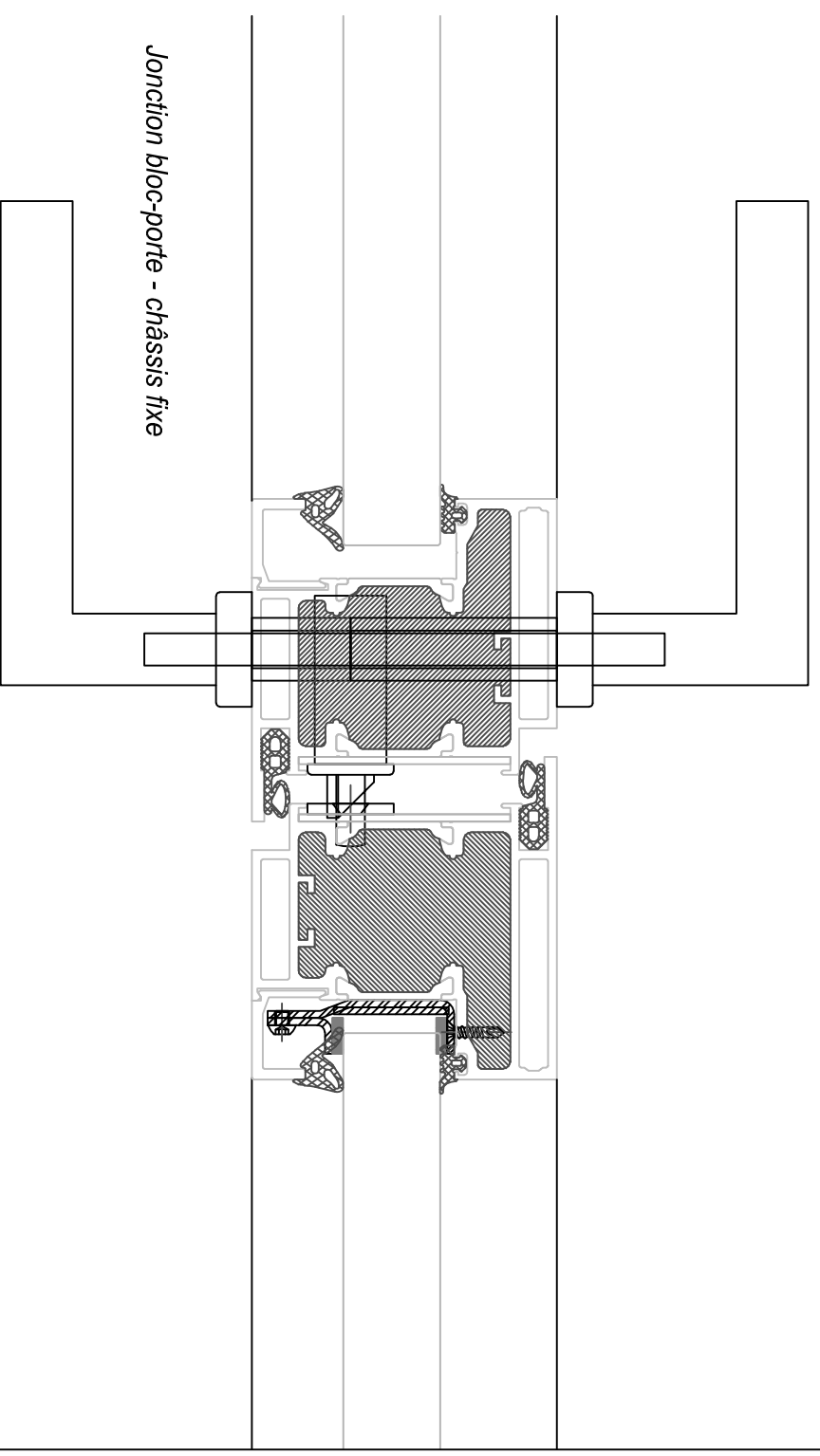
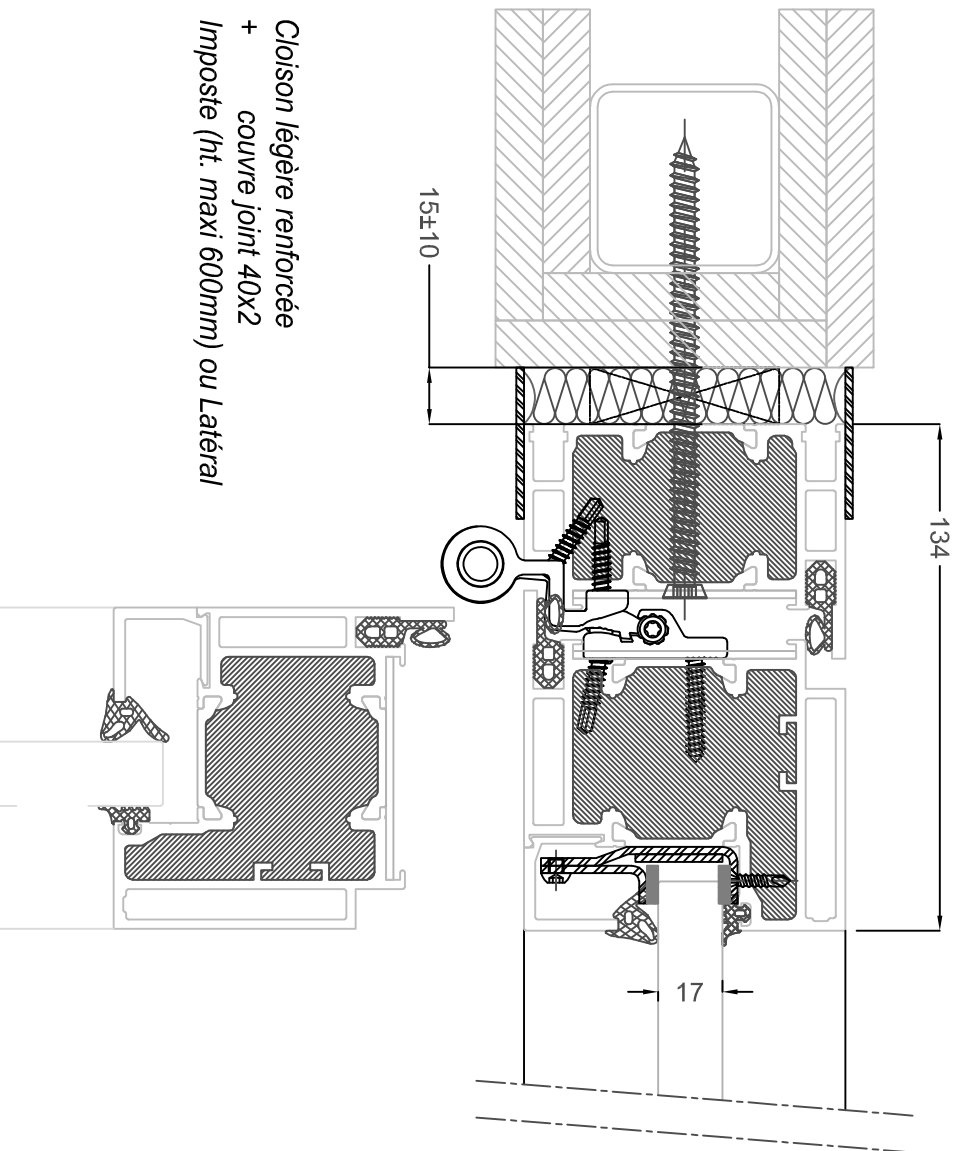
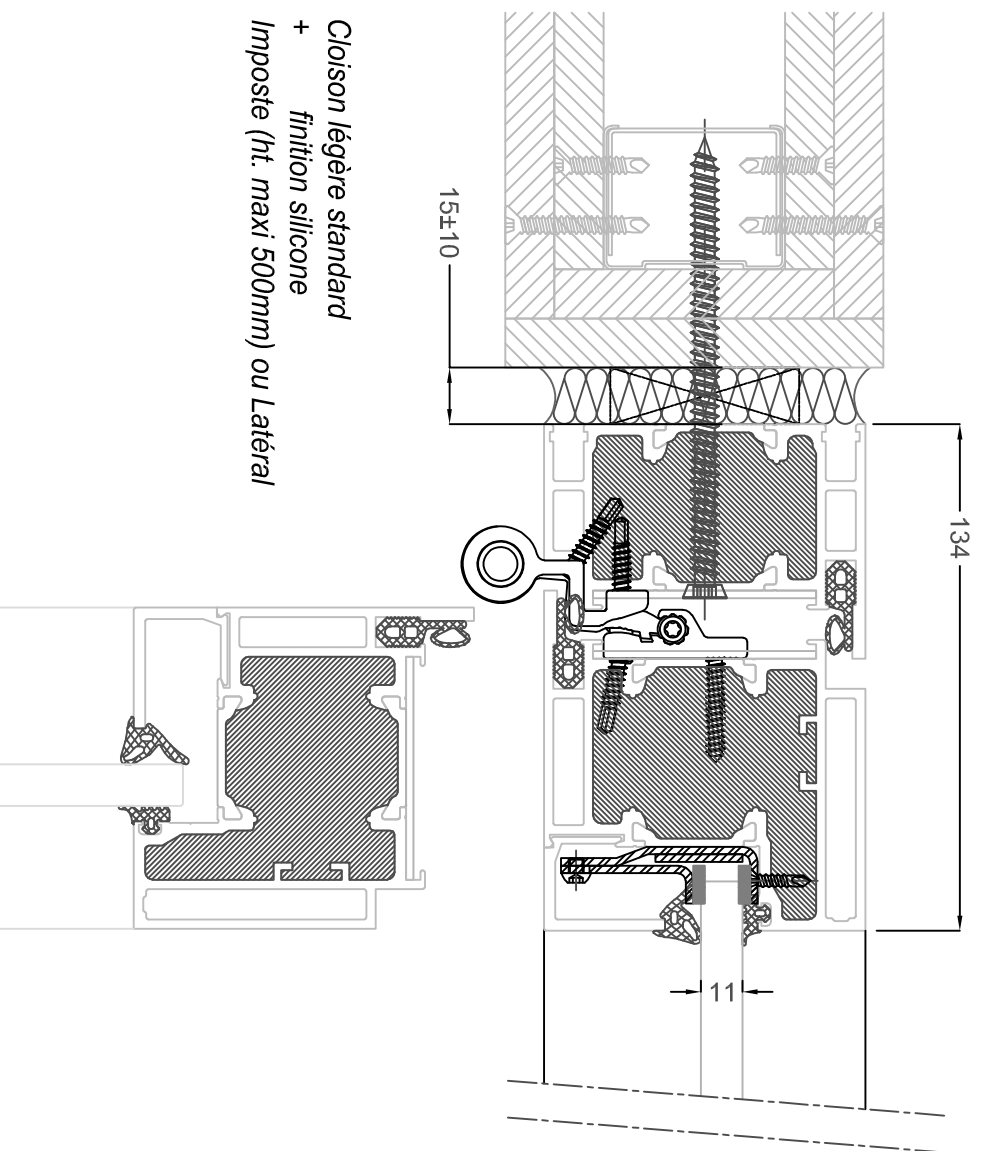

Plan de principe - détails

3 rue de la Scheer
 67150 SCHAEFFERSHEIM
 Tél. 03.90.64.86.43
 Fax. 03.88.64.66.04
 Email: contact@svf-france.com
 Site internet: www.svf-france.com

