

MIDDLE SCHOOL ART CLASSROOM

DESCRIPTION

Middle school art classrooms should be large enough for both small and large group instruction. In these spaces, students learn through hands-on creation and experimentation, working both individually and as a group. The art classroom facilitates flexibility in classroom activity and setup with durable work spaces for students to engage in a variety of artistic activities.

ACTIVITIES

Middle school art classrooms facilitate project-based learning and problem solving through integration of learning and experimentation. Activities might include 2-D and 3-D projects like sculpture, painting, ceramics, and instructor demonstrations.



Elkhorn Middle School - Elkhorn, NE

Space Type:

Middle School Art Classroom

Space Uses:

General Instruction

Grade Level:

6th through 8th

Size:

1,250 square feet

Occupants:

up to 32

Support Spaces:

Storage

Kiln (if required)

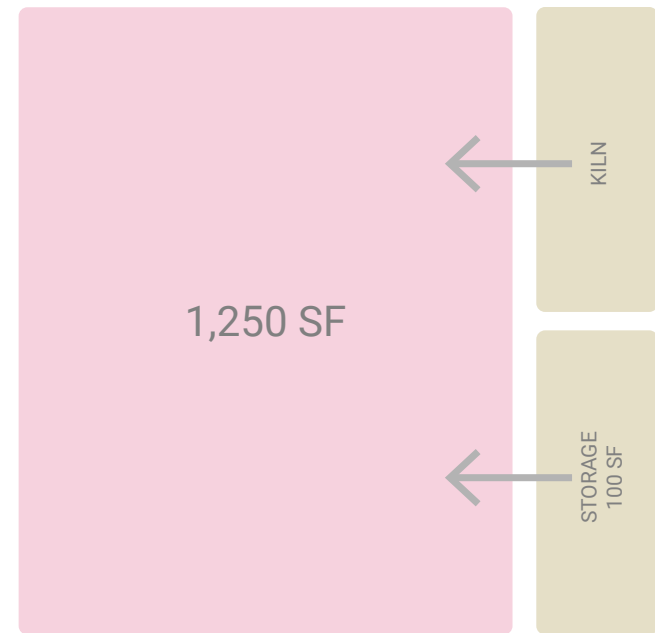

Space Characteristics

- Resilient flooring (concrete acceptable)
- Acoustic ceiling tile
- Tackable wall surfaces (25%)
- Writable wall surfaces (10%)
- Adjacent to storage room for supplies and student projects

Technology

- Telephone/intercom handset, VOIP
- Data outlets for local area network connection
- Wireless connectivity throughout
- Band width for one-to-one ratio
- Interactive large-scale display screen (minimum 84 inches)
- Device charging stations

Special Considerations

- Work tables
- Tall storage (minimum 12 linear feet)
- Base and upper cabinets (minimum of 48 linear feet)
- Acid and heat resistant countertops
- Acoustic considerations for space uses which may be disruptive to adjacent spaces
- Instructor demonstration and prep table

Building Systems

- HVAC connected to district's EMS system
- Room temperature control
- Ventilation
- Large sink (could include more than one if use requires)
- Electrical drops (retractable) if space use requires
- Segregated power connection for iPad/Chromebook charging carts

Sustainability

- Daylighting
- Indirect LED light fixtures
- Installation of Bio Phase-Change Material above ceiling grid
- Low VOC-emitting materials
- Connection to curriculum (visual display, sustainability features labeled, etc.)
- Locally sourced, durable, low (no) maintenance materials