

INSTRUCTIONAL SUPPORT

DESCRIPTION

Instructional Support spaces are intended to act similar to flexible conference rooms. It is the intent that any space of approximately 480 square feet or half the size of a Primary Elementary Classroom can be used for any of these functions and activities.

ACTIVITIES

Instruction Support spaces (approximately 480 square feet) are those enhancing the instructional goals with remedial help to students, instructors or parents. These spaces are for small group instruction, conferences or meetings. These spaces are not directly loaded with an individual instructor and students but occupied as needed to accommodate different group sizes and learning styles.



Kearney Middle School - Kearney, MO

Space Type:

Instructional Space

Space Uses:

Family Liaison, Intervention, Specialized Academic Instruction

Grade Level:

1st through 5th

Size:

480 square feet

Occupants:

Up to 24

Support Spaces:

Storage (if needed)

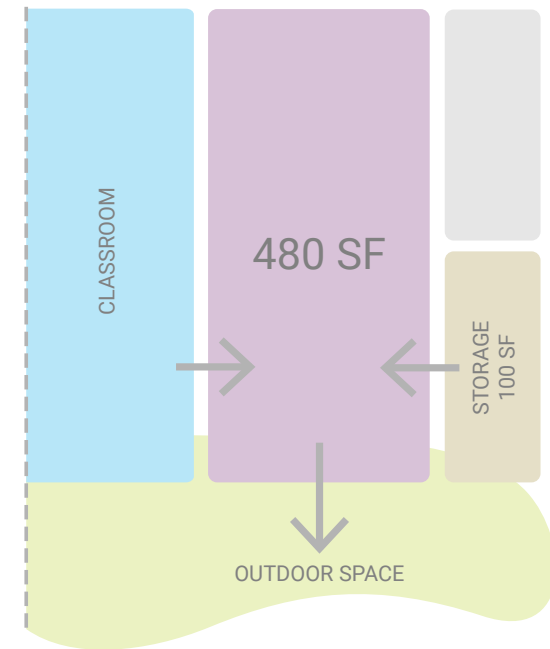

Space Characteristics

- Resilient or carpet flooring
- Acoustic ceiling tile
- Writable wall surfaces (10%)
- Tackable wall surfaces (25%)
- Visual connection to the outdoors
- Tall storage (minimum 12 linear feet)
- Base cabinets (minimum eight linear feet)

Technology

- Telephone/intercom handset, VOIP
- Data outlets for local area network connection
- Wireless connectivity throughout
- Band width for one-to-one ratio
- Interactive large-scale display screen (minimum 84 inches)
- One or more 42-inch monitors (minimum)
- Device charging stations

Special Considerations

- Flexible furniture - grade level appropriate
- Portable technology
- Acoustic considerations for space uses which may be disruptive to adjacent spaces

Building Systems

- HVAC connected to district's EMS system
- Room temperature control
- Segregated power connection for iPad/Chromebook charging carts

Sustainability

- Daylighting
- Indirect LED light fixtures
- Installation of Bio Phase-Change Material above ceiling grid
- Connection to curriculum (visual display, sustainability features labeled, etc.)
- Low VOC-emitting materials
- Locally sourced, durable, low (no) maintenance materials