

# COLLABORATION SPACE

## DESCRIPTION

These types of teaching spaces, while occupying a traditional-sized classroom, provide students with interactive, project-based learning activities. These activities require more flexibility in how the spaces are used than a traditional classroom environment. Many of the activities that are currently offered (and those for future options) would benefit from access to an outdoor learning environment to increase the range of activities and enlarge the available teaching space.

## ACTIVITIES

Collaboration Spaces are learning spaces that are not occupied with directly loaded instructor/student ratio. These are enrichment courses that are attended by students assigned to a classroom instructor. Different combinations of enrichment courses are offered at each elementary school campus. These spaces can often be shared with other programs, such as an After-School Program. To ensure that equipment and specialty items are secured when the spaces are shared, a lockable storage room or cabinets are included.



Alexander Grahm Bell Elementary School - Kirkland, WA

**Space Type:**

Collaboration Space

**Space Uses:**

Maker Space, Video Production, Science, Robotics, Art, Band, Physical Education, After-School Program, Adaptive Physical Education

**Grade Level:**

1st through 5th

**Size:**

960 square feet

**Occupants:**

25 (Grades 1st through 3rd)  
30 (Grades 4th and 5th)

**Support Spaces:**

Storage  
Outdoor Learning

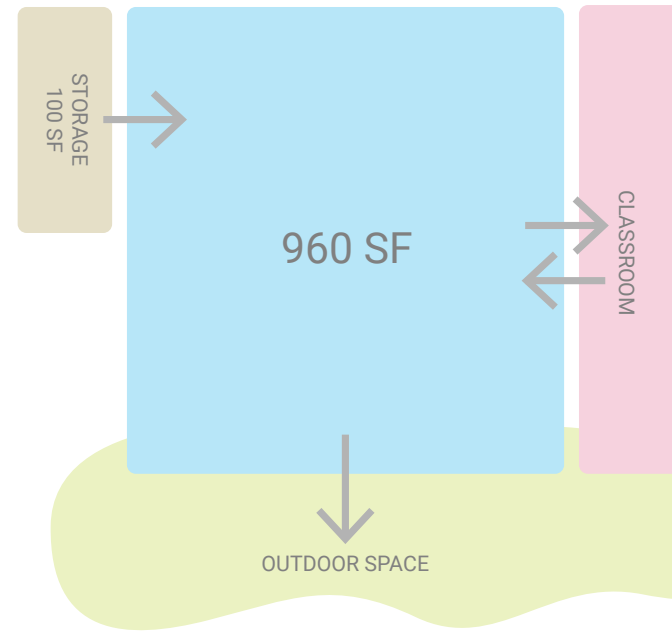

**Space Characteristics**

- Resilient flooring (concrete acceptable)
- Acoustic ceiling tile
- Tackable wall surfaces (25%)
- Writable wall surfaces (25%)
- Visual connection to the outdoors
- Tall storage (minimum 12 linear feet)
- Base cabinets (minimum eight linear feet)

**Technology**

- Telephone/intercom handset, VOIP
- Data outlets for local area network connection
- Wireless connectivity throughout
- Band width for one-to-one ratio
- Interactive large-scale display screen (minimum 84 inches)
- One or more 42-inch monitors (minimum)
- Device charging stations

**Special Considerations**

- Flexible furniture - grade level appropriate
- Portable technology
- Acoustic considerations for space uses which may be disruptive to adjacent spaces

**Building Systems**

- HVAC connected to district's EMS system
- Room temperature control
- Electrical drops (retractable) if space use requires
- Segregated power connection for iPad/Chromebook charging carts

**Sustainability**

- Daylighting
- Indirect LED light fixtures
- Installation of Bio Phase-Change Material above ceiling grid
- Connection to curriculum (visual display, sustainability features labeled, etc.)
- Low VOC-emitting materials
- Locally sourced, durable, low (no) maintenance materials