

Part Number: 3PD0932

Specifications	
Part Number	3PD0932
Cell Chemistry	Lithium Thionyl Chloride (Li/SOCl ₂)
Open Circuit Voltage (25°C)	7.8 V
Capacity	64 Ah
Cell Fuse	3 A
Operating Temperature	- 40°C to + 85°C
Diameter	47 mm (1.85 in)
Length	332mm (13.07 in)
Weight	1.1 kg (2.42 lb)

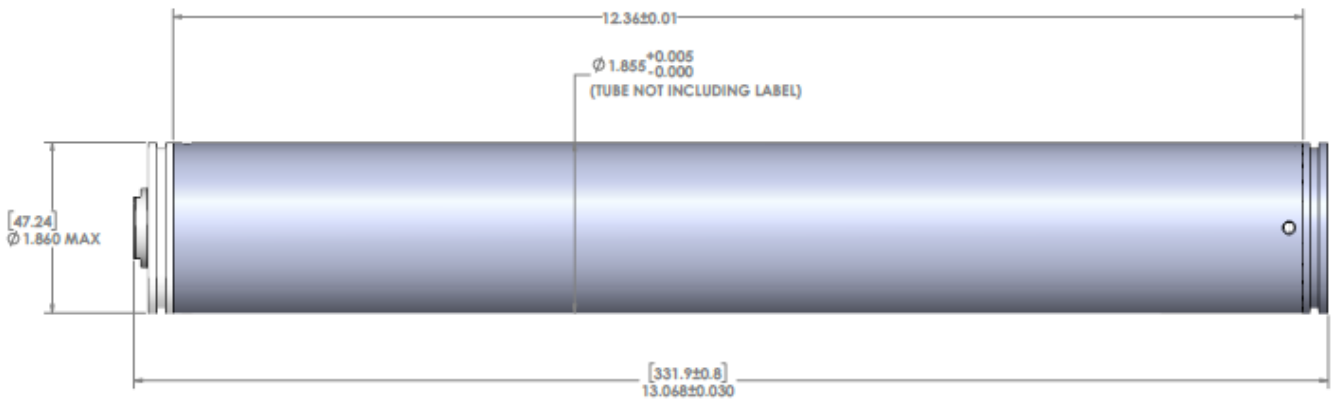

CONNECTOR RED IDENTIFICATION DOT



RED IDENTIFICATION DOT

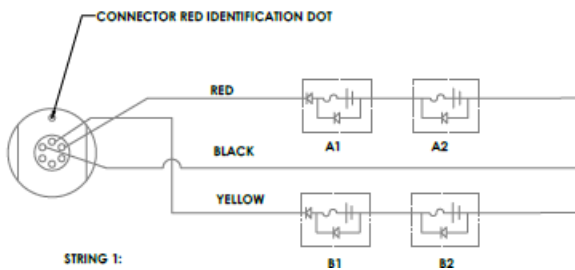
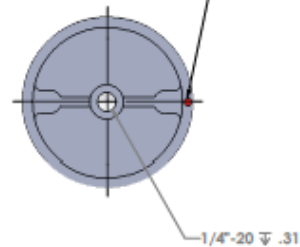

NOTES:

1. WEIGHT = 2.2 TO 2.4 LBS
2. CELLS ARE BCX SUPER-D (3B4700) WITH LOW MAGNETIC SIGNATURE
3. CAPACITY 64 Ahrs
4. LITHIUM CONTENT = 41 GRAMS