

JUST A GENTLE TOUCH...



REMOTE CONTROL



SILENT TOUCH

OFFICE AUTOMATION



HOTEL AUTOMATION



HOME AUTOMATION



PRODUCT INFORMATION

The Forest Shuttle motorized system is available in three types, Shuttle M, Shuttle L and Shuttle S. All three motors offer these functions:

- Touch Impulse Technology, gently pulling the curtain by hand will activate the motor (standard feature);
- Integrated Emergency Control with automatic de-clutch in case of power failure, to ensure a manual operation of the curtains (standard feature);
- Modular motor, different modules can be attached for various control options: Radio Frequency, Wall Switch, Infrared, Domotics, Building/Hotel Automation, Serial Communication, Z-wave, etc.;
- Ultra Silent motor;
- Slow start and slow stop;
- Full automatic setting of the limits;
- Programming of intermediate positions possible;
- Touch Impulse Sensitivity adjustable; high sensitivity, low sensitivity, and off;
- Stack-back position programmable to every desired setting;
- FMS track and components available in white and black;
- Clickable off-set carriers for a straight heading of the curtain; rolling carriers and FES Easyfold carriers also available;
- Kevlar based drive belt;
- All KS brackets applicable;
- Motors can also be used on MRS Motorized Rod System;
- Tandem motor application possible as well.



BOTTOM VIEW
FOREST SHUTTLE



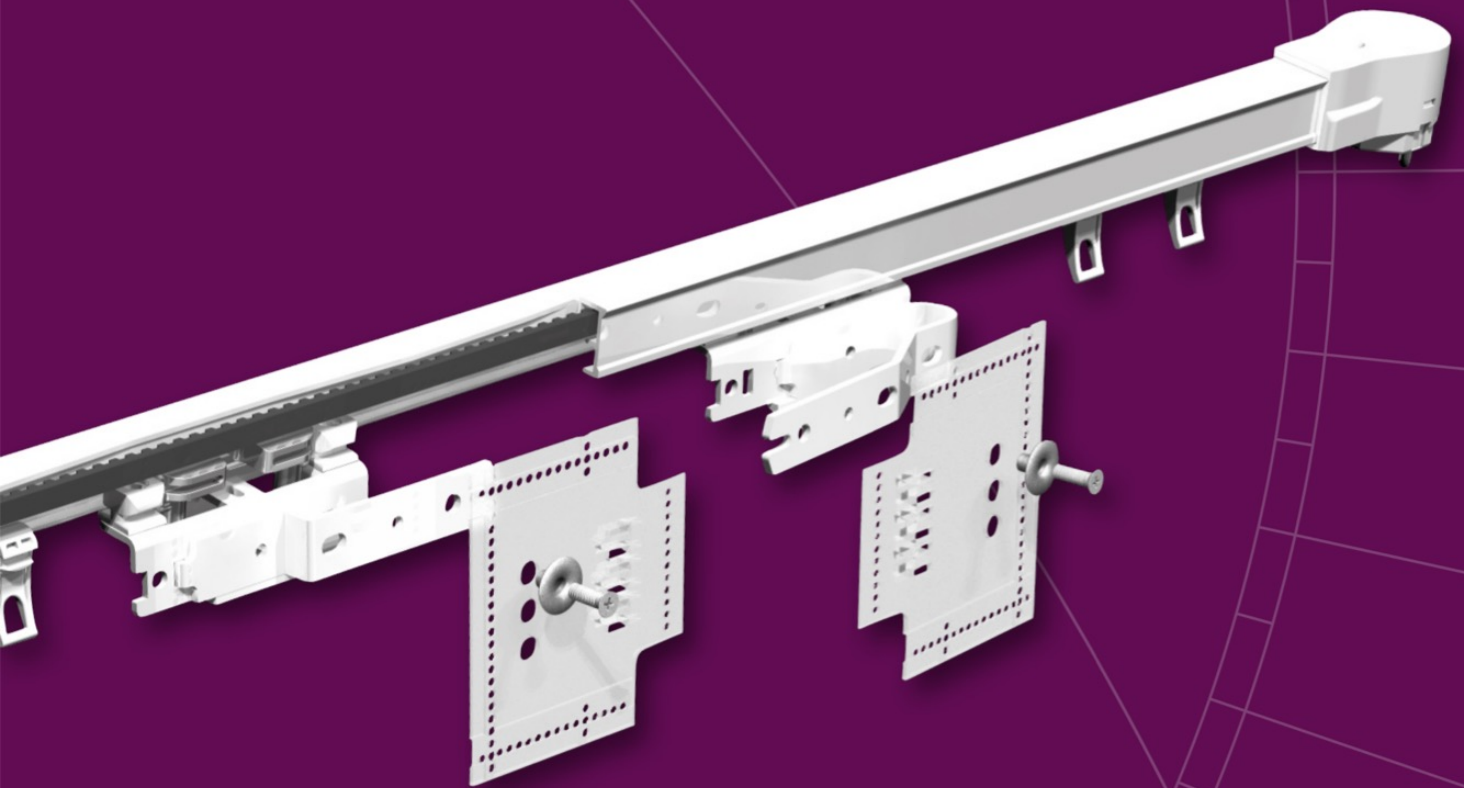

SPECIFICATIONS TRACK

- FMS Track:
- Weight 303 gr /mtr (3,25 ounce/ft.)
 - Aluminium Extrusion
 - Size 20 x 20 mm (0.8 x 0.8 inch)

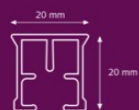

- FMS Plus:
- Weight 500 gr/mtr. (5,36 ounce/ft.)
 - Aluminium Extrusion
 - Size 19,6x30 mm (0.8x1.2 Inch)



BENDING / CURVING

The motor can be used in a track with one or two bends of 90 degrees. The track can be bended and reversed bended with a radius of 20 cm (8"). Continuous curving can be done with the Electric Powered Bender.

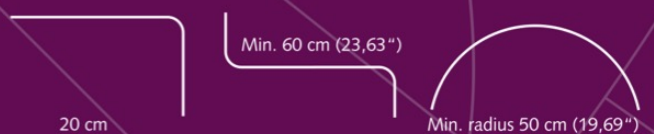

CONTROL OPTIONS

BUILDING AUTOMATION



Designed for use in any building automation system through the integrated dry contact port in the motor. 230V direct control is possible with the optional Dry Contact Relay. The BUS ports allow for individual and group controls of the motors.

TOUCH IMPULSE TECHNOLOGY



A gentle pull will activate the curtain thanks to the smart Touch Impulse Technology of the motor. Standard feature.

INTEGRATED EMERGENCY CONTROL



In case of power failure, the curtain can still be moved manually. Standard feature.

MULTI DIAMOND REMOTE CONTROL



Available in white and black, can be used to control all forest motorized window decoration systems. With 6 individually channels or in 1 group.

Z-WAVE DOMOTICA CONTROL



Wireless Domotics communication with data feedback and automatic routing in a mesh-network environment. Open protocol with "Scene Control". Works with the Forest Touch App for IOS and Android devices.

Detailed schedules on how to program the Forest Shuttle are included with the motor and can be found on our website www.forestgroup.com

FOREST PARTNERSHIPS



www.amx.com

In Concert Partner.



www.knx.nl

KNX partner



www.z-wave.com

Z Wave alliance partner



www.crestron.com

I2P partner



www.smart-homes.nl

Smart homes partner

The Forest[®] Shuttle is compatible with many other Building of Automation systems, thanks to its modular construction. A competitive advantage over the motorized drapery systems in the world!

SHUTTLE M LOAD TABLE:

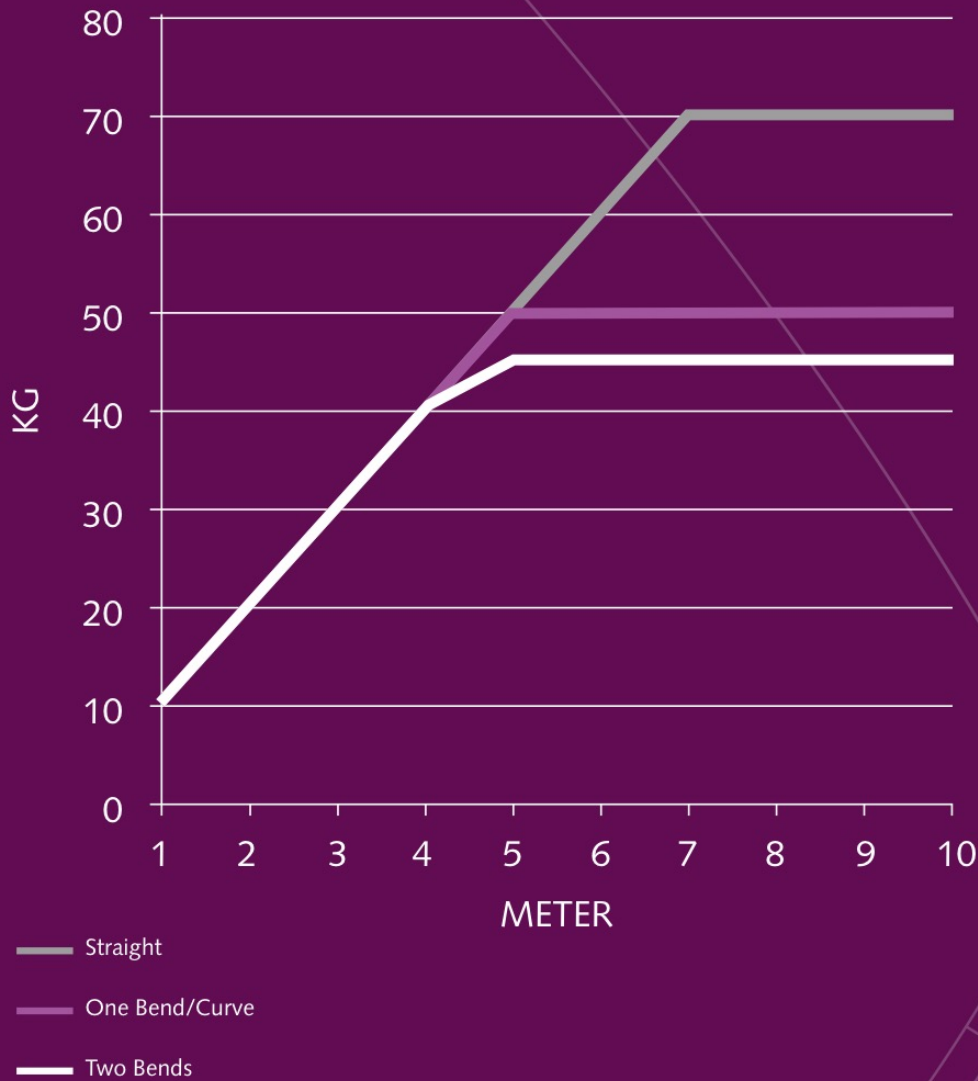

	Shuttle M	Shuttle S	Shuttle L
Voltage Shuttle	24Vdc	24Vdc	100 - 240V~ 50 - 60Hz
RF Multi Receiver	Internal, optional	Internal	Internal
Power Supply	External, 100-240Vac – 1,5A - 50-60Hz; Output 24Vdc - 2,7A	External, 100 - 240Vac - 0,8A - 50 - 60Hz; Output 24Vdc - 2,5A	Internal
Max. power	65W	40W	40W
Torque:	1,5 Nm	1,0 Nm	1,0 Nm
Speed:	15 cm/s	14 – 17cm/s	14 – 17cm/s
Noise Level:	< 40 dB(A)	< 40 dB(A)	< 40 dB(A)
Max. curtain weight	70 kg	40 kg	40 kg
Dimensions Motor:	7 x 5 x 23 cm	7 x 5 x 20 cm	7 x 5 x 28 cm
Dimensions Power Supply	50 x 110 x 30 mm	50 x 80 x 30 mm	-
Protection degree	IP20	IP20	IP20
Max. running time	175 sec (in one direction)	240 sec (in one direction)	240 sec. (in one direction)
Certification & Marking:	CE/FCC	CE/FCC	CE/FCC

SHUTTLE S/L LOAD TABLE:

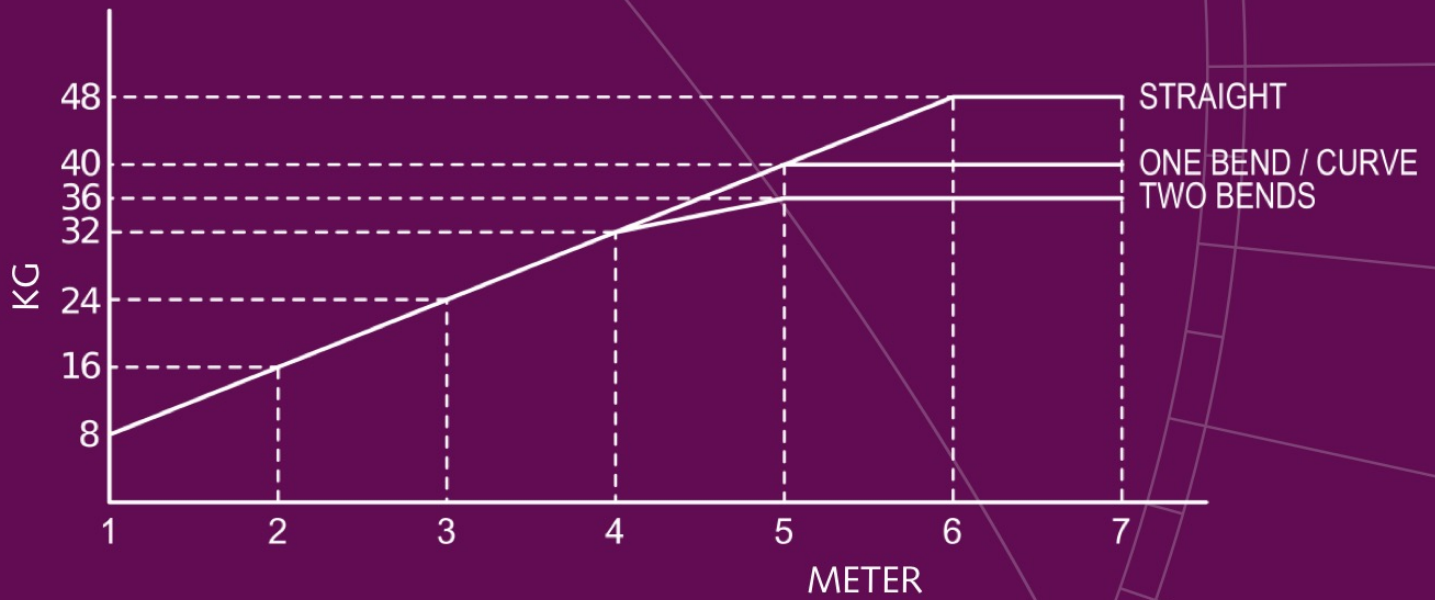

- Straight
- One Bend/Curve
- Two Bends

	Shuttle M	Shuttle S	Shuttle L
Voltage Shuttle	24Vdc	24Vdc	100 - 240V~ 50 - 60Hz
RF Multi Receiver	Internal, optional	Internal	Internal
Power Supply	External, 100-240Vac – 1,5A - 50-60Hz; Output 24Vdc - 2,7A	External, 100 - 240Vac - 0,8A - 50 - 60Hz; Output 24Vdc - 2,5A	Internal
Max. power	65W	40W	40W
Torque:	1,5 Nm	1,0 Nm	1,0 Nm
Speed:	15 cm/s	14 – 17cm/s	14 – 17cm/s
Noise Level:	< 40 dB(A)	< 40 dB(A)	< 40 dB(A)
Max. curtain weight	70 kg	40 kg	40 kg
Dimensions Motor:	7 x 5 x 23 cm	7 x 5 x 20 cm	7 x 5 x 28 cm
Dimensions Power Supply	50 x 110 x 30 mm	50 x 80 x 30 mm	-
Protection degree	IP20	IP20	IP20
Max. running time	175 sec (in one direction)	240 sec (in one direction)	240 sec. (in one direction)
Certification & Marking:	CE/FCC	CE/FCC	CE/FCC

Available in white 01, silver 03 and black 06

FOREST SHUTTLE

FOREST SHUTTLE 'L' 230 VOLT AC



Motor with internal RF Multi Receiver and integrated 24 V power Supply 110 – 240 V. Touch Impulse and Emergency Control as standard.

Dimensions 7 x 5 x 28 cm 1/box
White 5232000001
Black 5232006001
Silver 5232003001
With Z-wave receiver built-in 5232000002

FOREST SHUTTLE 'M' 24 VOLT DC



Strongest motor with standard Touch Impulse System and Emergency Control and with internal RF Multi Receiver.

Dimensions: 7x5x23 cm (2.76x1.97x9.25") 1/box
White 5232000003
Black 5232006003
With Z-wave receiver built-in

FOREST SHUTTLE 'S' 24 VOLT DC



Motor with internal RF Multi Receiver, Touch Impulse and Emergency Control as standard. 24 V Power supply 110 – 240 V to be ordered separately.
Dimensions 7 x 5 x 20 cm 5232000000 1/box

POWER CABLE 4M



EU	white	5201001104
	black	5201006104
UK	White	5201001134

1/box

FOREST AC CONTROL

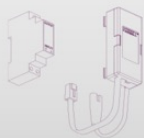

Use the AC control in combination with the Shuttle motor for Live AC (110 Vac or 230 Vac)

Forest shuttle AC control set	5201002202	1/box
Secondary unit - potential free relay	5201002200	1/box

FOREST ADAPTOR

Forest adaptor set complete for Shuttle 'M' 1/box

(EU) incl. wall bracket	5201002002
(UK) incl. wall bracket	5201002004
(UK) incl. wall bracket black	5201006002
(USA) incl. wall bracket	5201002005

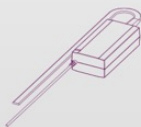

Forest adaptor for Shuttle 'S' excl. plug 1/box

(EU) plug	5201001101
(UK) plug	5201001131
(AUS) plug	5201001141
(USA) plug	5201001121

SHUTTLE MULTI RECEIVER CLICK ON



To be used in case of Z-wave motor that also has to be controlled with Diamond remote control. 5201001362 1/each

FOREST PULSE WALL SWITCH



Dimensions: 6,5 x 5,5 x 2,7 cm (2.56 x 2.17 x 1.06") 5201001900 1/box

MULTI DIAMOND REMOTE CONTROL



5 + 1 channel remote control. 1/each
White 5201091460
Black 5201096460

MULTI WIRELESS WALL SWITCH



2-channel wall switch. 1/each
Dimension: 8,5 x 8,5 x 1 cm.
White 5201001480
Black 5201006480

FOREST MULTI-REMOTE



15 channels incl. timer. 1/each
White 5201001460

SHUTTLE INFRARED MODULE



5201001260 1/box

FOREST Z-WAVE REMOTE CONTROL



7-channel remote control with scene setting options. 5101001700 1/box

SHUTTLE INFRARED REMOTE CONTROL



6 channel infrared remote control. 520100250 1/box

FMS TRACK

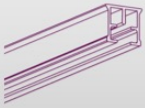

Aluminium extrusion, powder coated black, lubricated. Available lengths:

5,80 m (19')	5101001580
7 m (23')	5101001700
7 m (23'), black	5101006700
7 m (23'), silver	5101003700

FMS SILENT CARRIER



"Clickable", offset, made of UV-resistant plastic. Can be clicked into the track after installation.

White	2510101000-S
Black	2510106000-S
Silver	2510103000-S

FMS/CCS/MRS WHEEL CARRIER



The wheel carrier goes smoothly over a splice.

5210101002
100/box

FMS TRACK JOINER



Used to make a solid connection between two pieces of track.

White	2518401000
Black	2518406000
Silver	2518403000

FMS TRANSPORT BELT

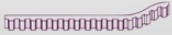

Toothed belt, to be installed inside the FMS Track.

5105501000
100 mtr/roll

FMS MASTERCARRIER UNDERLAP



Multifunctional - arm is reversible for Click on stiffner

15/box

White	5215801010
Black	5215806010
Silver	5215803010

FMS MASTER CARRIER OVERLAP



Multifunctional - arm is reversible for Click on stiffner

15/box

White	5215901010
Black	5215906010
Silver	5215903010

UNDERLAP SINGLE R/L

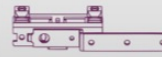

Multifunctional - arm is reversible - will slide trough curves.

15/box

White	3016001000
Black	3016006000

PROLONGED OVERLAP CLICK ON



15 cm long.

15/box

White	95000001010
Black	95000006010

EASYFLEX CURVED ARM



White
Black
Silver

15/box

5135901020
5135906020
5135903020

EASYFLEX MASTER CARRIER LEFT

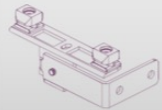

90 degrees left

15/box

4815351090

EASYFLEX MASTER CARRIER RIGHT

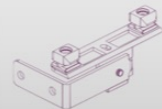

90 degrees right

15/box

4815451090

Z-SHAPED OVERLAP ARMS



Reversible Z-shaped overlap arm. Fits CS, CCS and FMS mastercarriers. For further reducing of light leakage for center closing.

15/box

9500001030

CORD MASTER CARRIER UNDERLAP

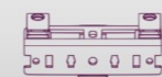

Multifunctional - reversible arm - will go through curves.
Colours: 01, 03

15/box

3015601000

CLICK ON STIFFNER

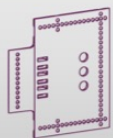

Recommended to attach to the FMS Master Carriers, stiffener to be stitched into the curtain

5116001001
15/box

FMS MOTOR PULLEY



Connects motor with FMS Track.

White 5103011000
Black 5103016000
Silver 5103013000

FMS RETURN PULLEY



Reverses the FMS transport belt in the FMS Track.

White 5103011100
Black 5103016100
Silver 5103013100

FMS MOTOR PULLEY UPSIDE DOWN



Can be used to place the motor upside down on the FMS track.

5103011003
1/box

FMS RETURN PULLEY EASYFLEX



For single-closing curtains.

White 5103011102
Black 5103016102
Silver 5103013102

SMART KLICK WALL BRACKET

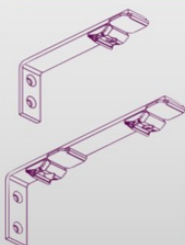

"Klicks" onto track.

10202... mm
10 cm (4"), 12,5 cm (5"), 20/box
15 cm (6"), 20 cm (8"), 15/box
25 cm (10") and 30 cm (12") 10/box
with support.

15 cm (6"), 20 cm (8")
Double track. 10206... mm
For light weight use only. 15/box
Colours: 01, 03, 06.

FMS CONNECTOR

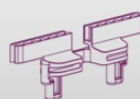

To fix the FMS Master Carrier onto the FMS transport belt.

50/box
White 5103011500
Black 5103016500
Silver 5103013500

SMART KLICK CEILING BRACKET



"Klicks" onto track, powder coated.

100/box
White 1018201000
Included Cover Cap 1018201001
Black 1018206000
Silver 1018203000

COVER FOR SK CEILING BRACKET



Fits on Smart Klick Wall and Ceiling bracket.

10192..000
100/box
Colours: 01, 03, 05, 06.

ALUMINIUM WALL BRACKET

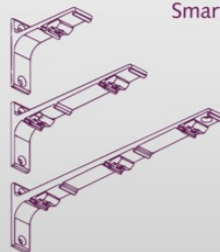

Smart Klick, powder coated.

1020301...
7,5 cm single (3") 20/box
10 cm single (4") 20/box
15 cm double (6") 15/box
20 cm double (8") 15/box
25 cm triple (10") 10/box
Colours: 01, 03, 06.

FSS METAL BRACKET



Strong bracket to fit the Forest Skylight System to the wall or ceiling.

7160001000
100/box

SMART KLICK WALL BRACKET



3,5 cm (1,4") and 6 cm (2,4"). "Klicks" onto track, powder coated. One screw attachment. For light weight use only. Colours: 01, 03, 06.

50/box
10202..035
10202..060

FOREST LUBRICANT



To lubricate components during assembly.

1/box
5109010000

FMS PLUS

FMS PLUS TRACK



Aluminium extrusion
Available length: 7 m (23")
White
Black

5/bundle
5131001700
5131006700

FMS PLUS L-PULLEY



To create a double overlapping
track system in combination
with only one motor.
White

1/box
5133011101

FMS PLUS MOTOR PULLEY

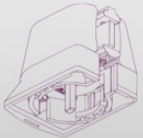

Connects motor with FMS
PLUS track
White
Black

1/box
5133011000
5133016000

FMS PLUS RETURN PULLEY



Reverses the FMS Plus belt in
the FMS Plus Track
White
Black

1/box
5133011100
5133016100

FMS PLUS MOTOR PULLEY UPSIDE DOWN



Can be used to place
the motor upside down
White

1/box
5133011003

FMS PLUS TRANSPORT BELT



Toothed belt to be installed
inside FMS Plus Track

100 mtr/roll
5135501000

FMS PLUS MASTER CARRIER UNDERLAP



Arm is reversible
White
Black

10/box
5135801000
5135806000

FMS PLUS MASTER CARRIER OVERLAP

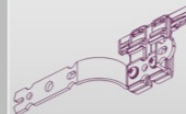

Arm is reversible
White
Black

10/box
5135901000
5135906000

FMS PLUS MASTER CARRIER EASY FLEX L&R

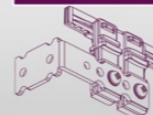

White

10/box
5135901010

ECONOMY CARRIER



Can turn in the track
White
Black

100/box
2510601000
2510606000

FMS PLUS RECESS COVEPLATE UPSIDE DOWN



Coverplate for recess; motor pulley
White 1/box
5133011004

FMS PLUS RECESS PROFILE



Pre-drilled
Combinate with fixing strip
White 7 mtr (23')
5002001701

FMS PLUS RECESS PROFILE FIXING STRIP



Combinate with profile
White 6 mtr (20')
5131001600

FMS PLUS PROFILE WEDGE

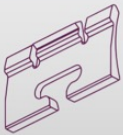

To fix the track into the profile 10/box
5131001100

FMS PLUS / MTS TRACK BRIDGE

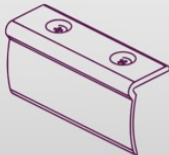

To join two pieces of track;
6,5 cm White 10/box
28 cm White 4518701000
4518601000

FMS PLUS / KS TRACK CONNECTORPIN



Stainless steel, 2 x 20 mm 50/box
For a firm seamless con-
nection 9900000012

FMS PLUS RECESS TRACK



Preshaped 90 degrees curve 1 piece
for FMS plus track 5131011790

FMS PLUS RECESS COVERPLATE



Coverplate for recess; motor
and return pulley 1/box
White 5133011104

ELECTRIC POWERED BENDER



Available in 230V or 115V, to create 1/box
continuous curves and arches. 1060500000
Minimum radius 50 cm (20")

CONTRACT BENDING TOOL



For CS/CCS/FMS/CRS/MTS 1/each
2560000000
CS/CCS/FMS Bending
Wheel Excluding strips 1/each
2561000000
FMS Plus Bending set
Including strips. 1/each
5131000000

THE FOREST FACTOR

Forest Group is a leading developer and manufacturer of high end window treatment solutions. At our headquarters in the Netherlands, innovative and high-quality rails are developed and manufactured.

Two decades of experience, flexibility, innovative and stylish (total) solutions are already appreciated in more than 80 countries by architects, home - entrepreneurs, designers, stylists and retailers. The headquartes and our subsidiaries in the United States of America, China, United Arab Emirates and Poland offer a wide range of services including: bending and assembly of the tracks, marketing support for dealers and retailers, customer service and technical advice.

Whether it's our motorized rails or rods, roller blinds, manual tracks or roman blinds..... Our systems represent the industry's standard due to ongoing innovation and constant focus on the highest quality.

WARRANTY

Whether sophisticated electric curtain systems, decorative channel rod systems or plain tracks, the combination of high end materials and precise manufacturing make it possible for Forest Group to provide a 10 year warranty.



HEADQUARTERS
Forest Group (Nederland) BV
The Netherlands
+31 (0) 570 622850
www.forestgroup.com
info@forestgroup.com



FOREST
DRAPERY HARDWARE