

NOTES:
 FOR PAVEMENT MARKING DETAILS, SEE IDOT DISTRICT 1 DETAIL TC-13.
 ALL STAGE 1 PAVEMENT MARKINGS SHALL BE PAINT, UNLESS OTHERWISE NOTED.
 ALL STAGE 2, STAGE 3, AND STAGE 4 PAVEMENT MARKINGS SHALL BE PAVEMENT MARKING TAPE TYPE III, UNLESS OTHERWISE NOTED.
 * SIGN SHALL BE TAKEN DOWN WHEN WORKERS ARE NOT PRESENT.
 ** PLACE WORK ZONE SPEED LIMIT SIGNING 500' FROM WORK ZONE AND WITHIN 500' DOWNSTREAM OF ALL MAJOR INTERSECTIONS.

TEMPORARY PAVEMENT MARKING LEGEND			
1	LINE 4" (YELLOW SOLID LINE)	10	LINE 12" (WHITE DIAGONAL LINE)
2	LINE 4" (DOUBLE YELLOW SOLID LINES)	11	LINE 12" (YELLOW DIAGONAL LINE)
3	LINE 4" (YELLOW - 10' DASH, 30' SKIP)	12	LINE 24" (WHITE STOP BAR)
4	LINE 4" (WHITE LANE LINE - 10' DASH, 30' SKIP)	13	LETTERS AND SYMBOLS (TYP.)
5	LINE 4" (WHITE SOLID LINE)		
6	LINE 6" (WHITE SOLID LINE)		
7	LINE 6" (WHITE LANE LINE - 2' DASH, 6' SKIP)		
8	LINE 8" (WHITE SOLID LINE)		
9	LINE 12" (WHITE SOLID LINE)		

HRGreen
 HRGreen.com
 1804 Professional Design Firm
 #184-01322

USER NAME : j_mehus	DESIGNED - JCH	REVISED -
FILE NAME : 86148188-shs-most-02-huntley	DRAWN - JCH	REVISED -
PLOT SCALE : 1"=50'	CHECKED - JRM	REVISED -
PLOT DATE : 3/23/2018	DATE : 3/23/18	REVISED -

STATE OF ILLINOIS
DEPARTMENT OF TRANSPORTATION

SUGGESTED MAINTENANCE OF TRAFFIC - STAGE 1
HUNTLEY ROAD/MAIN STREET

SCALE: 1"=50'	SHEET NO. 2 OF 3 SHEETS	STA. TO STA.
---------------	-------------------------	--------------

LEGEND:

- WORK ZONE (HMA PAVEMENT)
- WORK ZONE (ICPC PAVEMENT)
- TEMPORARY PAVEMENT
- DIRECTION OF TRAFFIC
- TEMPORARY CONCRETE BARRIER
- IMPACT ATTENUATORS, TEMPORARY (FULLY REDIRECTIVE, NARROW, TEST LEVEL 2)
- TYPE III BARRICADE
- MAINTENANCE OF TRAFFIC SIGN
- TYPE II BARRICADES OR DRUMS PLACED AT 50' C-C IN TANGENTS, 20' C-C IN TAPERS, AND 10' IN RADIUS

F.A.U. NO. 3887	SECTION NO. 08-0083-00-CH	COUNTY KANE	TOTAL SHEET NO. 259	SHEET NO. 35
FED. ROAD DIST. NO. ILLINOIS FED. AID PROJECT			CONTRACT NO. 61E73	

COMPANY NAME: HRGreen.com
 PROJECT CONTACT: HRGreen.com
 CLIENT: ILLINOIS DEPARTMENT OF TRANSPORTATION
 FILE NAME: 86148188-shs-most-02-huntley
 PLOT DATE: 3/23/2018

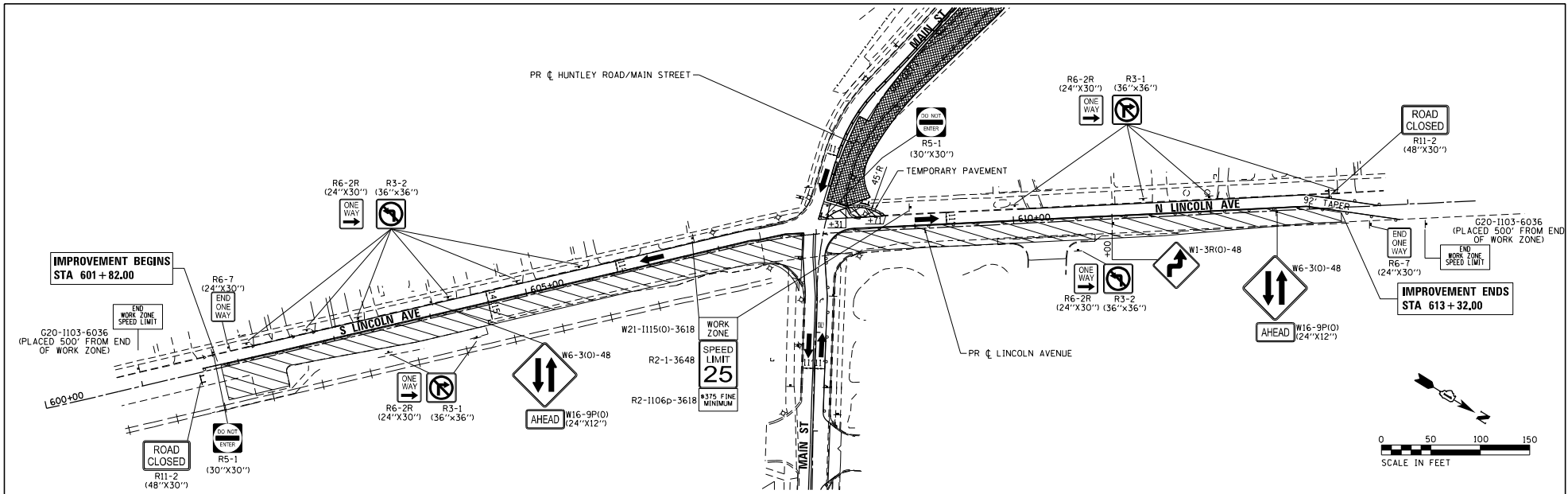

TEMPORARY PAVEMENT MARKING LEGEND			
1	LINE 4" (YELLOW SOLID LINE)	10	LINE 12" (WHITE DIAGONAL LINE)
2	LINE 4" (DOUBLE YELLOW SOLID LINES)	6	LINE 6" (WHITE SOLID LINE)
3	LINE 4" (YELLOW - 10' DASH, 30' SKIP)	7	LINE 6" (WHITE LANE LINE - 2' DASH, 6' SKIP)
4	LINE 4" (WHITE LANE LINE - 10' DASH, 30' SKIP)	8	LINE 8" (WHITE SOLID LINE)
		9	LINE 12" (WHITE SOLID LINE)
		11	LINE 12" (YELLOW DIAGONAL LINE)
		12	LINE 24" (WHITE STOP BAR)
		13	LETTERS AND SYMBOLS (TYP.)

NOTES:
 FOR PAVEMENT MARKING DETAILS, SEE IDOT DISTRICT 1 DETAIL TC-13.
 ALL STAGE 1 PAVEMENT MARKINGS SHALL BE PAINT, UNLESS OTHERWISE NOTED.
 ALL STAGE 2, STAGE 3, AND STAGE 4 PAVEMENT MARKINGS SHALL BE PAVEMENT MARKING TAPE TYPE III, UNLESS OTHERWISE NOTED.
 * SIGN SHALL BE TAKEN DOWN WHEN WORKERS ARE NOT PRESENT.
 ** PLACE WORK ZONE SPEED LIMIT SIGNING 500' FROM WORK ZONE AND WITHIN 500' DOWNSTREAM OF ALL MAJOR INTERSECTIONS.

LEGEND:

	WORK ZONE (HMA PAVEMENT)
	WORK ZONE (PCC PAVEMENT)
	TEMPORARY PAVEMENT
	DIRECTION OF TRAFFIC
	TEMPORARY CONCRETE BARRIER
	IMPACT ATTENUATORS, TEMPORARY (FULLY REDIRECTIVE, NARROW, TEST LEVEL 2)
	TYPE III BARRICADE
	MAINTENANCE OF TRAFFIC SIGN
	TYPE II BARRICADES OR DRUMS PLACED AT 50' C-C IN TANGENTS, 20' C-C IN TAPERS, AND 10' IN RADII.

COMPANY NAME: HRGreen
 PROJECT CONTACT: JAMES HUNTER
 CLIENT: ILLINOIS DEPARTMENT OF TRANSPORTATION
 FILE NAME: 86148188-shs-most-03-lincoln-ave-03-imp.mxd
 PLOT DATE: 3/23/2018



USER NAME: j_hunter	DESIGNED: JCH	REVISED: -
FILE NAME: 86148188-shs-most-03-lincoln-ave-03-imp.mxd	DRAWN: JCH	REVISED: -
PLOT SCALE: 1"=50'	CHECKED: JRM	REVISED: -
PLOT DATE: 3/23/2018	DATE: 3/23/18	REVISED: -

**STATE OF ILLINOIS
 DEPARTMENT OF TRANSPORTATION**

SUGGESTED MAINTENANCE OF TRAFFIC – STAGE 1 LINCOLN AVENUE			
SCALE: 1"=50'	SHEET NO. 3 OF 3 SHEETS	STA.	TO STA.

F.A.U. DIST.	SECTION NO.	COUNTY	TOTAL SHEETS	SHEET NO.
3887	08-00083-00-CH	KANE	259	36
CONTRACT NO. 61E73				
FED. ROAD DIST. NO. ILLINOIS		FED. AID PROJECT		