

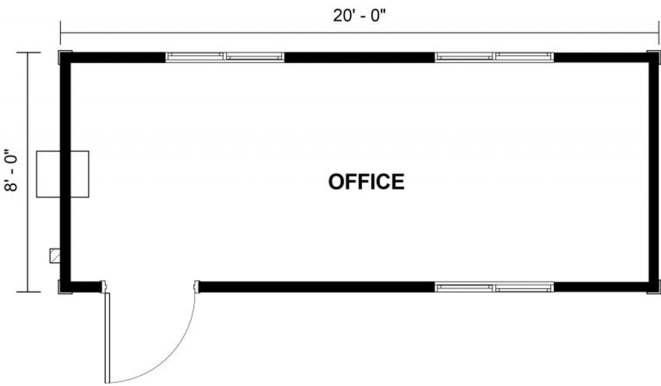

Limited in stock item.  
Built to order.

## SPECIFICATIONS

- 8' x 20' box size
- 160 ft<sup>2</sup> of usable space
- 8' ceiling height
- ADA compliant



## FEATURES

### EXTERIOR

- Insulated steel panel siding
- Forklift pockets & d-rings

### INTERIOR

- Vinyl Composition Tile Flooring
- Insulated steel panel walls

### WINDOWS/DOORS

- Horizontal Slider Windows
- Hollow Core Metal Door

### ELECTRICAL

- Fluorescent Ceiling Lights
- Breaker Panel
- Electrical Outlets

### HEATING/COOLING

- Heat/ Air Conditioning Unit
- Packaged Terminal Heat Pump

### OPTIONAL MODIFICATIONS

- Change Flooring
- Add Security Package