



# VISTA ACME SCREW DRIVE ROD REPLACEMENT GUIDE

3175 Boulevard Choquette, St-Hyacinthe, Québec, Canada Tel: 1-888-773-6708 Fax: 1-450-250-5110 info@atlasacces.com

## REMOVE ACME SCREW ROD

# 1

### TURN OFF THE POWER TO THE VISTA LIFT

- Locate the Disconnect Switch on the side of the Tower.
- Turn the Disconnect Switch to the "OFF" position.

### DISCONNECT THE TOWER'S BATTERY

- Cut the zip ties that secure the battery cables to the Tower's Drive.
- Unhook both the negative(-) and positive(+) cables from the Battery.
- Secure the battery cables away from the battery.

### REMOVE 3/8" HEX BOLTS

- Remove the 4 Hex Bolts (3/8") that fix the Drive to the Drive Mount Plate.
- Keep the 4 Hex Bolts, 4 Washers and the 4 Spacers/ Sleeves in a safe place.

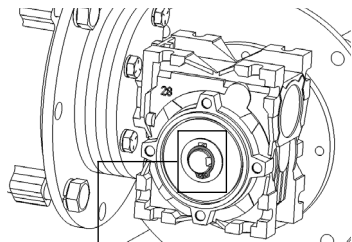

# 2

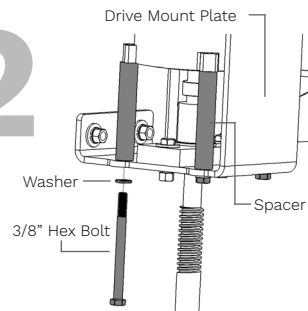

### REMOVE THE DRIVE

- Lift the Drive out.
- Set the Drive in a safe place.

For 90° Drives, ensure to remove the Retaining Ring before removing the Drive.

# 3

### REMOVE TOP COUPLER FROM ACME SCREW ROD

- Loosen the two Set Screws on the top Coupler. Unscrew the Coupler from the Acme Screw Rod. Be sure to keep the 2 Set Screws, Key and Bearing in a safe place.

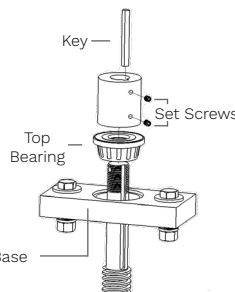

# 4

### REMOVE ACME SCREW ROD

- Loosen the two Bottom Set Screws on the Bottom Locking Bearing located at the bottom of the Acme Screw Rod.
- Unscrew the Acme Screw Rod counter-clockwise from the Bottom Locking Bearing, Brass Safety Nut and the Plastic Acme Nut.
- Lift the Acme Screw Rod and remove from the top of the Drive Mount Plate.

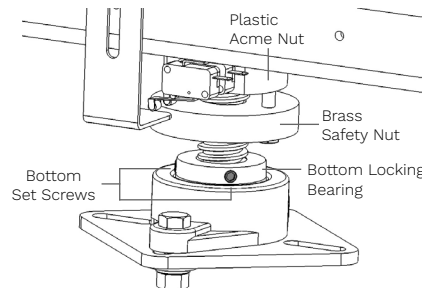

# 5

## INSTALL NEW ACME SCREW ROD

# 6

### MOUNT ACME SCREW ROD

- Place the freshly greased Top Bearing into the Aluminum Base.
- Slide the Acme Screw through the bottom of the Aluminum Base and Bearing.
- While holding the Acme Screw Rod, fasten the Top Coupler all the way down, until the Key Grooves of the Top Coupler and Acme Screw Rod align. (It's ok if you have to "Back Screw" the Top Coupler to align the Key Grooves).

HANDLE THE ACME SCREW ROD WITH CARE. ANY BENDING OR FLEXING WILL RENDER THE ROD UNUSABLE.

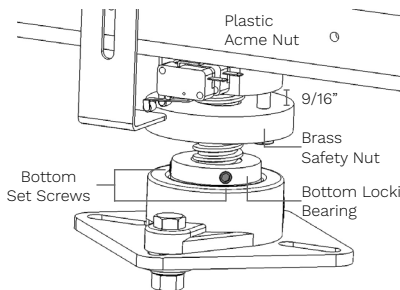

# 7

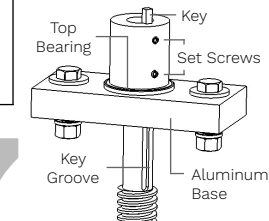

### FASTEN ACME SCREW ROD

- Screw the Acme Screw Rod through the Plastic Acme Nut, Brass Safety Nut and fasten to the Bottom Locking Bearing.
- Ensure the width between the Bottom of the Plastic Acme Nut and the Top of the Brass Safety Nut is 9/16".
- Secure the Acme Screw Rod with the two Bottom Set Screws.

# 8

### REMount THE DRIVE

- Align the Key Groove on the Drive and the Acme Screw Rod.
- Remount the drive back onto the Acme Screw Rod.
- Fasten the Drive to the Drive Mount with the 4 Hex Bolts, 4 Washers and 4 spacers to the Drive.

For 90° Drives, ensure to install the Retaining Ring before proceeding to the next step.

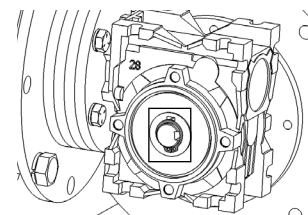

# 9

### CONNECT THE TOWER'S BATTERY AND POWER UP THE LIFT

- Connect the negative(-) and positive(+) cables to the Battery
- Secure the battery cables to the Tower's Drive with zip ties.
- Power up the VISTA lift by switching the Disconnect Switch to the "ON" position.

### BEFORE OPERATION

- Ensure that all the hardware has been tightened to specifications.
- Perform a complete cycle of the VISTA lift to ensure proper operation.
- Record all required details for the service and repair that was performed.
- If you have any questions or concerns please call the Authorized Atlas Dealer.