

# Reconfiguration Plan : MV37 RP 1

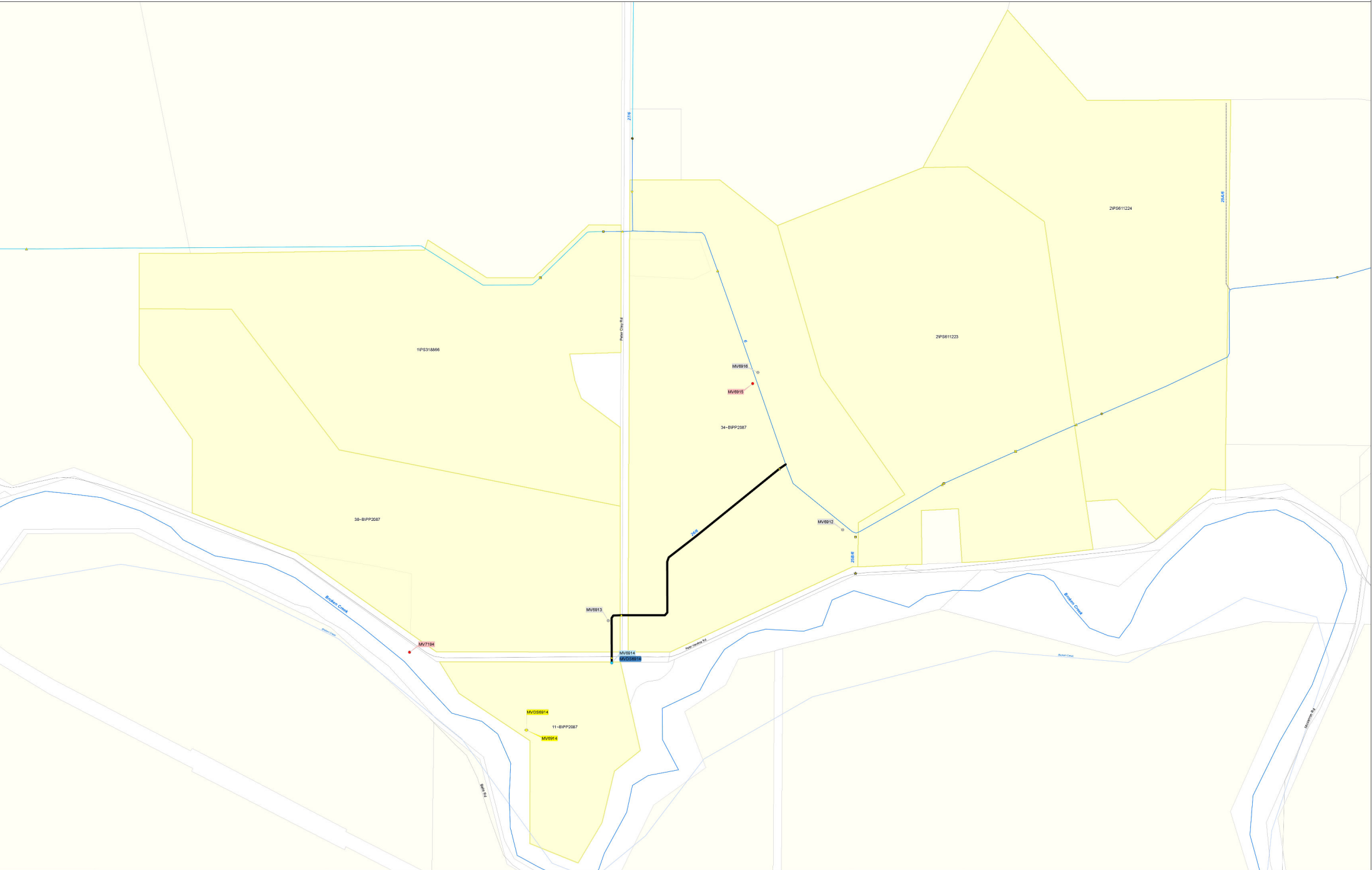

**IR185583**  
19 Jan 2018

**GOLDEN MURRAY WATER**  
40 GAGEY STREET (PO BOX 165)  
TATURA VIC 3616  
Ph (03) 9433 5000 Fax (03) 942 45627  
gmsupport@gmwater.com.au

Service Point Modernisation Action	Channel Modernisation Action	G-MW Irrigation Structures	Electrical Crossing	Offtake	Subway	Channel Network	Transport	Waterway	DCRP Customer Parcels
● Retain	● Retain channel with no modernisation	● Abandoned Structure	● Farm Irrigation Crossing	● Outfall	● Siphon	● Backbone Channel	● Freeway	● Waterway	● DCRP Customer Parcels
■ Relocate	■ Retain channel with reinstatement	◆ Bridge	● Pump	● Pump Station	■ Valve - Isolation	● Non-Backbone Channel	● Highway	● Reservoir	● Other Customer Parcels
● Replace	■ Retain channel with modernisation	▲ Culvert	■ Footbridge	■ Regulator	■ Wall	● Decommissioned Channel	● Major Road	● Lake	● Property/Land Not Serviced
□ Relocative	■ Pipeline	■ Change Inlet	■ Monitoring Station	★ Regulator Combine	■ Decommision channel	● Proposed Pipeline	● Semi-Major Road		
■ Relocation Point							● Minor Road		

SCALE AT A0 1:2,770

The content of this product is provided for information purposes only. No claim is made as to the accuracy or authenticity of the content of this product. In no event will GMW or its agents, contractors and employees be liable for the accuracy of the information contained within this product nor its use of reference placed on it. The information used within this product is provided on the basis that all persons accessing the information undertake responsibility for assessing the relevance and accuracy of its content.