

EnduraMax™

HIGH PERFORMANCE WALL SYSTEM



Acoustics, Energy Efficient & Moisture Management

EnduraMax™ System provides layers of performance.

Pair With:

Artisan Masonry Stone Veneers®, Quik-Brik® & Trenwyth® masonry block.



Every component of the EnduraMax™ High Performance Wall System is specifically engineered to work together, forming a total cladding solution that adds superior energy performance. The complete system offers an insulation value of R9.2 steady state. This extra layer of thermal protection means building owners can benefit from a cladding system that helps meet and exceed today's demanding energy codes.

Features & Benefits

- Complete wall system approach
- Increased energy efficiency
- Moisture management
- Sound reduction for acoustical comfort
- Can be paired with most Oldcastle masonry units
- High end aesthetics available
- Quick installation

A System Approach

EnduraMax consists of three essential elements that combine to deliver unmatched performance & beauty to your project.

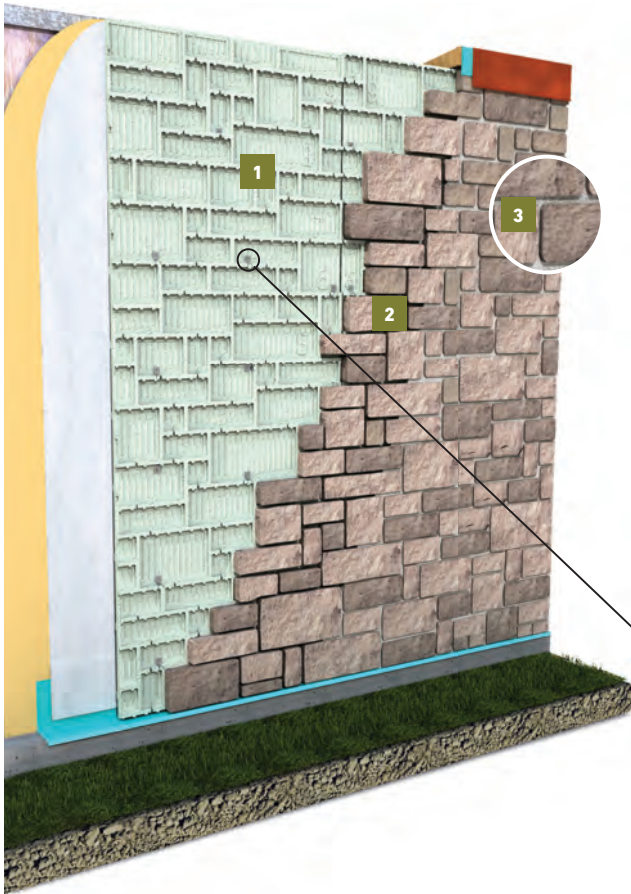

1 Foam Installation Panels

- Polystyrene insulation panels include premolded cells on the outside face, which form the pattern for installing masonry units.
- Drainage channels in the front and back of each panel allow any water that infiltrates the wall to escape.

2 Masonry Units

- Masonry units insert easily into the cells of the foam panels for quick installation
- Stone, clay and concrete brick options offer endless unique aesthetically pleasing designs.

3 EnduraMax Mortar

- A pre-blended, proprietary mortar that complies with ASTM C270 enhances pumpability, bond strength, flexibility and dimensional stability.



Specially designed anchors affix the masonry and mortar solidly to the wood, steel or concrete masonry structure of a building.



Meeting A Higher Standard

EnduraMax's continuous insulation barrier is an ideal way to meet Energy Star's strict energy performance score requirements. Its superior thermal performance will contribute to eligibility for a Designed to Earn the Energy Star (DEES) certification. With the help of EnduraMax, you can truly distinguish a building by being able to meet this prestigious standard for efficiency.



Sound Proofing

The EnduraMax Wall system has an STC rating of 61dB as per testing done in accordance with ASTM E90.



Wind Rating

Depending on building parameters, EnduraMax Wall System can withstand wind speeds of up to 140 MPH. Tested in accordance with ASTM E330.



Moisture Management

As a total cladding solution, EnduraMax integrates all components necessary to achieve superior moisture management. Channels in the front and back of the insulation panels drain any water that may infiltrate the wall, protecting the structure from damage over a long lifetime of moisture exposure.



Fire Resistance

EnduraMax Wall System may be used over any exterior fire resistance rated assembly without changing the assigned hourly rating allowing to meet a 2-hour fire rating. Tested in accordance with ASTM E119. EnduraMax is also NFPA 285 compliant.



Seismic Info

EnduraMax Wall System may be installed in seismic zones A to D. Please refer to the EnduraMax Evaluation Report sections 5.7, 5.8 and 5.9 for specific seismic information.

The EnduraMax Wall System IAPMO Building Evaluation Report is available at EchelonMasonry.com.



Pair EnduraMax™ with the following products, Artisan Masonry Stone Veneers®, Quik-Brik® or Trenwyth® masonry block for a complete system approach to upgrade the performance of your next project.

Exceeding Tomorrow's Codes

As codes continue to move toward tougher building envelope standards, EnduraMax's superior thermal performance enables you to exceed increasingly stringent R-Value requirements, without having to add additional exterior insulation or build larger wall cavities.

EnduraMax may be installed on metal frame or wood frame buildings up to climate zone 6. Zones 7 and 8 may also be addressed by evaluating the building characteristics and installation details.



A Smarter Masonry

A high performance exterior is critical to a building's overall efficiency. The EnduraMax Wall System helps reduce energy loss and may outperform other cladding options, saving energy and operating costs while enhancing interior comfort and exterior aesthetics.



EnduraMax™ Performance Upgrade Options

The EnduraMax Wall System is a performance upgrade option that may be paired with a number of Echelon™ Masonry products to provide the aesthetics desired. Pair EnduraMax with the following Echelon product lines as well as Morency Stone Veneers and Clay Brick.



Artisan Masonry Stone Veneers®

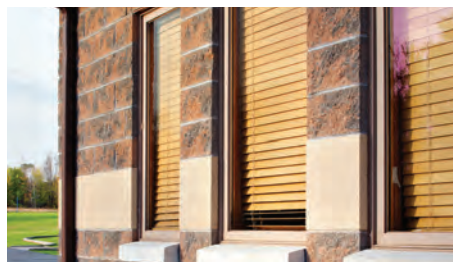

Trenwyth® Masonry Block



Quik-Brik® Masonry Units

*Ask your local architectural rep for more information

EnduraMax™ Morency Stone Colors & Textures

Light Granite

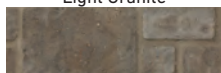

Mossy Grove

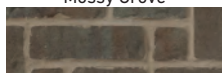

Oldtowne

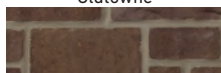

Piedmont

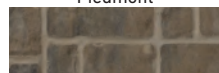

Note: All color samples are representative only. For accurate color selection, ask your sales representative for samples.

Miller Colors & Texture

Brittany Beige



Cottonwood



Hampton

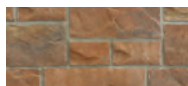

Hill Country

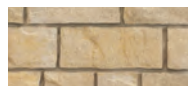

Lennox



Salem



Aspen

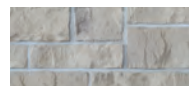

Note: All color samples are representative only. For accurate color selection, ask your sales representative for samples.

Northfield Colors & Texture

Bordeaux

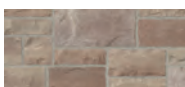

Chesnut

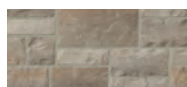

Shelby Blend

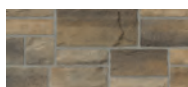

Copper Stone

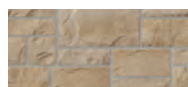

London Gray

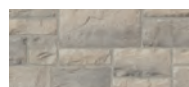

Sunset Beige

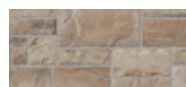

Note: All color samples are representative only. For accurate color selection, ask your sales representative for samples.

EnduraMax™ Clay Brick Colors & Textures

Frosted Pepper



Plum Royale



Spiced Apple



Autumn Oak



Crimson Maple



Note: All color samples are representative only. For accurate color selection, ask your sales representative for samples.