

ClickFix 36 Gold



Focus points:

- White/white trapdoor
- Edge band on trapdoor
- 36 mm insulation
- Casing 115 mm
- Ladder connected to trapdoor
- Ladder 4/4" spruce
- 60 x 120 cm opening
- For frequent use
- Quality lock
- Red handrail included

DOLLE CLICKFIX 36 GOLD



3-SECTION ATTIC LADDER. 120X60 CM

ClickFix® attic ladder with 30 mm insulation = U-value 0,99 W/m² C. ClickFix is a complete line of attic ladders based on the unique patented ClickFix® technology. The entire product range is known by the low u-value and the quick and easy installation. The low weight (approx. 25% less than traditional attic ladders) and the Click system make it possible for only 1 person to mount the ClickFix attic ladders. The insulation and the construction of the trapdoor reduces heat loss. ClickFIX 36 Gold is delivered with non-slip treads for extra security and a wooden push/pull rod for easy operation of the attic ladder.

To reach extra height you can buy Extension kits - please contact Dolle A/S





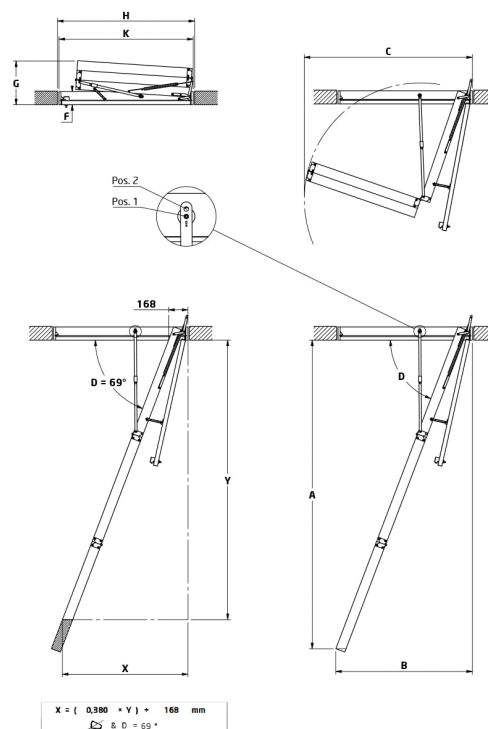

PRODUCTDATA

PRODUCTNAME	Dolle ClickFix 36 Gold
TYPE	3-section
MATERIAL	wood
PRODUCT-NO.	12565
FLOORHEIGHT	Max. 275 cm
HEIGHT WITH EXTRA TREADS	Max. 345 cm
OUTLET IN CM	122 cm
MAX. SWING CLEARANCE CM	151 cm
NUMBER OF TREADS	12
OPENING SIZE	120x60 cm
INSULATION	30 mm
MATERIAL (CASING)	Spruce
THICKNESS (CASING)	18 mm
HEIGHT (CASING)	115 mm
OUTSIDE CASING	117,5x57,6 cm
MATERIAL (TRAPDOOR)	white HDF 2 x 3
INSULATION (TRAPDOOR)	30 mm
THICKNESS (TRAPDOOR)	36 mm
THICKNESS (TREADS)	28 mm
DEPTH (TREADS)	82 mm
WIDTH (TREADS)	400 mm
RISE (TREADS)	250 cm
MATERIAL (TREADS)	Spruce
MATERIAL (STRING)	Spruce
THICKNESS (STRING)	21 mm
DEPTH (STRING)	84 mm
MAX. HEIGHT CLOSED STAIR	38,4 cm
MAX. LENGTH CLOSED STAIR	38,4 cm
MAX. USERWEIGHT	Tested by EN14975 up to 265 kg, work weight 150 kg
CLICKFIX TECHNOLOGY	Yes
U-VALUE	0,99
TEST	DTI EN12207 Class 4 @ 600 Pa

MEASUREMENTS



$$X = (0,380 \cdot Y) + 168 \text{ mm}$$

		Pos.			B	C	D	F	G	Model	H	K
			mm	mm	mm	mm	°	mm	mm		mm x mm	mm x mm
12	4-4-4	1	2590	2731	1194	1499	60	115	385	12565	1200 x 600	1175 x 576
		2	2734	2765	1107	1471	71					

12565_M / 22-05-2014 / Rev 13-10-2015