

# Product datasheet

## HeatMax™ actuator

The HeatMax™ zone actuator is used for on / off control of the heating zone of the manifold, via an electric signal transmitted by a room thermostat to the wiring centre.



### Features:

- Visual open / closed indicator
- Low power consumption
- Compact design
- Easy installation

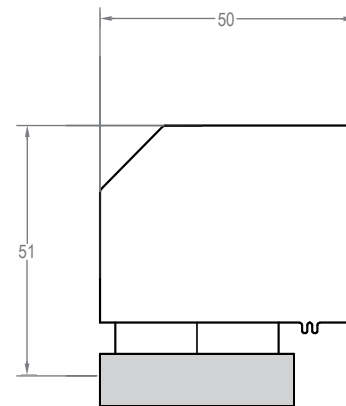
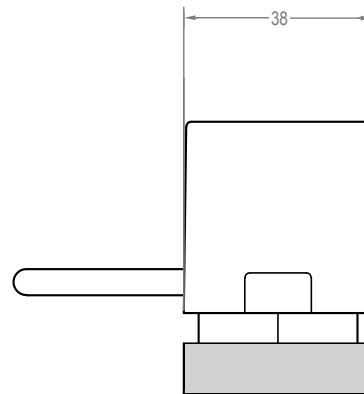

### Technical:

- Material: polyamide +30F.V. flame retardant
- Valve connection: threaded ring nut M30 x 1.5mm
- IP rating: IP44 in vertical position to EN-60529
- Actuator stroke: max 3.5mm

### Electrical data:

- Power supply: 230VAC 50/60Hz
- Power consumption: 2.5W
- Auxiliary micro-switch not energised: max 700mA (3A)
- Electrical cable: 2 x 0.75mm<sup>2</sup> x 1 m

### Temperature range:

- Operating temperature range: 0°C to 50°C
- Fluid temperature limit: 110°C

### Performance:

- Initial opening time or closing time 230V: 75 seconds
- Final opening time or closing time 230V: 180 seconds

### Other properties:

- Electrical protection: class II
- Compliant with LVD 2014/35/UE, EMC 2014/30/UE

## About us

No ifs, no buts. The award-winning Continental Underfloor® service means you get an underfloor heating system delivered to you on time, on site, every time, no compromise.

