

| No. | DATE         | DESCRIPTION          | REV |
|-----|--------------|----------------------|-----|
| △   | 2019. 07. 10 | Drawing revised 圖面修正 | A   |

REMARK : RoHS REQUIREMENT APPLIED  
(符合RoHS)

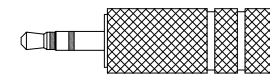
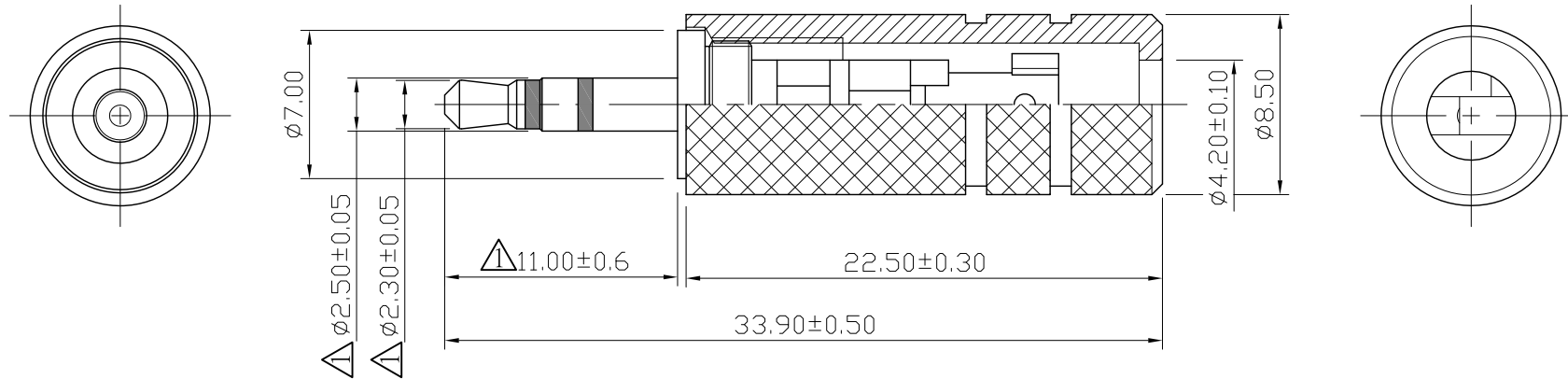

S 1 : 1

| -   | shell       | 1    | brass     | nickel |             |
|-----|-------------|------|-----------|--------|-------------|
| -   | clip        | 1    | brass     | nickel |             |
| -   | contact pin | 1    | brass     | nickel |             |
| -   | insulator   | 1    | plastic   | black  |             |
| -   | insulator   | 1    | plastic   | black  |             |
| -   | insulator   | 1    | plastic   | black  |             |
| -   | body        | 1    | brass     | nickel |             |
| -   | body        | 1    | brass     | nickel |             |
| -   | body        | 1    | brass     | nickel |             |
| -   | body        | 1    | brass     | nickel |             |
| NO. | Description | Unit | Materials | Finish | Drawing No. |

DIMENSIONS ARE IN MILLIMETERS  
UNLESS OTHERWISE SPECIFIED  
TOLERANCES  
(一般公差)  
0.5~6 =  $\pm 0.2$   
>6~30 =  $\pm 0.4$   
>30~120 =  $\pm 0.6$   
>120~315 =  $\pm 1$   
>315~1000 =  $\pm 1.6$   
ANGLES(角度) =  $\pm 5^\circ$

CHECKED

DRAWN

*Chad*

DATE

2013. 05. 03



雅鈦企業有限公司  
Aec Connectors Co., Ltd.

TITLE

AUDIO PLUG

DRAWING NO.

AP2.5Mini-253NN-Stereo-4.2

FILE NO. DRAWING\AUDIO\AP\AP2.5Mini-253NN-Stereo-4.2

SCALE 3 : 1 UNIT MM