

No.	DATE	DESCRIPTION	REV
▲	2015. 08. 26	Drawing revised (圖面修正)	A

REMARK : RoHS REQUIREMENT APPLIED  
(符合RoHS)

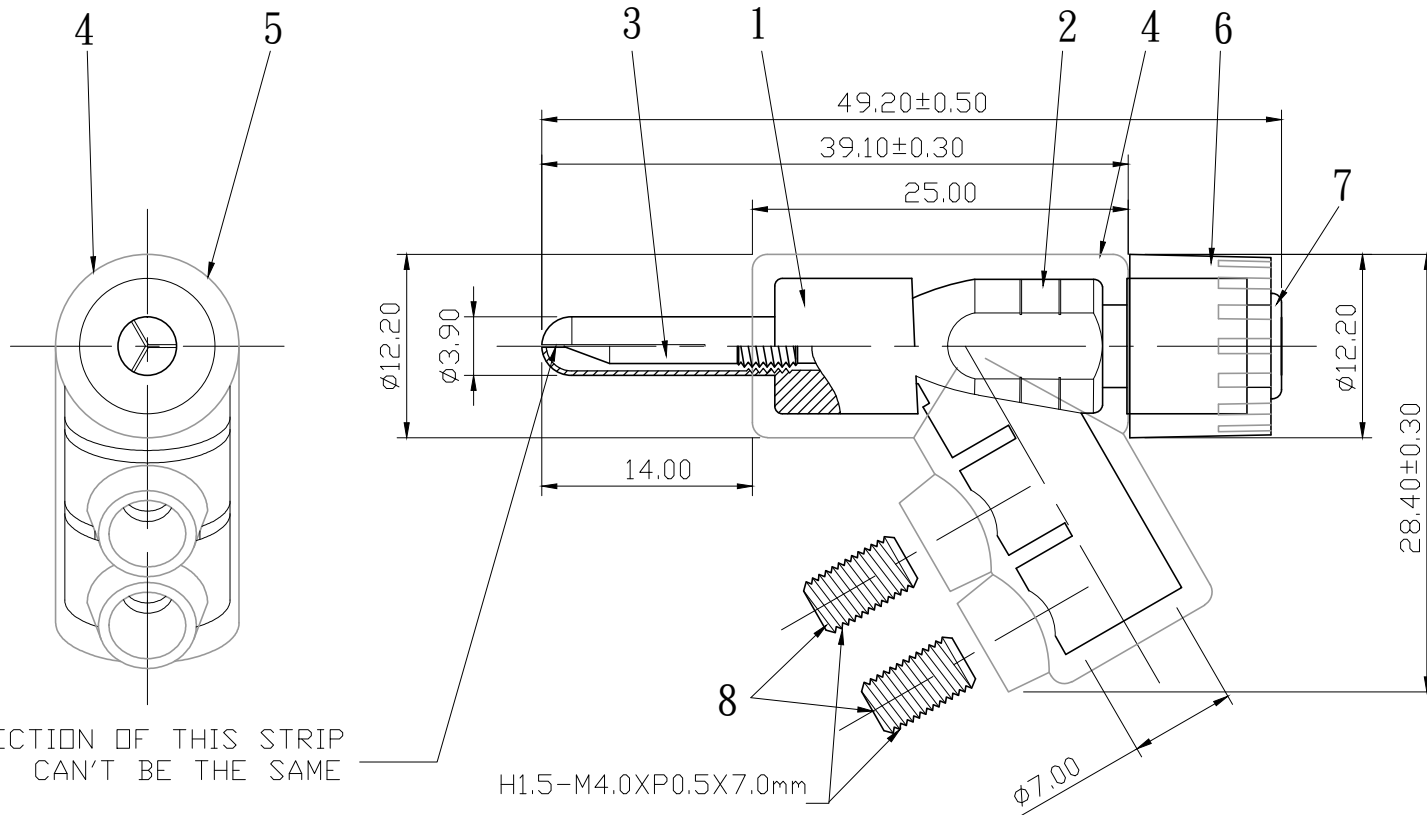

THE DIRECTION OF THIS STRIP  
CAN'T BE THE SAME

H1.5-M4.0XP0.5X7.0mm

S1:1

8	screw	2	brass	gold	ZZSW0006BR-G
7	cap	1	nylon	red/black/white	ZZCA0001NL-XX
6	shell	1	PC (polycarbonate)	transparent	BPSL0003PC
5	shell	1	PC (polycarbonate)	transparent	BPSL0002PC
4	shell	1	PC (polycarbonate)	transparent	BPSL0001PC
3	contact pin	1	brass	gold	
2	body	1	brass	gold	BPBY0006BR-G
1	body	1	brass	gold	BPBY0005BR-G
NO.	Description	Unit	Materials	Finish	Drawing No.

DIMENSIONS ARE IN MILLIMETERS		
UNLESS OTHERWISE PECIFIED TOLERANCES (一般公差)		
0.5-6	= ±0.2	
>6-30	= ±0.4	
>30-120	= ±0.6	
>120-315	= ±1	
>315-1000	= ±1.6	
ANGLES(角度) = ±5°		
SCALE	2 : 1	UNIT
		MM

CHECKED	
DRAWN	<i>Jim</i>
DATE	2008. 03. 17

 <b>雅鈦企業有限公司</b> Aec Connectors Co., Ltd.	
TITLE	BANANA PLUG
DRAWING NO.	BP-319GG-RD/BK/WE-7.0
FILE NO.	DRAWINGAUDIO\BP\BP-319GG-RD/BK/WE-7.0