

No.	DATE	DESCRIPTION	REV	REMARK : RoHS REQUIREMENT APPLIED (符合RoHS)	DATE	DRAWING NO.
					2009. 02. 02	1.6/5.6-113NG-TEF(75)

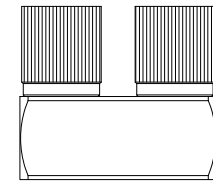
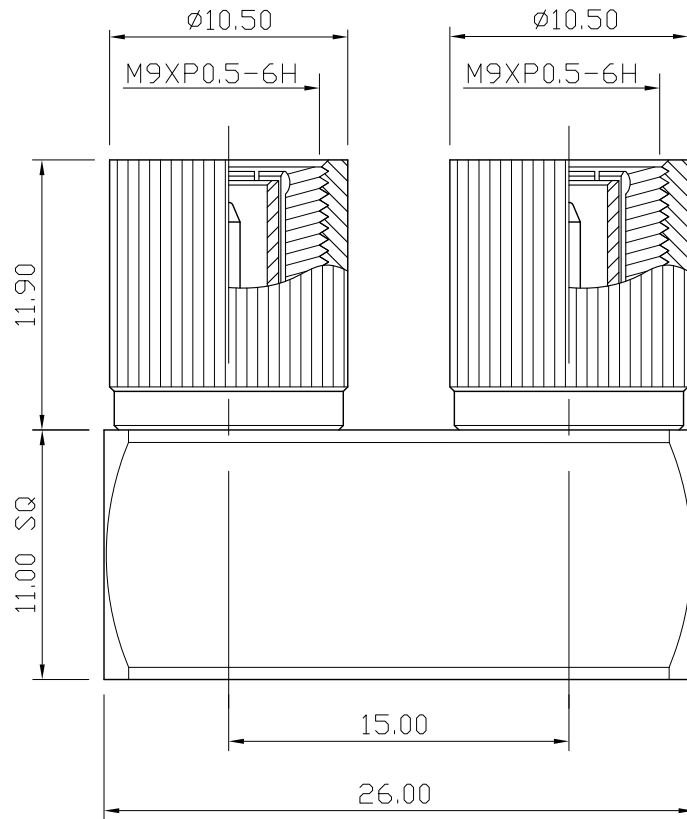

S 1 : 1

-	cover	2	brass	nickel	
-	shell	2	brass	nickel	
-	contact body	2	phosphor bronze	gold	
-	contact pin	2	brass	gold	
-	insulator	2	teflon	white	
-	body	1	brass	nickel	
-	contact pin	1	brass	gold	
-	insulator	1	PTFE	white	
-	cube body	1	brass	nickel	
NO.	Description	Unit	Materials	Finish	Drawing No.

DIMENSIONS ARE IN MILLIMETERS  
UNLESS OTHERWISE SPECIFIED  
TOLERANCES  
(一般公差)  
0.5~6 = ±0.2  
>6~30 = ±0.4  
>30~120 = ±0.6  
>120~315 = ±1  
>315~1000 = ±1.6  
ANGLES(角度) = ±5°

CHECKED  
  
DRAWN  
*Lala*  
DATE  
2008. 05. 05

 <b>雅鈦企業有限公司</b> Aec Connectors Co., Ltd.	TITLE	1.6/5.6 MALE U LINK ADAPTOR
	DRAWING NO.	ADT-2901U-1.617TA-1.617TA
	FILE NO.	DRAWINGARFADTVADT-2901U-1.617TA-1.617TA