

REMARK : RoHS REQUIREMENT APPLIED
(符合RoHS)

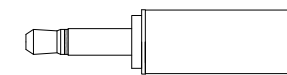
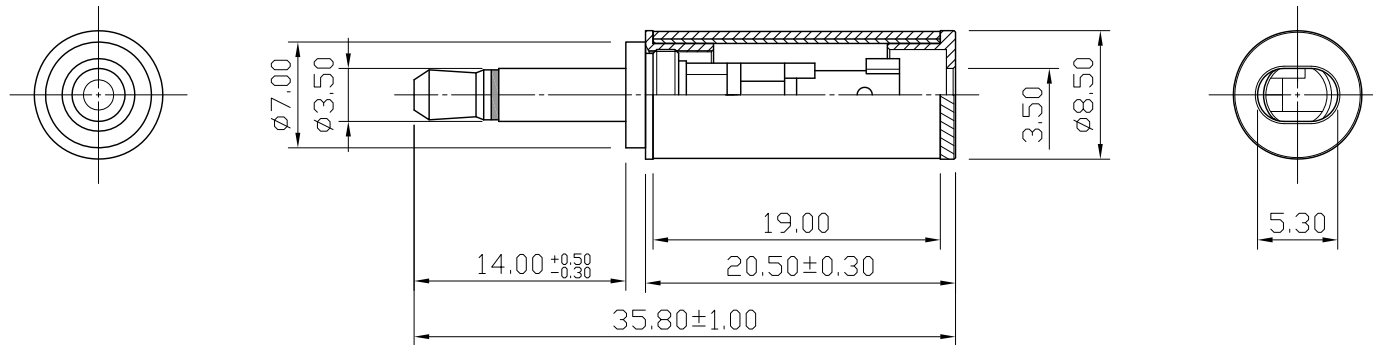

S 1 : 1

| | | | | | | |
|-----|-------------|------|--------------------|--------|-----------------------|-------------|
| - | sleeve | 1 | brass | nickel | | |
| - | shell | 1 | black carbon fiber | nature | | |
| - | tube | 1 | brass | nature | | |
| - | headlock | 1 | brass | nickel | | |
| - | contact pin | 1 | brass | nickel | BODY-AP3.5-4041N-Mono | |
| - | clip | 1 | brass | nickel | | |
| - | insulator | 1 | POM | black | | |
| - | insulator | 1 | POM | black | | |
| - | body | 1 | brass | nickel | | |
| - | body | 1 | brass | nickel | | |
| - | body | 1 | brass | nickel | | |
| NO. | Description | Unit | Materials | Finish | | Drawing No. |

DIMENSIONS ARE IN
MILLIMETERS
UNLESS OTHERWISE SPECIFIED
TOLERANCES
(一般公差)
0.5~6 = ± 0.2
>6~30 = ± 0.4
>30~120 = ± 0.6
>120~315 = ± 1
>315~1000 = ± 1.6
ANGLES(角度) = $\pm 5^\circ$

CHECKED

DRAWN

Tina

DATE

2012. 04. 26



雅鈦企業有限公司
Aec Connectors Co., Ltd.

TITLE

AUDIO PLUG

DRAWING NO.

AP3.5-4042BKFNN-Mono-E3.5

FILE NO. DRAWING\AUDIO\AP\AP3.5-4042BKFNN-Mono-E3.5

SCALE 2 : 1 UNIT MM